

## Quick Delivery Lab Furnishings Catalog



### Stainless Steel Casework

Working with the **INSTOCK**® Lab Team is Fast and Easy

### Using this catalog

Each catalog focuses on a segment of the over 600 commonly used lab furnishing products. This format will help you to locate the products that you need quickly and easily.

### Product Organization

Products have been clearly presented using pictures, specifications, descriptive information and performance data to assist with selection.

### Next Steps

If you wish to place an order please [CONTACTUS@LFSYSTEMS.com](mailto:CONTACTUS@LFSYSTEMS.com)  
or use the Excel Order Form (link) that follows the list of catalogs.  
(Note: The order form link requires an Excel Spreadsheet app.)

## Stainless Steel Casework

Stainless steel furnishings are designed specifically for research and healthcare laboratories. Stainless steel counter tops and wash areas are also available for labs requiring sanitation and sterilization. Standard construction is a Type-304 stainless with a #4 finish. Our stainless steel cabinets have the same construction detail as our painted steel cabinets. Type-316 stainless cabinet construction is also available. Contact your Furniture Specialist for more information. Lead time is 6-8 weeks.



## Design Appearance:

- Our cabinetry is offered in a flush inset style. All cabinet component parts are of the sectional units are manufactured ensuring uniformity, interchangeability, and accurate alignment.

## Color:

- Our stainless steel cabinet is Type #304 stainless steel with at #4 finish

## Field Convertible:

- Field convertible design allows for conversion of cabinet door and drawer front styles, drawer body suspension and cabinet horizontal and vertical rails, with the use of simple hand tools.

## LEED Compliance:

- Environmentally compliant paints, glues and adhesives are specifically formulated to safeguard indoor air quality

## Industry Compliance:

- SEFA 8 Metal, NFPA 30, UL listed

## Drawer Slide:

- 100 lbs. full extension, Standard

## Standard Features:

- Stainless Steel Wire Pull
- Stainless Steel Five Knuckle Hinge
- Nylon Roller Door Catch

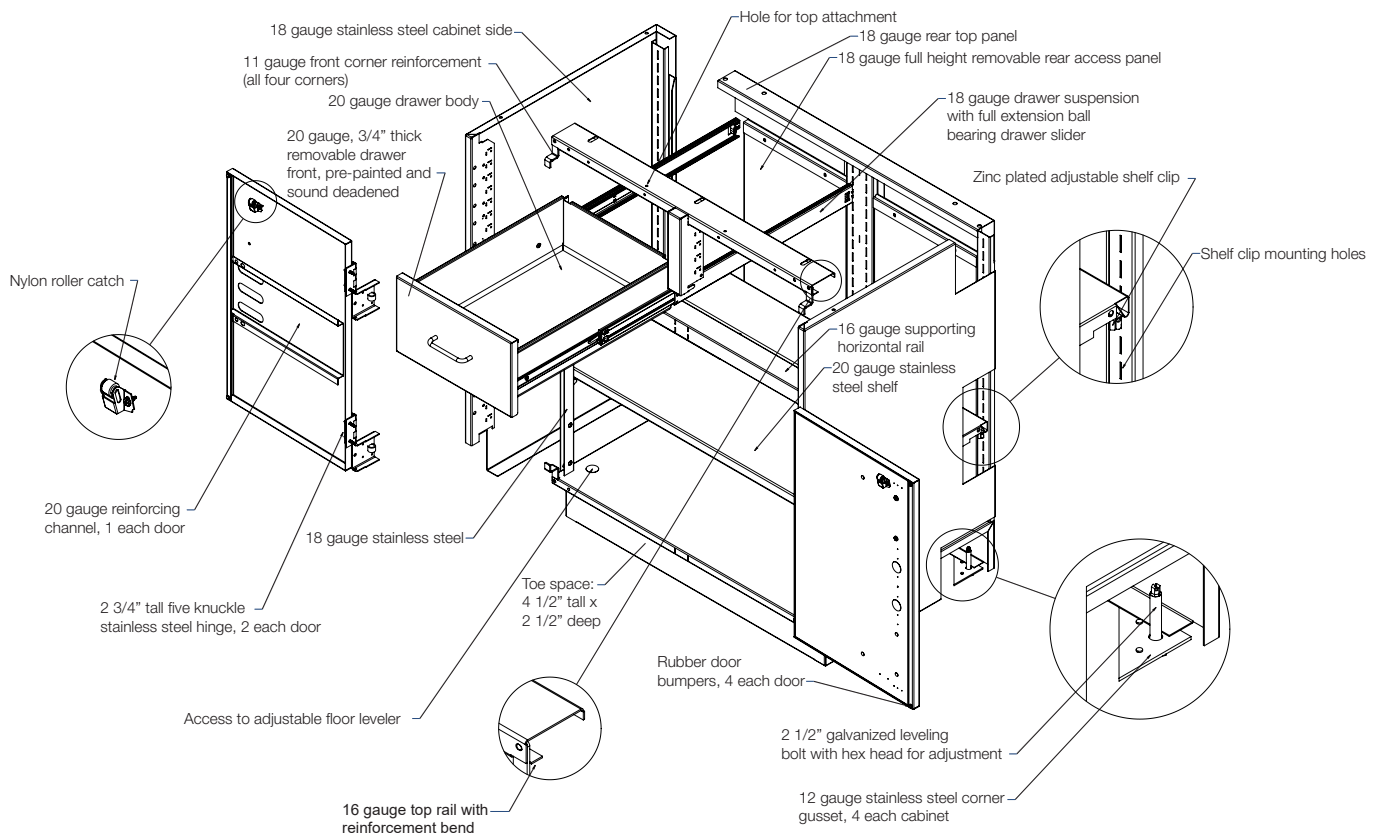





**Quick Delivery Program**

**Quick Delivery Lab Furnishings**



249 Old Churchmans Road  
New Castle, Delaware 19720

PHONE: 302-322-0460

EMAIL: [contactus@lfsystems.com](mailto:contactus@lfsystems.com)

WEB: [www.LFSYSTEMS.com](http://www.LFSYSTEMS.com)

