

F-100 ISOLATOR GEN-5 Bench Hood – Frameless Vertical Sash

ISOLATOR GENERATION-5 Bench Fume Hood is the result of extensive R & D, producing the industry's safest and most adaptable hoods. It provides superior energy savings via this functional design. Don't be fooled by its stylish appearance, it has an expansive interior view, superior containment capability, an exceptional design and industry leading construction. ISOLATOR GEN-5 hood's design and construction are further enhanced by:

- User safety is paramount
- Hood has higher sight lines through 17.25" H. clear observation glass panel; allowing for easy set-ups
- Constructed for years of maintenance-free service
- Industry leading design, yet still easy to use
- Numerous custom options possible
- Design allows field conversion between Constant Air Volume(CAV) and Variable Air Volume (VAV)
- Flush-face design
- Substantial energy savings via the sash configurations
- Hood is available in knock down (KD) mode for transport and assembly in confined or restricted areas

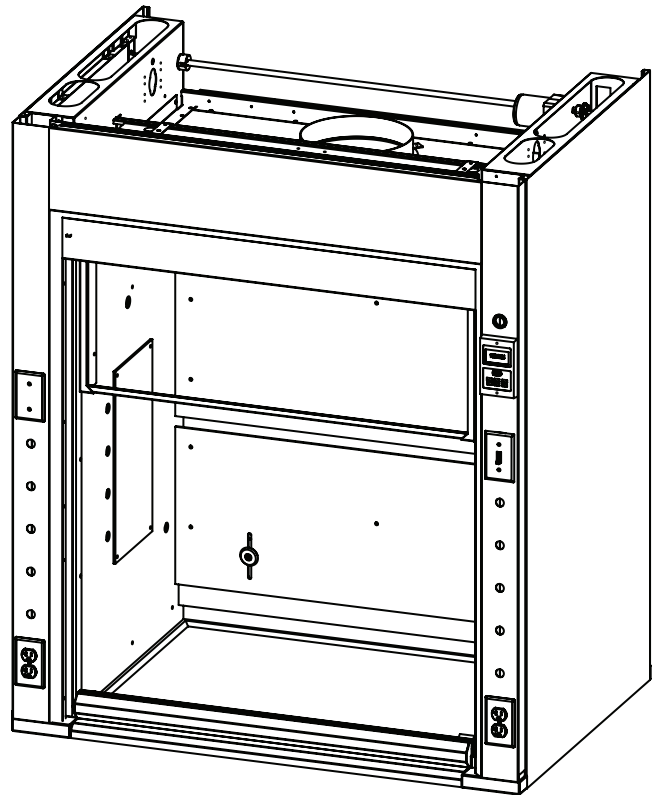

F-100 ISOLATOR GEN-5 BENCH FUME HOOD - PRODUCT FEATURES

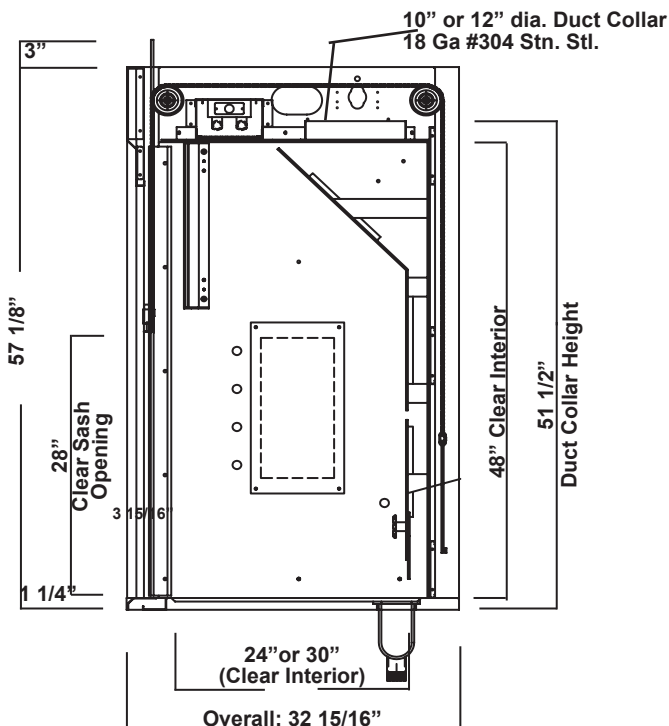

Note:
Counter Top Material:
29"D or 35"D

F-100 ISOLATOR GEN-5 Bench Hood Features

- Unsurpassed containment (designed and tested to exceed ASHRAE 110-1995)
- Hood is UL1805/CUL Certified listed
- Unique chain driven sash mechanism with a lifetime warranty
- Galvanized steel pan superstructure
- 17.25" H. Clear observation glass panel, bypass system
- Integral flush sill containment trough
- Non-metallic interior equipped with adjustable baffles
- Ergonomic, painted sash handle and integral, painted, flush sill containment
- Vertical sashes provide the greatest hood interior access
- Full view frameless sash with 28" H. opening
- Quality engineering ensures years of reliable service



F-100 ISOLATOR GEN-5 Bench Fume Hood – Ordering Information

F-100 ISOLATOR GEN-5 Series Air Flow Data

Catalog Number	Duct Diameter	28" Vertical Open @ 100 FPM	18" Vertical Open @ 100 FPM
F-100-36G5	1 : 10"	505 CFM @ .15" SP	325 CFM @ .06" SP
F-100-48G5	1 : 10"	739 CFM @ .32" SP	475 CFM @ .13" SP
F-100-60G5	1 : 12"	972 CFM @ .27" SP	625 CFM @ .11" SP
F-100-72G5	1 : 12"	1205 CFM @ .41" SP	775 CFM @ .17" SP
F-100-96G5	2 : 10"	1672 CFM @ .41" SP	1075 CFM @ .17" SP

F-100 ISOLATOR GEN-5 Series Product Numbers

F-100-36G5	Bench 36"	Frameless	24" Deep, Clear Interior
F-100-36G5D30	Bench 36"	Frameless	30" Deep, Clear Interior
F-100-48G5	Bench 48"	Frameless	24" Deep, Clear Interior
F-100-48G5D30	Bench 48"	Frameless	30" Deep, Clear Interior
F-100-60G5	Bench 60"	Frameless	24" Deep, Clear Interior
F-100-60G5D30	Bench 60"	Frameless	30" Deep, Clear Interior
F-100-72G5	Bench 72"	Frameless	24" Deep, Clear Interior
F-100-72G5D30	Bench 72"	Frameless	30" Deep, Clear Interior
F-100-96G5	Bench 96"	Frameless	24" Deep, Clear Interior
F-100-96G5D30	Bench 96"	Frameless	30" Deep, Clear Interior

F-100 GEN-5 Series Liner Options

White Polyglass is standard. Please see the Hood Liners section for available options.

F-100 GEN-5 Series Electrical Options

Fascia is pre-punched with two electrical cutouts (four cutouts total). Please see the Electrical Fixtures section for available options.

F-100 GEN-5 Series Plumbing Fixtures

Fascia is pre-punched with five 3/4" dia. holes to accept rod driven remote fixtures (ten holes total). Please see the Plumbing Fixtures section for available options.

F-100 GEN-5 Series Fume Hood Accessories

Please see the Fume Hood Accessories section for available options.

F-100 ISOLATOR GEN-5 Bench Fume Hood – Product Dimensions

Each 5" wide fascia pre-punched with two electrical cutouts and five, 3/4" diameter holes for rod driven remote fixtures.
(Total: 4 electrical cutouts; 10, pre-punched holes, per hood) 10 hole plugs provided.

Counter Top Depth: 29" or 35" D. The 6" x 3" cup sinks shown are optional.

Outside, Overall Height: 57-1/8"

Outside, Overall Depth: 32-15/16"

Equipped with 10" or 12" diameter, stainless steel duct collar.

24" or 30" Clear Interior Depth - Specify by Unit # Selection.

48" Clear Interior Height. Height from bottom of hood to top of duct collar is 51-1/2".

F-100-36G5 - 36" BENCH FUME HOOD

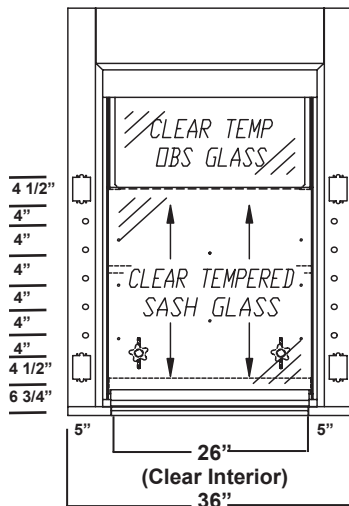

Note:
Counter Top Material:
29"D or 35"D

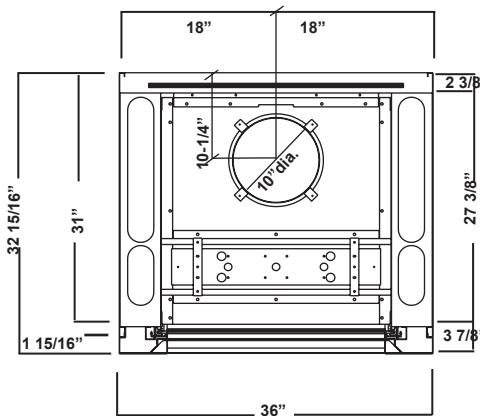

F-100-48G5 - 48" BENCH FUME HOOD

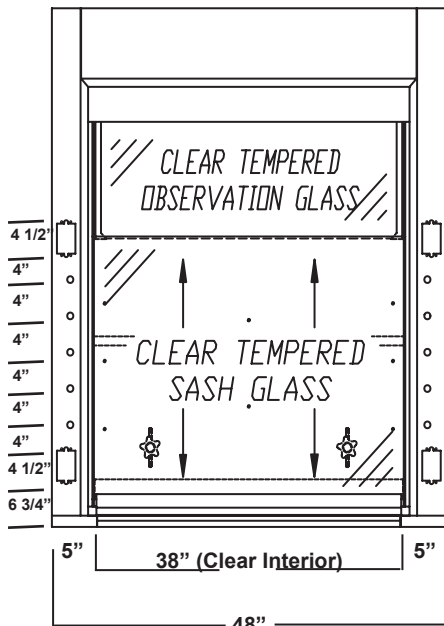

Note:
Counter Top Material:
29"D or 35"D

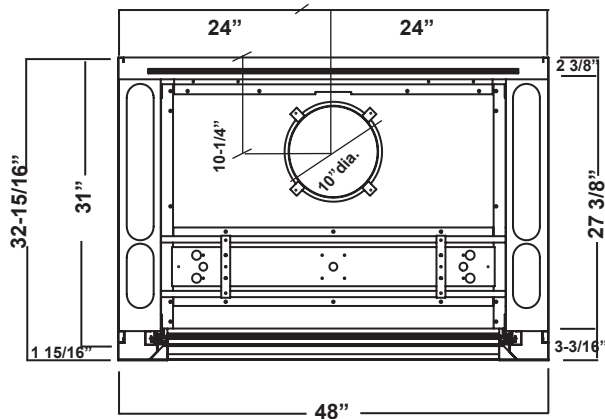

F-100 ISOLATOR GEN-5 Bench Fume Hood – Product Dimensions

Each 5" wide fascia pre-punched with two electrical cutouts and five, 3/4" diameter holes for rod driven remote fixtures.

(Total: 4 electrical cutouts; 10, pre-punched holes, per hood) 10 hole plugs provided.

Counter Top Depth: 29" or 35" D. The 6" x 3" cup sinks shown are optional.

Outside, Overall Height: 57-1/8"

Outside, Overall Depth: 32-15/16"

Equipped with 10" or 12" diameter, stainless steel duct collar.

24" or 30" Clear Interior Depth - Specify by Unit # Selection.

48" Clear Interior Height. Height from bottom of hood to top of duct collar is 51-1/2".

F-100-60G5 - 60" BENCH FUME HOOD

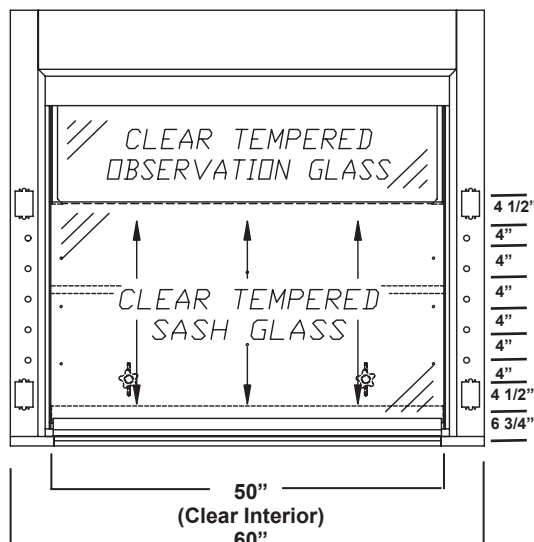
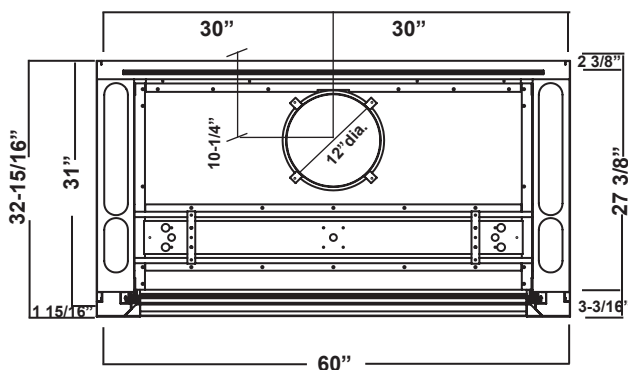

Note:
Counter Top Material:
29"D or 35"D

F-100-72G5 - 72" BENCH FUME HOOD

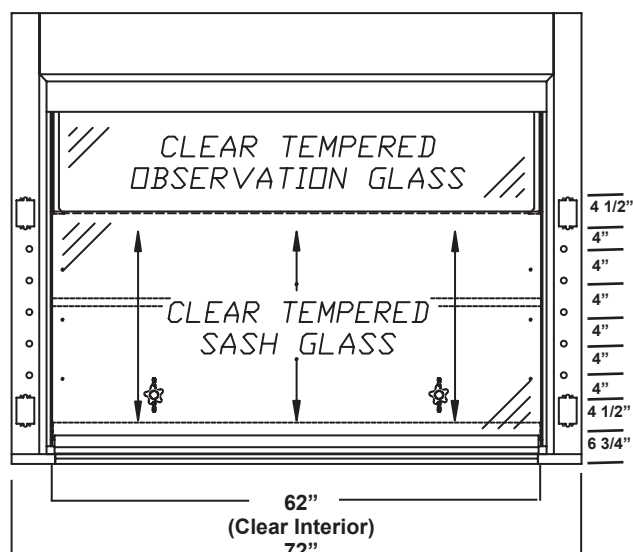
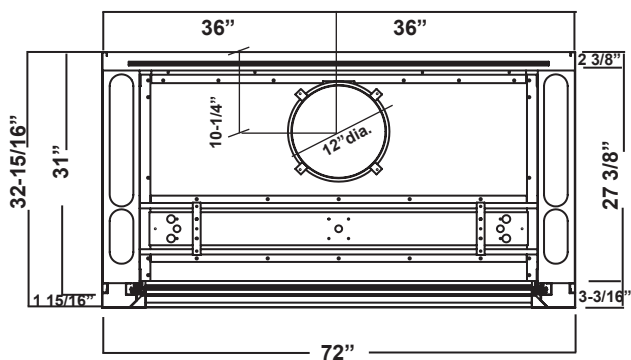

Note:
Counter Top Material:
29"D or 35"D

F-100 ISOLATOR GEN-5 Bench Fume Hood – Product Dimensions

Each 5" wide fascia pre-punched with two electrical cutouts and five, 3/4" diameter holes for rod driven remote fixtures.
(Total: 4 electrical cutouts; 10, pre-punched holes, per hood) 10 hole plugs provided.

Counter Top Depth: 29" or 35" D. The 6" x 3" cup sinks shown are optional.

Outside, Overall Height: 57-1/8"

Outside, Overall Depth: 32-15/16"

Equipped with 10" or 12" diameter, stainless steel duct collar.

24" or 30" Clear Interior Depth - Specify by Unit # Selection.

48" Clear Interior Height. Height from bottom of hood to top of duct collar is 51-1/2".

F-100-96G5 - 96" BENCH FUME HOOD

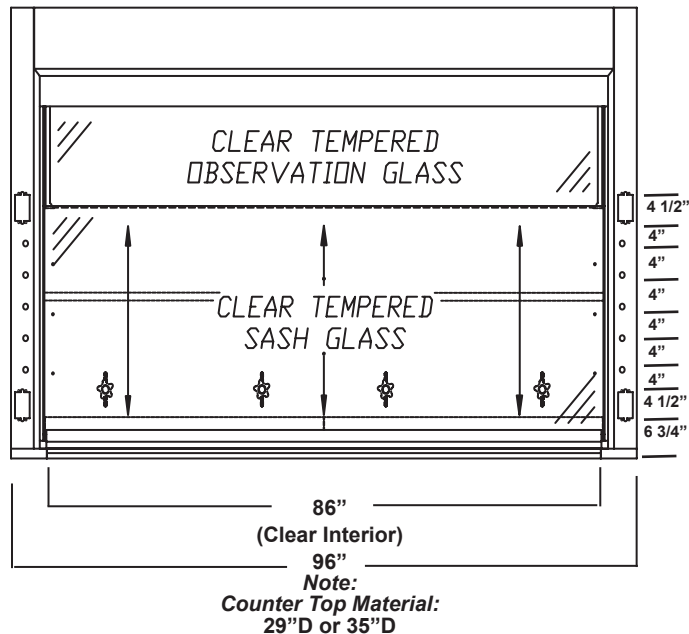
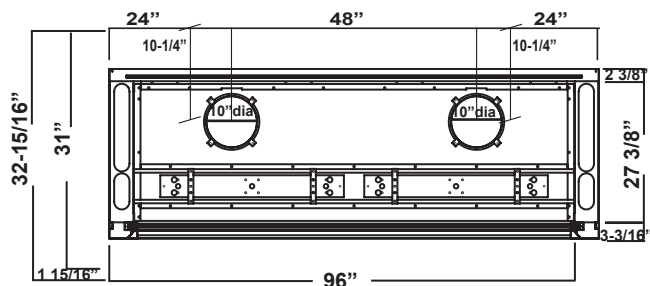

F-100-G5 - BENCH FUME HOOD SIDE VIEWS, OPEN & CLOSED

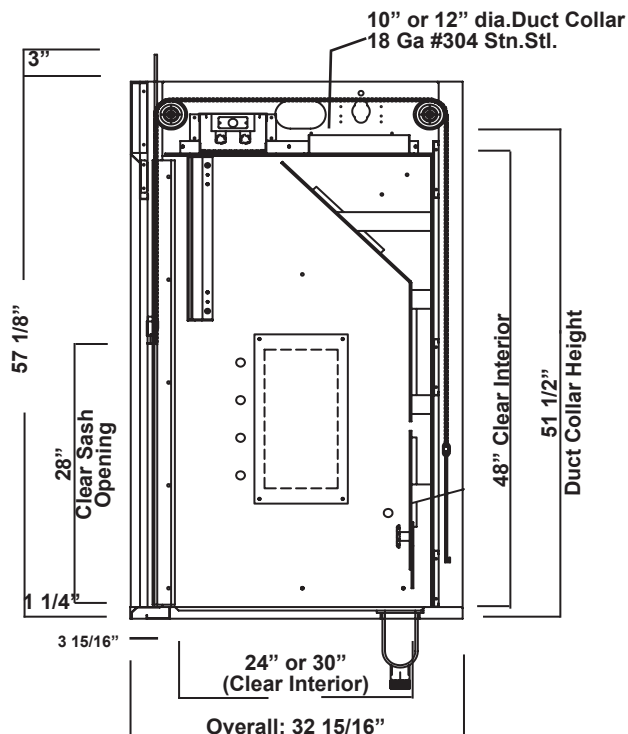

Note:
Counter Top Material:
29"D or 35"D

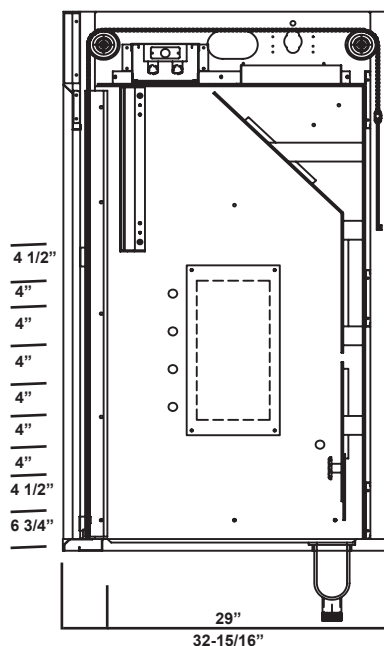

INTENTIONALLY BLANK



F-101 ISOLATOR GEN-5 Bench Hood – Combination Sash

ISOLATOR GENERATION-5 Bench Fume Hood is the result of extensive R & D, producing the industry's safest and most adaptable hoods. It provides superior energy savings via this functional design. Don't be fooled by its stylish appearance, it has an expansive interior view, superior containment capability, an exceptional design and industry leading construction. ISOLATOR GEN-5 hood's design and construction are further enhanced by:

- User safety is paramount
- Hood has higher sight lines through clear 17.25" H. observation glass panel; allowing for easy set-ups
- Constructed for years of maintenance-free service
- Industry leading design, yet still easy to use
- Numerous custom options possible
- Design allows field conversion between Constant Air Volume(CAV) and Variable Air Volume (VAV)
- Flush-face design
- Substantial energy savings via the sash configurations
- Hood is available in knock down (KD) mode for transport and assembly in confined or restricted areas

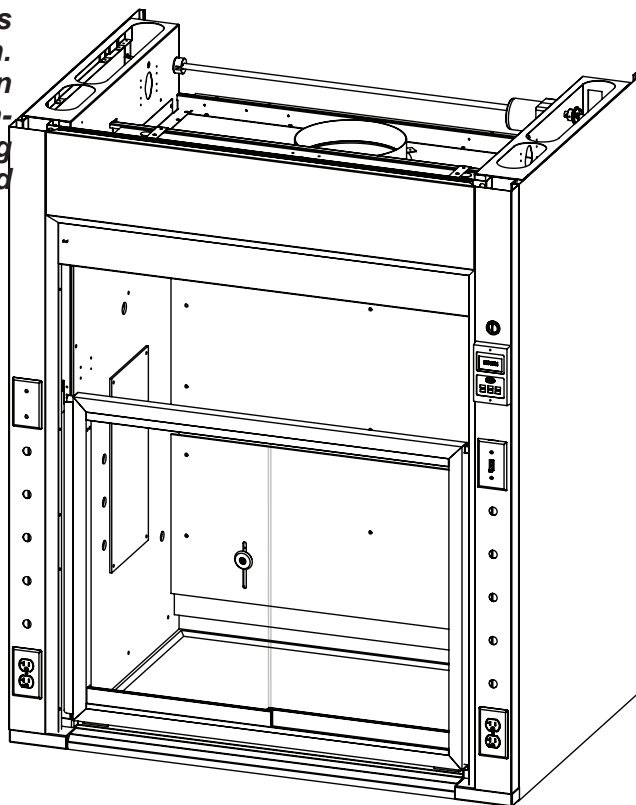

F-101 ISOLATOR GEN-5 BENCH FUME HOOD - PRODUCT FEATURES

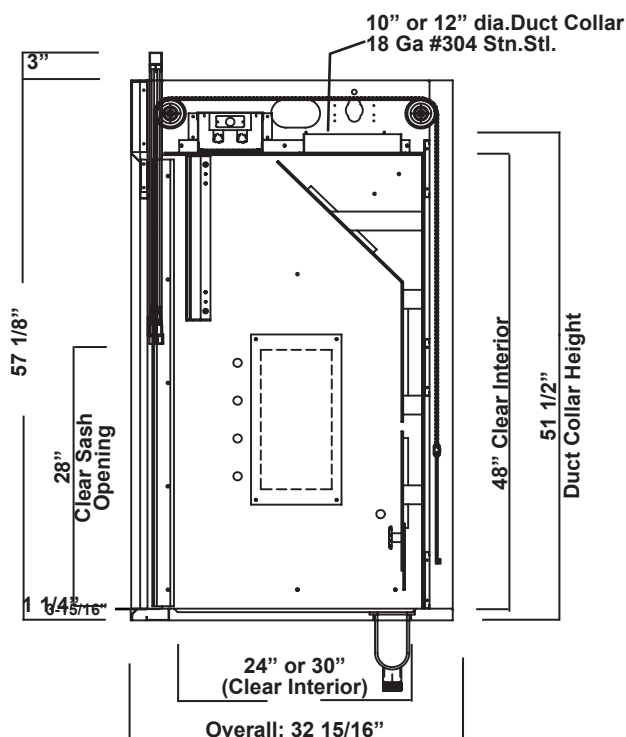

Note:
Counter Top Material:
29"D or 35"D

F-100 ISOLATOR GEN-5 Bench Hood Features

- Unsurpassed containment (designed and tested to exceed ASHRAE 110-1995)
- Hood is UL1805/CUL Certified listed
- Unique chain driven sash mechanism with a lifetime warranty
- Galvanized steel pan superstructure
- 17.25" H. Clear observation glass panel, bypass system
- Integral flush sill containment trough
- Non-metallic interior equipped with adjustable baffles
- Ergonomic, painted sash handle and integral, painted, flush sill containment
- Vertical sashes provide the greatest hood interior access
- Full view combination sash with 28" H. opening
- Quality engineering ensures years of reliable service



F-101 ISOLATOR GEN-5 Bench Fume Hood – Ordering Information

F-101 ISOLATOR GEN-5 Bench Air Flow Data

Catalog Number	Duct Diameter	28" Vertical Open @ 100 FPM	18" Vertical Open @ 100 FPM
F-101-48G5	1 : 10"	739 CFM @ .32" SP	410 CFM @ .10" SP
F-101-60G5	1 : 12"	972 CFM @ .27" SP	559 CFM @ .09" SP
F-101-72G5	1 : 12"	1205 CFM @ .41" SP	704 CFM @ .14" SP
F-101-96G5	2 : 10"	1672 CFM @ .41" SP	986 CFM @ .14" SP

F-101 ISOLATOR GEN-5 Bench Product Numbers

F-101-48G5	Bench 48"	Combo Sash	24" Deep, Clear Interior
F-101-48G5D30	Bench 48"	Combo Sash	30" Deep, Clear Interior
F-101-60G5	Bench 60"	Combo Sash	24" Deep, Clear Interior
F-101-60G5D30	Bench 60"	Combo Sash	30" Deep, Clear Interior
F-101-72G5	Bench 72"	Combo Sash	24" Deep, Clear Interior
F-101-72G5D30	Bench 72"	Combo Sash	30" Deep, Clear Interior
F-101-96G5	Bench 96"	Combo Sash	24" Deep, Clear Interior
F-101-96G5D30	Bench 96"	Combo Sash	30" Deep, Clear Interior

F-101 GEN-5 Bench Liner Options

White Polyglass is standard. Please see the Hood Liners section for available options.

F-101 GEN-5 Bench Electrical Options

Fascia is pre-punched with two electrical cutouts (four cutouts total). Please see the Electrical Fixtures section for available options.

F-101 GEN-5 Bench Plumbing Fixtures

Fascia is pre-punched with five 3/4" dia. holes to accept rod driven remote fixtures (ten holes total). Please see the Plumbing Fixtures section for available options.

F-101 GEN-5 Bench Fume Hood Accessories

Please see the Fume Hood Accessories section for available options.

F-101 ISOLATOR GEN-5 Bench Fume Hood – Product Dimensions

Each 5" wide fascia pre-punched with two electrical cutouts and five, 3/4" diameter holes for rod driven remote fixtures.
(Total: 4 electrical cutouts; 10, pre-punched holes, per hood) 10 hole plugs provided.

Counter Top Depth: 29" or 35" D. The 6" x 3" cup sinks shown are optional.

Outside, Overall Height: 57-1/8"

Outside, Overall Depth: 32-15/16"

Equipped with 10" or 12" diameter, stainless steel duct collar.

24" or 30" Clear Interior Depth - Specify by Unit # Selection.

48" Clear Interior Height. Height from bottom of hood to top of duct collar is 51-1/2".

F-101-48G5 - 48" BENCH FUME HOOD

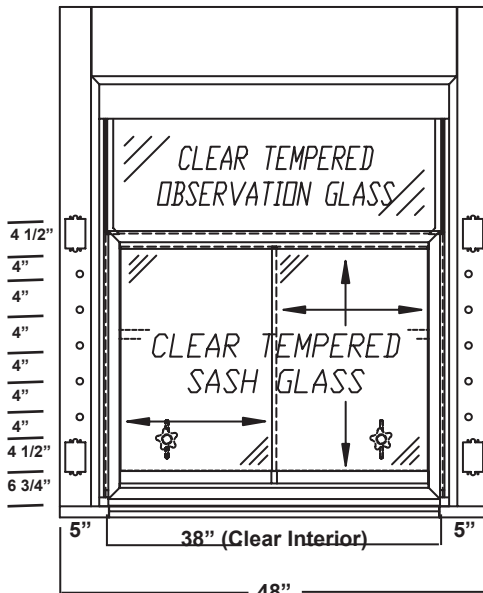

Note:
Counter Top Material:
29"D or 35"D

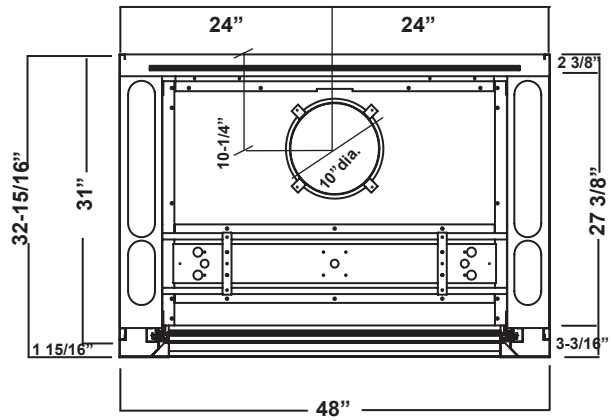

F-100-60G5 - 60" BENCH FUME HOOD

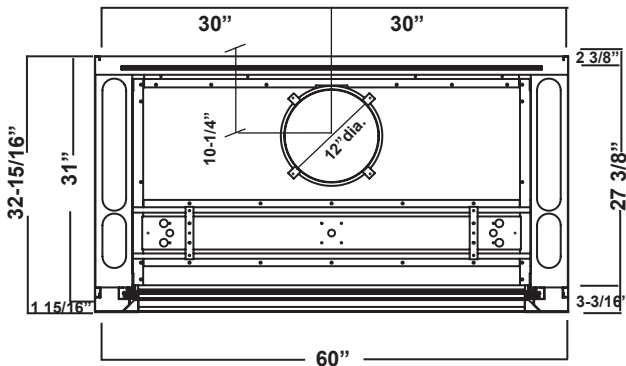

Note:
Counter Top Material:
29"D or 35"D

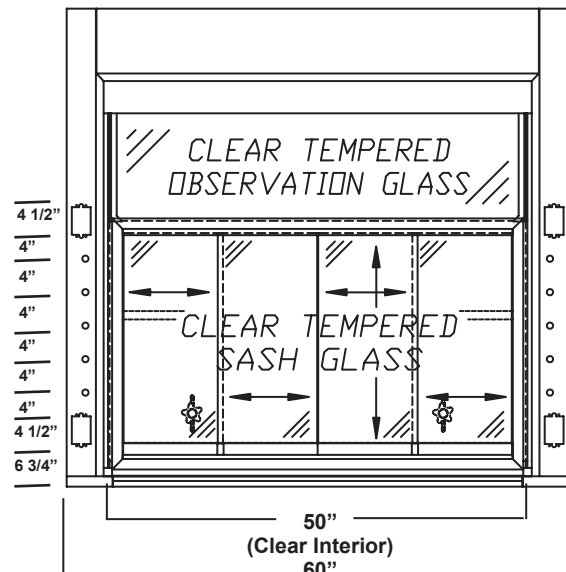

F-101 ISOLATOR GEN-5 Bench Fume Hood – Product Dimensions

Each 5" wide fascia pre-punched with two electrical cutouts and five, 3/4" diameter holes for rod driven remote fixtures.
(Total: 4 electrical cutouts; 10, pre-punched holes, per hood) 10 hole plugs provided.

Counter Top Depth: 29" or 35" D. The 6" x 3" cup sinks shown are optional.

Outside, Overall Height: 57-1/8"

Outside, Overall Depth: 32-15/16"

Equipped with 10" or 12" diameter, stainless steel duct collar.

24" or 30" Clear Interior Depth - Specify by Unit # Selection.

48" Clear Interior Height. Height from bottom of hood to top of duct collar is 51-1/2".

F-101-72G5 - 72" BENCH FUME HOOD

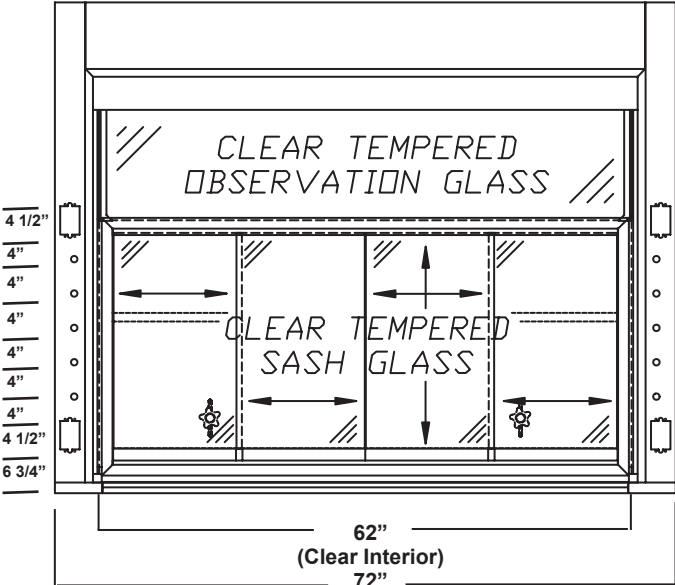
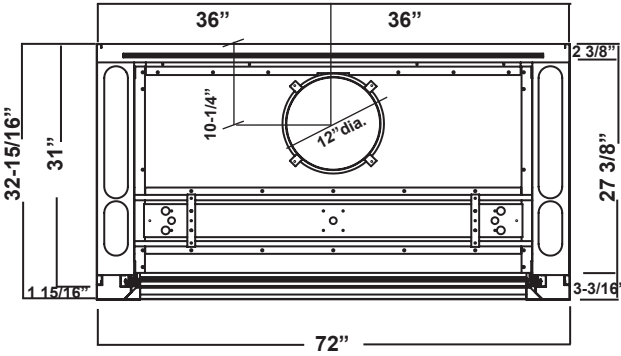

Note:
Counter Top Material:
29"D or 35"D

F-101-96G5 - 96" BENCH FUME HOOD

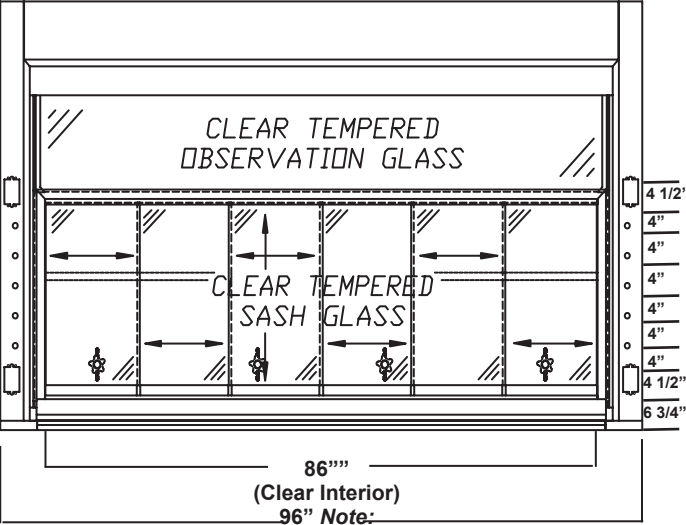

Note:
Counter Top Material:
29"D or 35"D

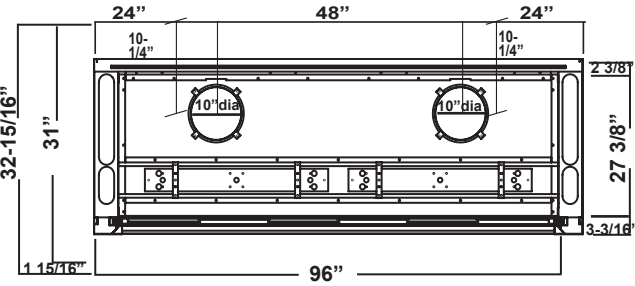

F-101 ISOLATOR GEN-5 Bench Fume Hood – Product Dimensions

F-101-G5 - BENCH FUME HOOD SIDE VIEWS, OPEN & CLOSED

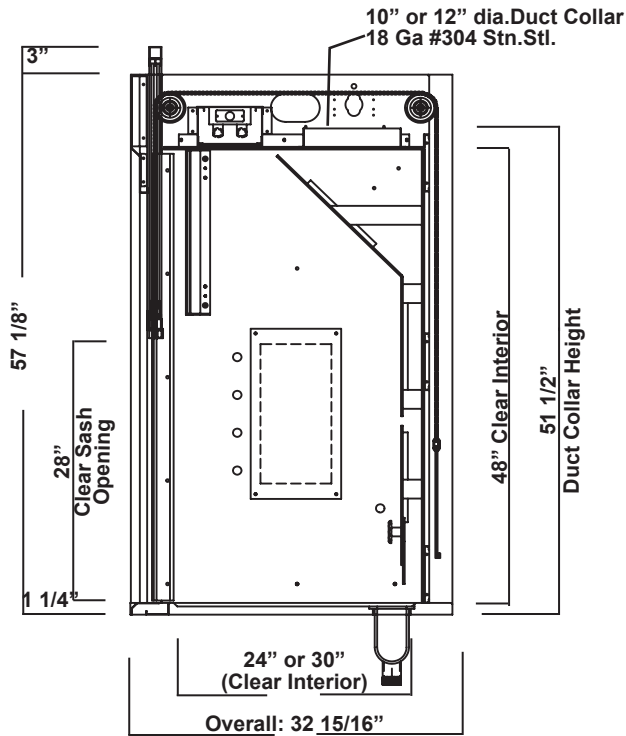

Note:
Counter Top Material:
29"D or 35"D

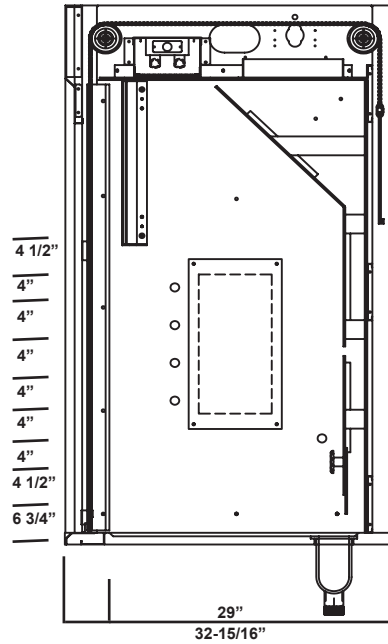

F-101 ISOLATOR GEN-5 BENCH FUME HOOD - PRODUCT DIMENSIONS



INTENTIONALLY BLANK



F-103 ISOLATOR GEN-5 Bench Hood – Framed Vertical Sash

ISOLATOR GENERATION-5 Bench Fume Hood is the result of extensive R & D, producing the industry's safest and most adaptable hoods. It provides superior energy savings via this functional design. Don't be fooled by its stylish appearance, it has an expansive interior view, superior containment capability, an exceptional design and industry leading construction. ISOLATOR GEN-5 hood's design and construction are further enhanced by:

- User safety is paramount
- Hood has higher sight lines through clear 17.25"H. observation glass panel; allowing for easy set-ups
- Constructed for years of maintenance-free service
- Industry leading design, yet still easy to use
- Numerous custom options possible
- Design allows field conversion between Constant Air Volume(CAV) and Variable Air Volume (VAV)
- Flush-face design
- Substantial energy savings via the sash configurations
- Hood is available in knock down (KD) mode for transport and assembly in confined or restricted areas

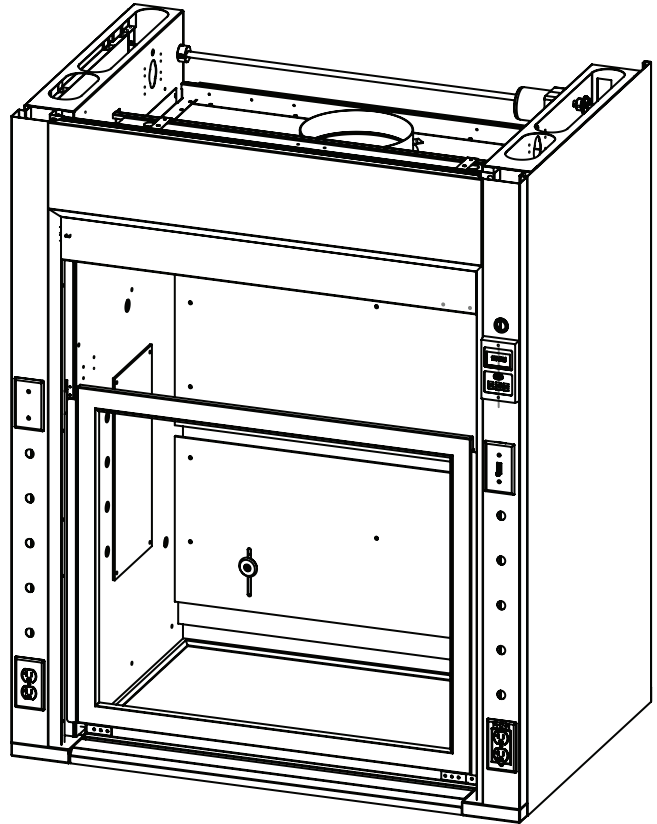

F-103 ISOLATOR GEN-5 BENCH FUME HOOD - PRODUCT FEATURES

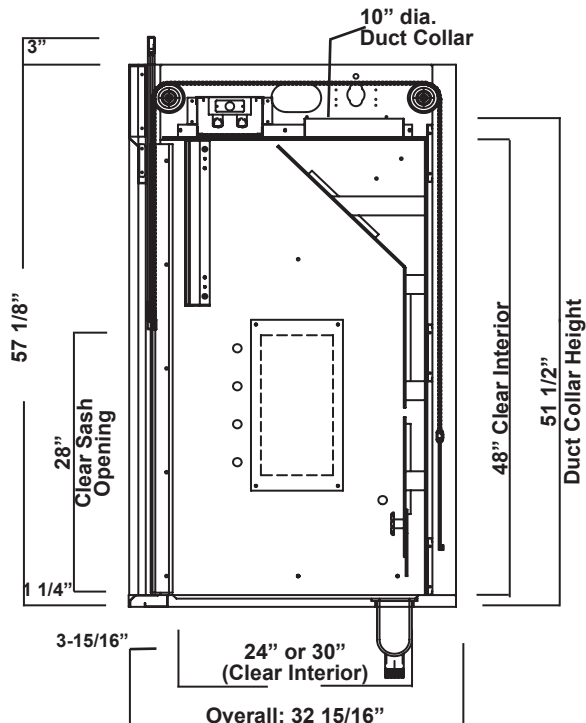

Note:
Counter Top Material:
29"D or 35"D

F-100 ISOLATOR GEN-5 Bench Hood Features

- Unsurpassed containment (designed and tested to exceed ASHRAE 110-1995)
- Hood is UL1805/CUL Certified listed
- Unique chain driven sash mechanism with a lifetime warranty
- Galvanized steel pan superstructure
- 17.25" H. Clear observation glass panel, bypass system
- Integral flush sill containment trough
- Non-metallic interior equipped with adjustable baffles
- Ergonomic, painted sash handle and integral, painted, flush sill containment
- Vertical sashes provide the greatest hood interior access
- Full view framed sash with 28" H. opening
- Quality engineering ensures years of reliable service



F-103 ISOLATOR GEN-5 Bench Fume Hood – Ordering Information

F-103 GEN-5 Bench Hood Air Flow Data

Catalog Number	Duct Diameter	28" Vertical Open @ 100 FPM	18" Vertical Open @ 100 FPM
F-103-36G5	1 : 10"	505 CFM @ .15" SP	325 CFM @ .06" SP
F-103-48G5	1 : 10"	739 CFM @ .32" SP	475 CFM @ .13" SP
F-103-60G5	1 : 12"	972 CFM @ .27" SP	625 CFM @ .11" SP
F-103-72G5	1 : 12"	1205 CFM @ .41" SP	775 CFM @ .17" SP
F-103-96G5	2 : 10"	1672 CFM @ .41" SP	1075 CFM @ .17" SP

F-103 GEN-5 Bench Hood Product Numbers

F-103-36G5	Bench 36"	Framed Sash	24" Deep, Clear Interior
F-103-36G5D30	Bench 36"	Framed Sash	30" Deep, Clear Interior
F-103-48G5	Bench 48"	Framed Sash	24" Deep, Clear Interior
F-103-48G5D30	Bench 48"	Framed Sash	30" Deep, Clear Interior
F-103-60G5	Bench 60"	Framed Sash	24" Deep, Clear Interior
F-103-60G5D30	Bench 60"	Framed Sash	30" Deep, Clear Interior
F-103-72G5	Bench 72"	Framed Sash	24" Deep, Clear Interior
F-103-72G5D30	Bench 72"	Framed Sash	30" Deep, Clear Interior
F-103-96G5	Bench 96"	Framed Sash	24" Deep, Clear Interior
F-103-96G5D30	Bench 96"	Framed Sash	30" Deep, Clear Interior

F-103 GEN-5 Bench Hood Liner Options

White Polyglass is standard. Please see the Hood Liners section for available options.

F-103 GEN-5 Bench Hood Electrical Options

Fascia is pre-punched with two electrical cutouts (four cutouts total). Please see the Electrical Fixtures section for available options.

F-103 GEN-5 Bench Hood Plumbing Fixtures

Fascia is pre-punched with five 3/4" dia. holes to accept rod driven remote fixtures (ten holes total). Please see the Plumbing Fixtures section for available options.

F-103 GEN-5 Bench Hood Fume Hood Accessories

Please see the Fume Hood Accessories section for available options.

F-103 ISOLATOR GEN-5 Bench Hood – Product Dimensions

Each 5" wide fascia pre-punched with two electrical cutouts and five, 3/4" diameter holes for rod driven remote fixtures.
(Total: 4 electrical cutouts; 10, pre-punched holes, per hood) 10 hole plugs provided.

Counter Top Depth: 29" or 35" D. The 6" x 3" cup sinks shown are optional.

Outside, Overall Height: 57-1/8"

Outside, Overall Depth: 32-15/16"

Equipped with 10" or 12" diameter, stainless steel duct collar.

24" or 30" Clear Interior Depth - Specify by Unit # Selection.

48" Clear Interior Height. Height from bottom of hood to top of duct collar is 51-1/2".

F-103-36G5 - 36" BENCH FUME HOOD

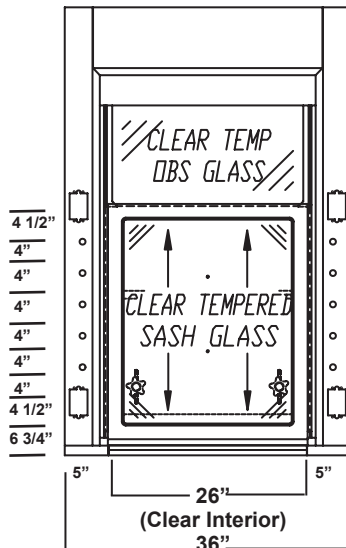

Note:
Counter Top Material:
29"D or 35"D

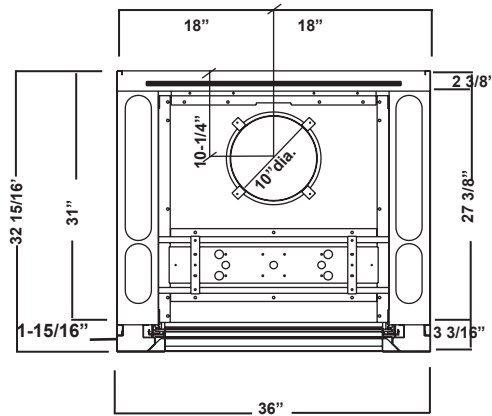

F-103-48G5 - 48" BENCH FUME HOOD

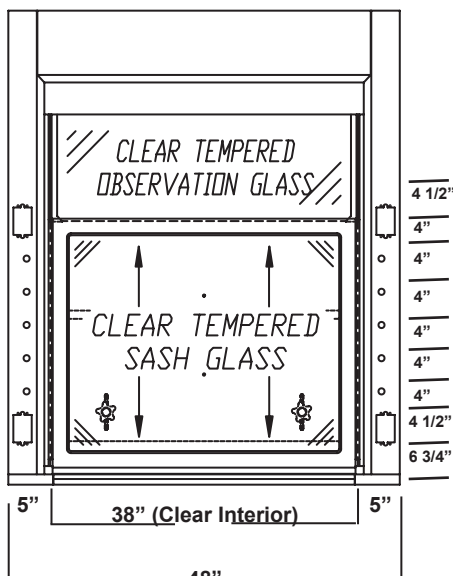

Note:
Counter Top Material:
29"D or 35"D

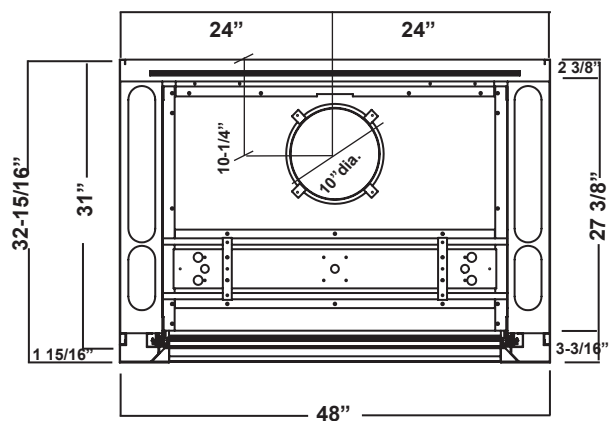

F-103 ISOLATOR GEN-5 Bench Hood – Product Dimensions

Each 5" wide fascia pre-punched with two electrical cutouts and five, 3/4" diameter holes for rod driven remote fixtures.
 (Total: 4 electrical cutouts; 10, pre-punched holes, per hood) 10 hole plugs provided.
 Counter Top Depth: 29" or 35" D. The 6" x 3" cup sinks shown are optional.
 Outside, Overall Height: 57-1/8"
 Outside, Overall Depth: 32-15/16"
 Equipped with 10" or 12" diameter, stainless steel duct collar.

24" or 30" Clear Interior Depth - Specify by Unit # Selection.
 48" Clear Interior Height. Height from bottom of hood to top of duct collar is 51-1/2".

F-103-60G5 - 60" BENCH FUME HOOD

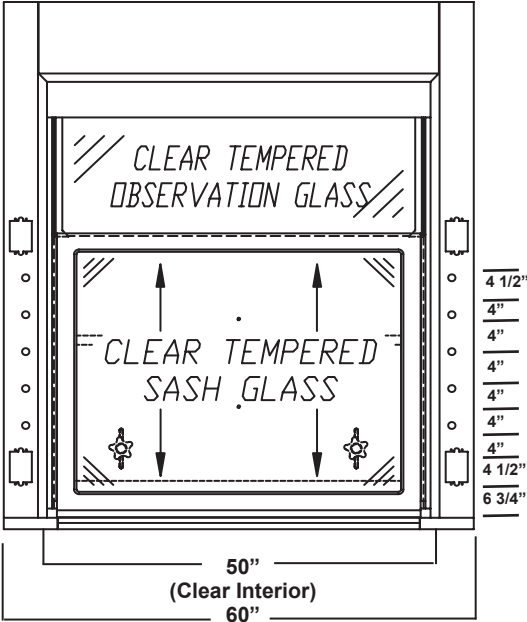
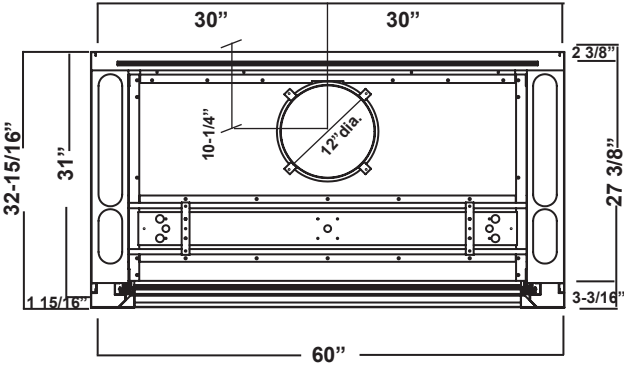

Note:
 Counter Top Material:
 29"D or 35"D

F-103-72G5 - 72" BENCH FUME HOOD

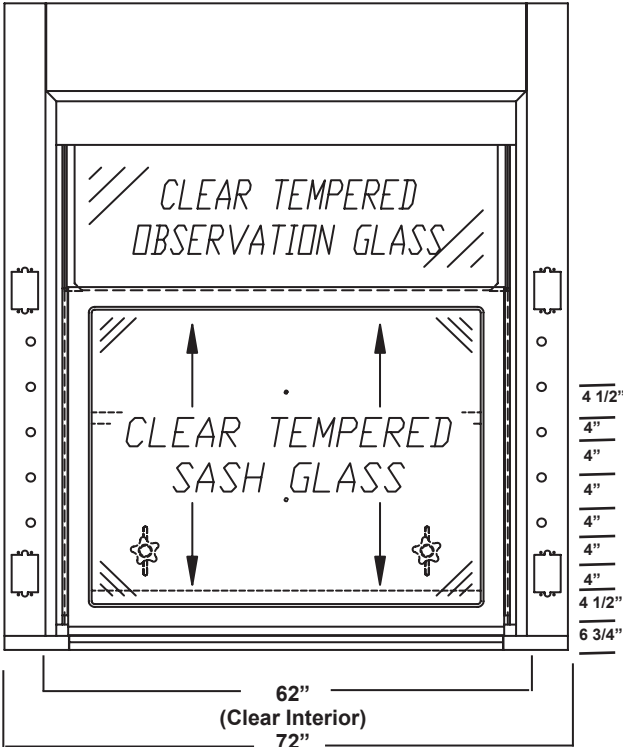
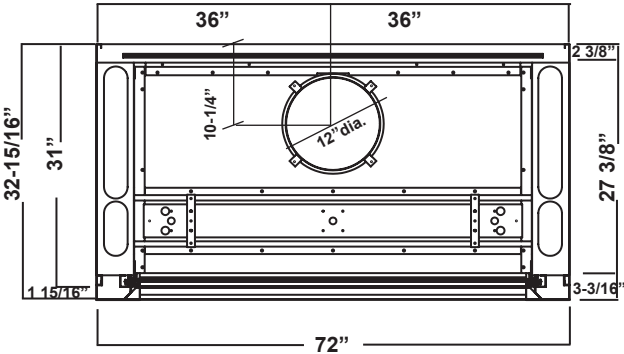

Note:
 Counter Top Material:
 29"D or 35"D

F-103 ISOLATOR GEN-5 Bench Hood – Product Dimensions

Each 5" wide fascia pre-punched with two electrical cutouts and five, 3/4" diameter holes for rod driven remote fixtures.
(Total: 4 electrical cutouts; 10, pre-punched holes, per hood) 10 hole plugs provided.

Counter Top Depth: 29" or 35" D. The 6" x 3" cup sinks shown are optional.

Outside, Overall Height: 57-1/8"

Outside, Overall Depth: 32-15/16"

Equipped with 10" or 12" diameter, stainless steel duct collar.

24" or 30" Clear Interior Depth - Specify by Unit # Selection.

48" Clear Interior Height. Height from bottom of hood to top of duct collar is 51-1/2".

F-103-96G5 - 96" BENCH FUME HOOD

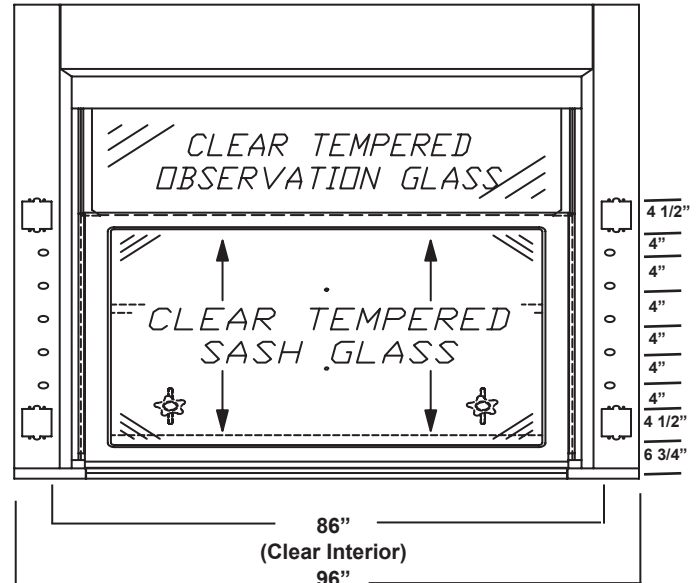
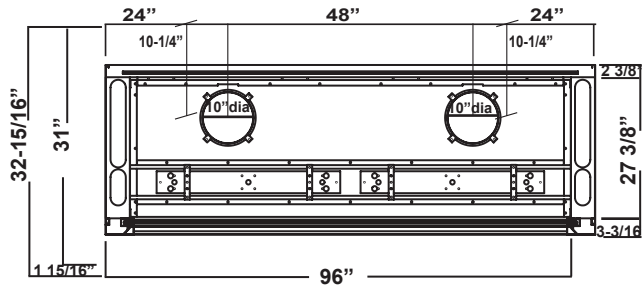

Note:
Counter Top Material:
29"D or 35"D

F-103-G5 - BENCH FUME HOOD SIDE VIEWS, OPEN & CLOSED

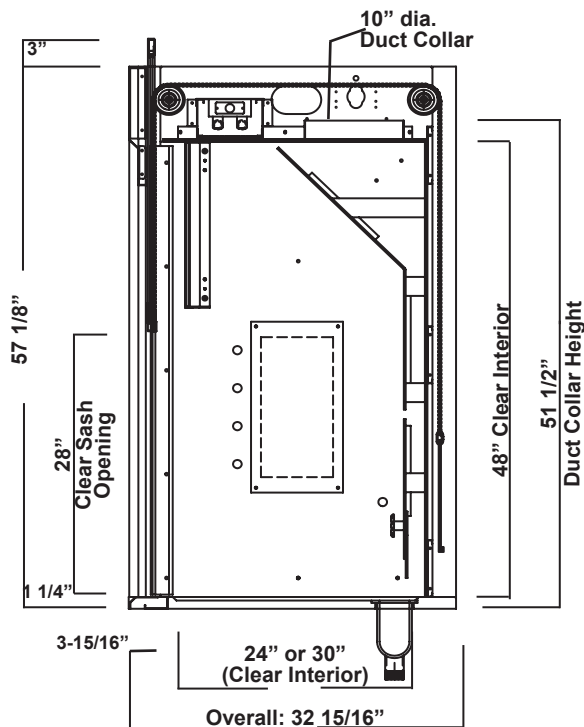

Note:
Counter Top Material:
29"D or 35"D

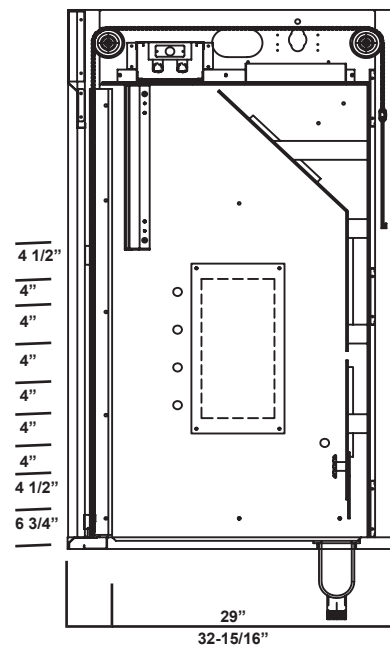

INTENTIONALLY BLANK



F-200 ISOLATOR GEN-5 Walk-In Hood – Frameless Vertical Sash

This ISOLATOR GENERATION-5 bypass walk-in fume hood with the frameless vertical sash mirrors the bench style unit in design and function. The top view-pass is clear tempered glass. These units are normally used with tall setups where maximum clarity of vision is a priority. When floor mounted, the walk-in's top fascia aligns with a standard bench hood thus providing a clean look to any design utilizing both types of hood. The ISOLATOR GEN-5 design and construction enhances its value by providing:

- Unparalleled user safety
- Full hood access for easy set ups
- Years of maintenance free service
- Unmatched ease of use
- Unique design qualities for unlimited customization possibilities
- Field conversion between Constant Air Volume (CAV) and Variable Air Volume (VAV)
- Hoods available in “Knock Down” (KD) mode for transport and assembly in restricted areas

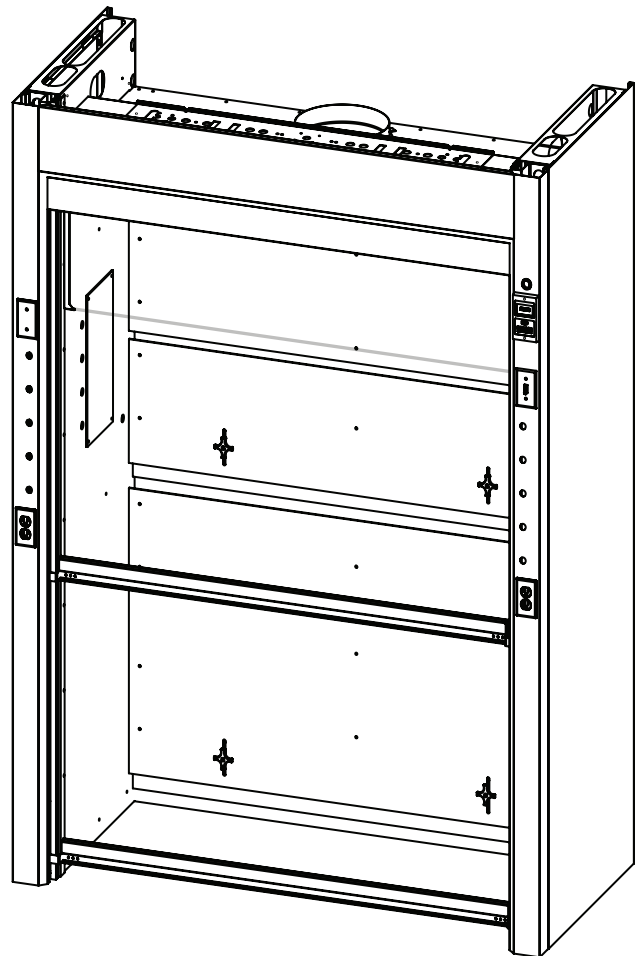

F-200 ISOLATOR GEN-5 WALK-IN FUME HOOD - PRODUCT FEATURES

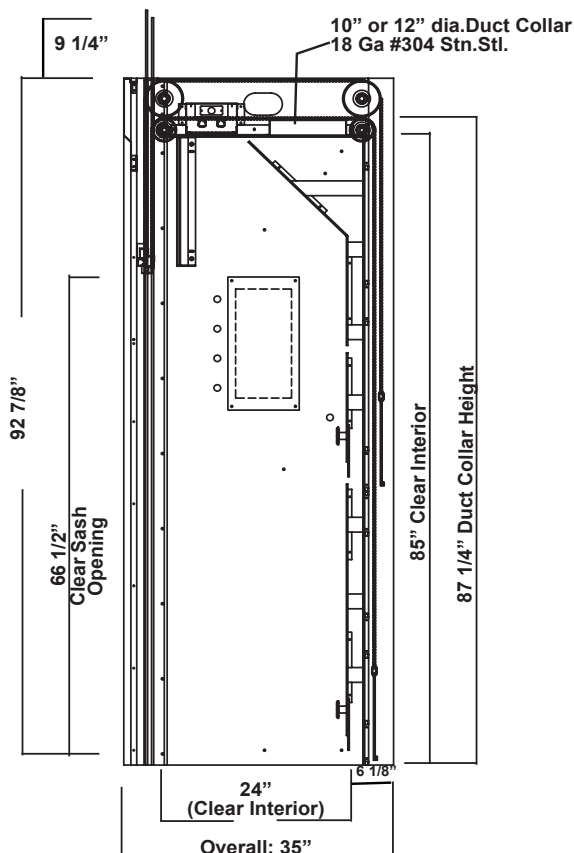

F-200 ISOLATOR GEN-5 Walk-In Hood Features

- Unsurpassed containment (designed and tested to exceed ASHRAE 110-1995)
- Hood is UL1805/CUL certified listed
- Unique chain driven sash mechanism that comes with a lifetime warranty
- Galvanized steel pan superstructure
- 17.25" H. clear observation glass panel, bypass system
- Non-metallic interior
- Vertical sashes provide the greatest hood interior access
- Full view frameless sash with 66-1/2" upper and lower sash openings
- Quality engineering ensures years of reliable service



F-200 ISOLATOR GEN-5 Series Walk-In Fume Hoods – Ordering Information

F-200 GEN-5 Walk-In Air Flow Data

Catalog Number	Duct Diameter	31 1/2" Vertical Open Upper Sash @ 100 FPM	18" Vertical Open Upper Sash @ 100 FPM
F-200-48G5	1 : 10"	857 CFM @ .38" SP	501 CFM @ .13" SP
F-200-60G5	1 : 12"	1127 CFM @ .46" SP	660 CFM @ .16" SP
F-200-72G5	1 : 12"	1398 CFM @ .71" SP	818 CFM @ .25" SP
F-200-96G5	2 : 10"	1939 CFM @ .49" SP	1135 CFM @ .17" SP

F-200 GEN-5 Walk-In Hood Product Numbers

F-200-48G5	Walk-In 48"	Frameless	24" Deep, Clear Interior
F-200-48G5D30	Walk-In 48"	Frameless	30" Deep, Clear Interior
F-200-60G5	Walk-In 60"	Frameless	24" Deep, Clear Interior
F-200-60G5D30	Walk-In 60"	Frameless	30" Deep, Clear Interior
F-200-G572	Walk-In 72"	Frameless	24" Deep, Clear Interior
F-200-72G5D30	Walk-In 72"	Frameless	30" Deep, Clear Interior
F-200-96G5	Walk-In 96"	Frameless	24" Deep, Clear Interior
F-200-96G5D30	Walk-In 96"	Frameless	30" Deep, Clear Interior

F-200 GEN-5 Liner Options

White Polyglass is standard. Please see the Hood Liners section for available options.

F-200 GEN-5 Electrical Options

Fascia is pre-punched with two electrical cutouts (four cutouts total). Please see the Electrical Fixtures section for available options.

F-200 GEN-5 Plumbing Fixtures

Fascia is pre-punched with five 3/4" dia. holes to accept rod driven remote fixtures (ten holes total). Please see the Plumbing Fixtures section for available options.

F-200 GEN-5 Fume Hood Accessories

Please see the Fume Hood Accessories section for available options.

F-200 ISOLATOR GEN-5 Walk-In Hood – Product Dimensions

Each 5" wide fascia pre-punched with two electrical cutouts and five, 3/4" diameter holes for rod driven remote fixtures.

(Total: 4 electrical cutouts; 10, pre-punched holes, per hood) 10 hole plugs provided.

Outside, Overall Height: 92-7/8"

Outside, Overall Depth: 35"

Equipped with 10" or 12" diameter, stainless steel duct collar.

24" or 30" Clear Interior Depth - Specify by Unit # Selection.

85" Clear Interior Height. Height from bottom of hood to top of duct collar is 87-1/4".

F-200-48G5 - 48" WALK-IN FUME HOOD

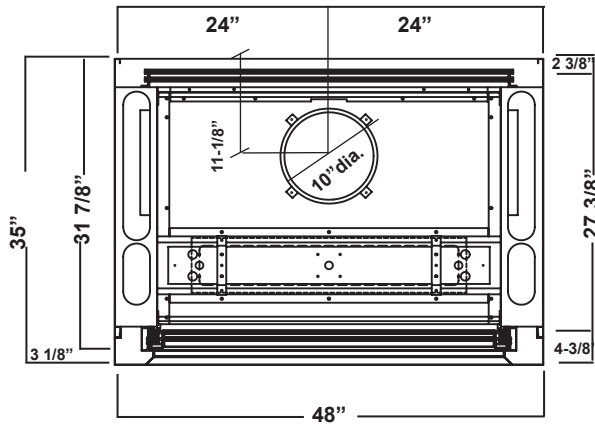
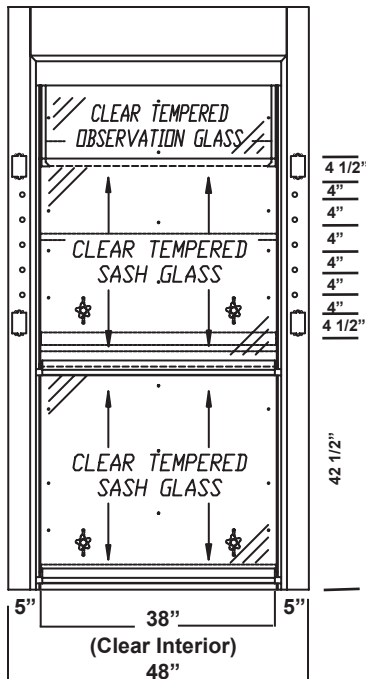

F-200-60G5 - 60" WALK-IN FUME HOOD

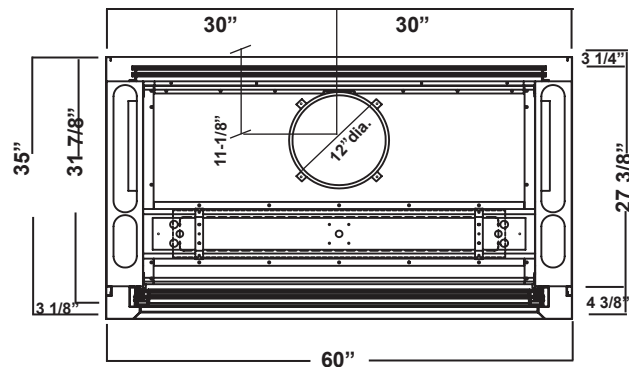
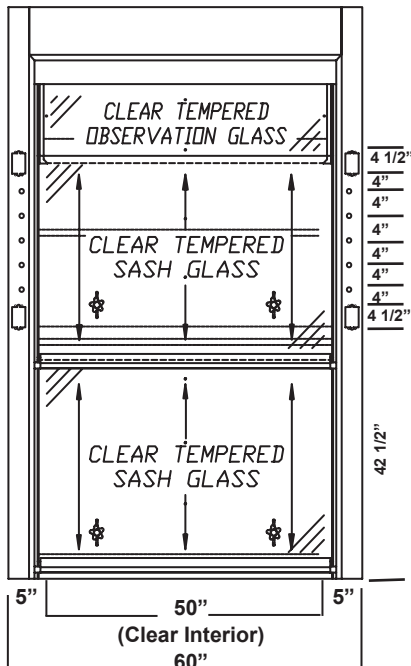

F-200 ISOLATOR GEN-5 Walk-In Hood – Product Dimensions

Each 5" wide fascia pre-punched with two electrical cutouts and five, 3/4" diameter holes for rod driven remote fixtures.
 (Total: 4 electrical cutouts; 10, pre-punched holes, per hood) 10 hole plugs provided.
 Outside, Overall Height: 92-7/8"
 Outside, Overall Depth: 35"
 Equipped with 10" or 12" diameter, stainless steel duct collar.

24" or 30" Clear Interior Depth - Specify by Unit # Selection.
 85" Clear Interior Height. Height from bottom of hood to top of duct collar is 87-1/4".

F-200-72G5 - 72" WALK-IN FUME HOOD

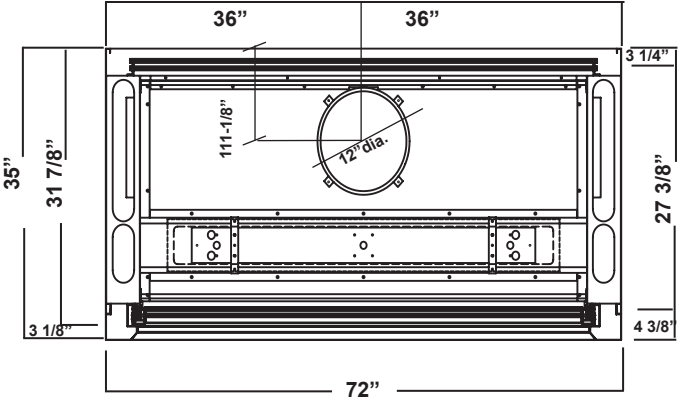
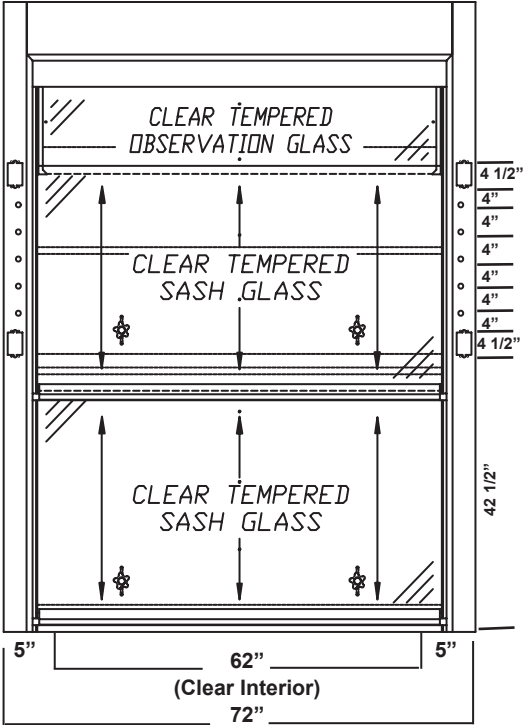

F-200-96G5 - 96" WALK-IN FUME HOOD

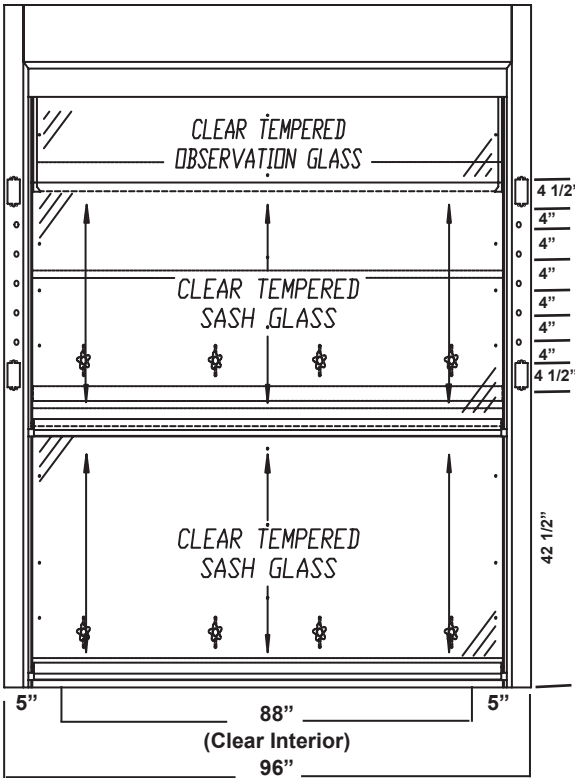
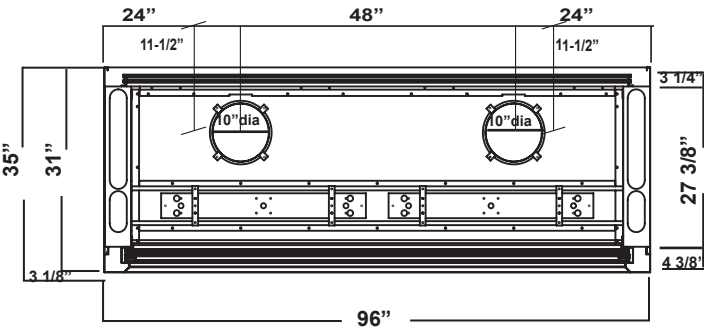

F-200 ISOLATOR GEN-5 Walk-In Hood – Product Dimensions

F-200-G5 - WALK-IN FUME HOOD SIDE VIEWS, OPEN & CLOSED

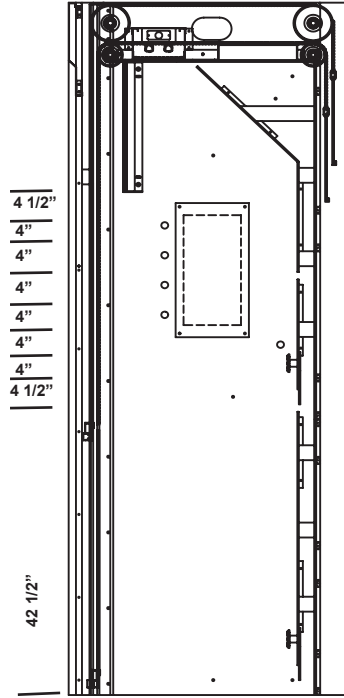
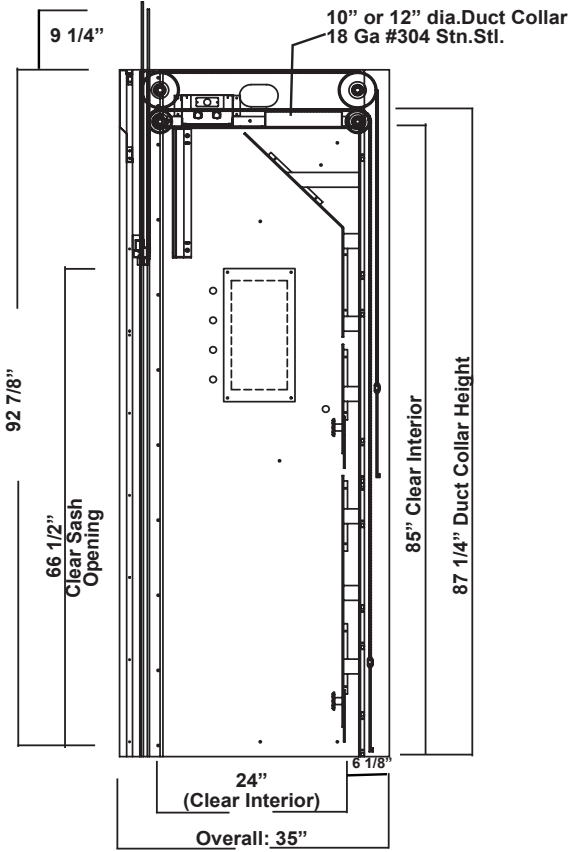

F-200 ISOLATOR GEN-5 WALK-IN FUME HOOD - PRODUCT DIMENSIONS



INTENTIONALLY BLANK



F-201 ISOLATOR GEN-5 Walk-In Hood – Combination Sash

This ISOLATOR GENERATION-5 bypass walk-in fume hood with a combination sash mirrors the bench style unit in design and function. The top view pass is clear tempered glass. These units are normally used with tall setups where maximum clarity of vision is a priority. When floor mounted, the walk-in's top fascia aligns with a standard bench hood thus providing a clean look to any design utilizing both types of hood. The ISOLATOR Gen-5 design and construction enhances its value by providing:

- Unparalleled user safety
- Years of maintenance free service
- Unmatched ease of use
- Substantial energy savings via the sash configuration
- Unique design qualities for unlimited customization possibilities
- Field conversion between Constant Air Volume (CAV) and Variable Air Volume (VAV)
- Hoods available in "Knock Down" (KD) mode for transport and assembly in restricted areas

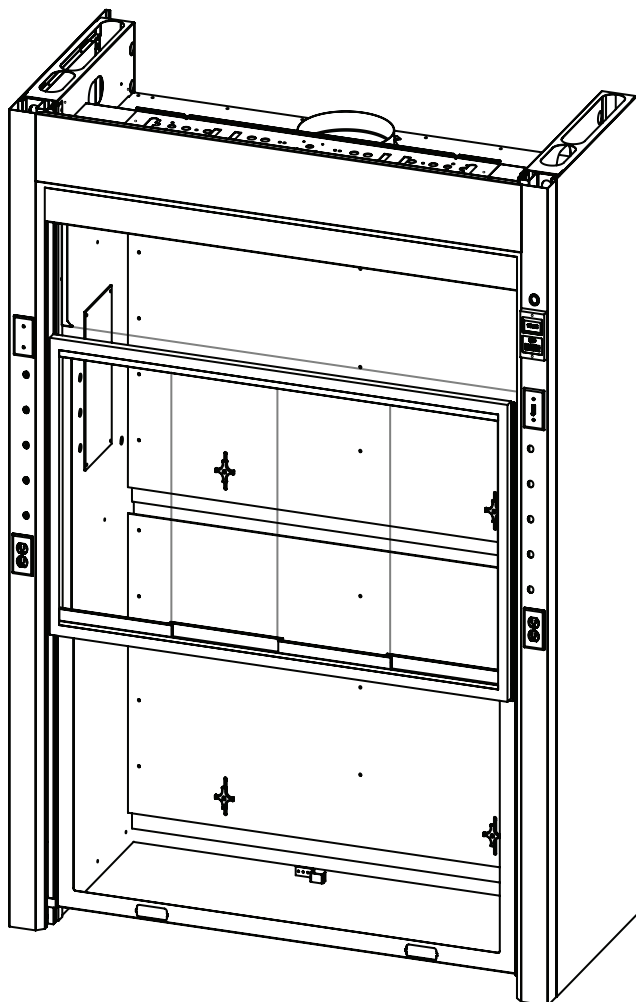

F-201 ISOLATOR GEN-5 WALK-IN FUME HOOD - PRODUCT FEATURES

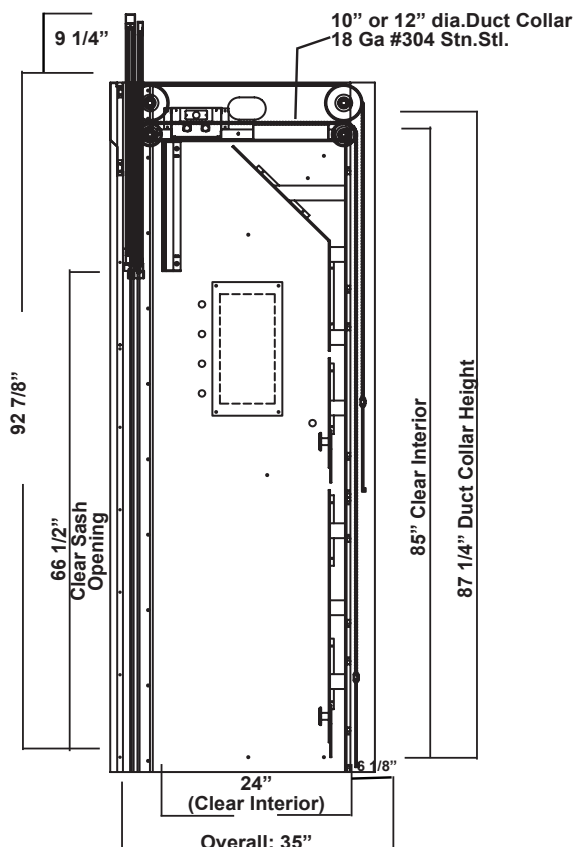

F-201 ISOLATOR GEN-5 Walk-In Hood Features

- Unsurpassed containment (designed and tested to exceed ASHRAE 110-1995)
- Hood is UL1805/CUL certified listed
- Unique chain driven sash mechanism that comes with a lifetime warranty
- Galvanized steel pan superstructure
- 17.25"H. clear observation glass panel, bypass system
- Non-metallic interior
- Vertical sashes provide the greatest hood interior access
- Full view combination sash with 66-1/2" upper and lower sash openings
- Quality engineering ensures years of reliable service



F-201 ISOLATOR GEN-5 Walk-In Hood – Ordering Information

F-201 GEN-5 Walk-In Hood Air Flow Data

Catalog Number	Duct Diameter	31 1/2" Vertical Open Upper Sash @ 100 FPM	15 3/4" Vertical Open Upper Sash @ 100 FPM
F-201-48G5	1 : 10"	857 CFM @ .38" SP	445 CFM @ .10" SP
F-201-60G5	1 : 12"	1127 CFM @ .46" SP	591 CFM @ .12" SP
F-201-72G5	1 : 12"	1398 CFM @ .71" SP	743 CFM @ .20" SP
F-201-96G5	2 : 10"	1939 CFM @ .49" SP	1038 CFM @ .14" SP

F-201 GEN-5 Walk-In Hood Product Numbers

F-201-48G5	W-I 48"	Combo & Framed (2 trk)	24" Deep, Clear Interior
F-201-48G5D30	W-I 48"	Combo & Framed (2 trk)	30" Deep, Clear Interior
F-201-60G5	W-I 60"	Combo & Framed (2 trk)	24" Deep, Clear Interior
F-201-60G5D30	W-I 60"	Combo & Framed (2 trk)	30" Deep, Clear Interior
F-201-72G5	W-I 72"	Combo & Framed (2 trk)	24" Deep, Clear Interior
F-201-72G5D30	W-I 72"	Combo & Framed (2 trk)	30" Deep, Clear Interior
F-201-96G5	W-I 96"	Combo & Framed (2 trk)	24" Deep, Clear Interior
F-201-96G5D30	W-I 96"	Combo & Framed (2 trk)	30" Deep, Clear Interior

F-201 GEN-5 Walk-In Hood Liner Options

White Polyglass is standard. Please see the Hood Liners section for available options.

F-201 GEN-5 Walk-In Hood Electrical Options

Fascia is pre-punched with two electrical cutouts (four cutouts total). Please see the Electrical Fixtures section for available options.

F-201 GEN-5 Walk-In Hood Plumbing Fixtures

Fascia is pre-punched with five 3/4" dia. holes to accept rod driven remote fixtures (ten holes total). Please see the Plumbing Fixtures section for available options.

F-201 GEN-5 Walk-In Hood Fume Hood Accessories

Please see the Fume Hood Accessories section for available options.

F-201 ISOLATOR GEN-5 Walk-In Hood – Product Dimensions

Each 5" wide fascia pre-punched with two electrical cutouts and five, 3/4" diameter holes for rod driven remote fixtures.
(Total: 4 electrical cutouts; 10, pre-punched holes, per hood) 10 hole plugs provided.

Outside, Overall Height: 92-7/8"

Outside, Overall Depth: 35"

Equipped with 10" or 12" diameter, stainless steel duct collar.

24" or 30" Clear Interior Depth - Specify by Unit # Selection.

85" Clear Interior Height. Height from bottom of hood to top of duct collar is 87-1/4".

F-201-48G5 - 48" WALK-IN FUME HOOD

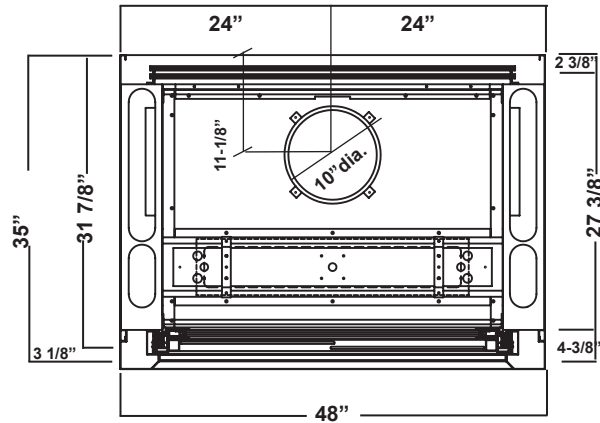
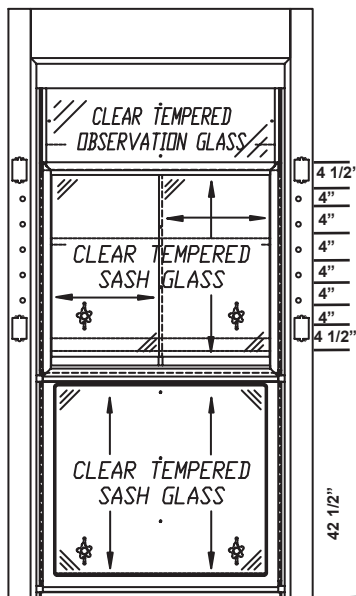

F-201-60G5 - 60" WALK-IN FUME HOOD

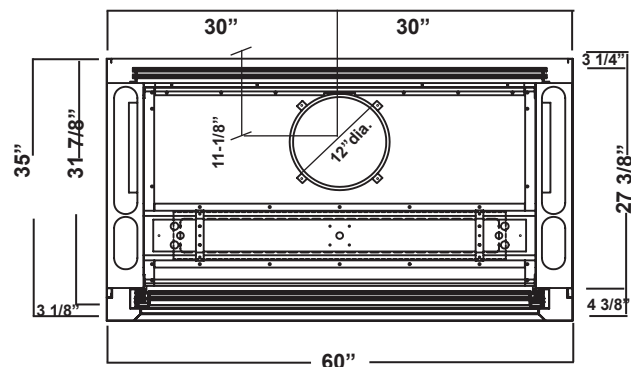
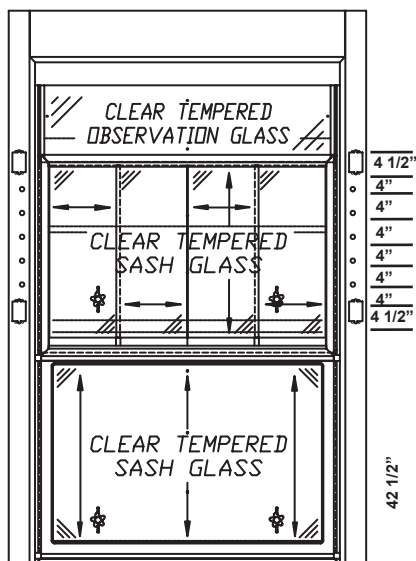

F-201 ISOLATOR GEN-5 Walk-In Hood – Product Dimensions

Each 5" wide fascia pre-punched with two electrical cutouts and five, 3/4" diameter holes for rod driven remote fixtures.
 (Total: 4 electrical cutouts; 10, pre-punched holes, per hood) 10 hole plugs provided.
 Outside, Overall Height: 92-7/8"
 Outside, Overall Depth: 35"
 Equipped with 10" or 12" diameter, stainless steel duct collar.
 24" or 30" Clear Interior Depth - Specify by Unit # Selection.
 85" Clear Interior Height. Height from bottom of hood to top of duct collar is 87-1/4".

F-201-72G5 - 72" WALK-IN FUME HOOD

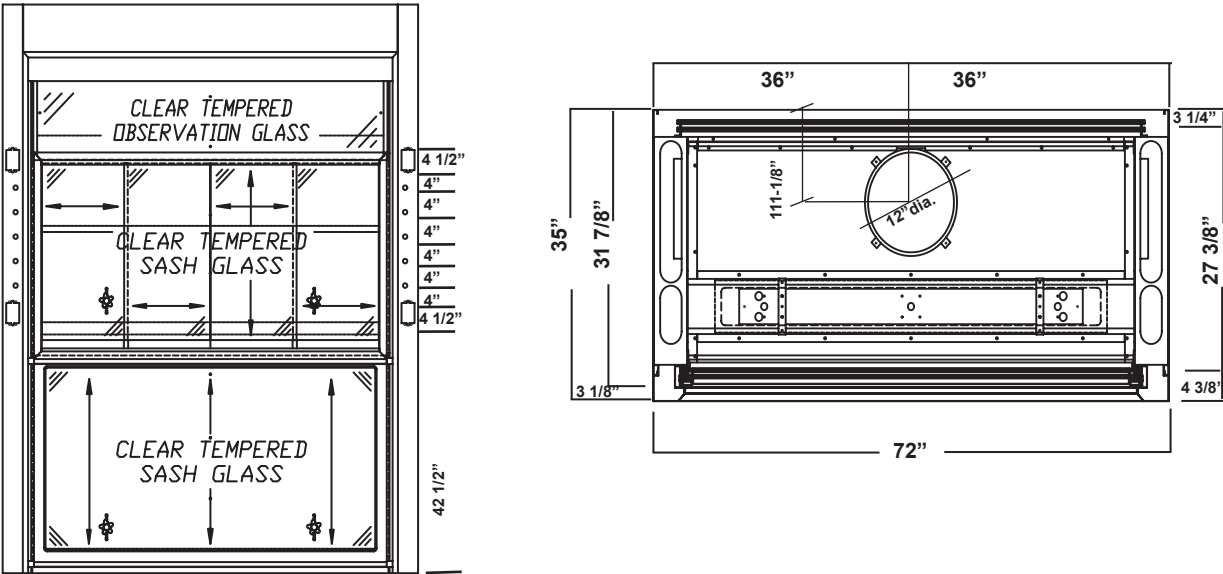

F-201-96G5 - 96" WALK-IN FUME HOOD

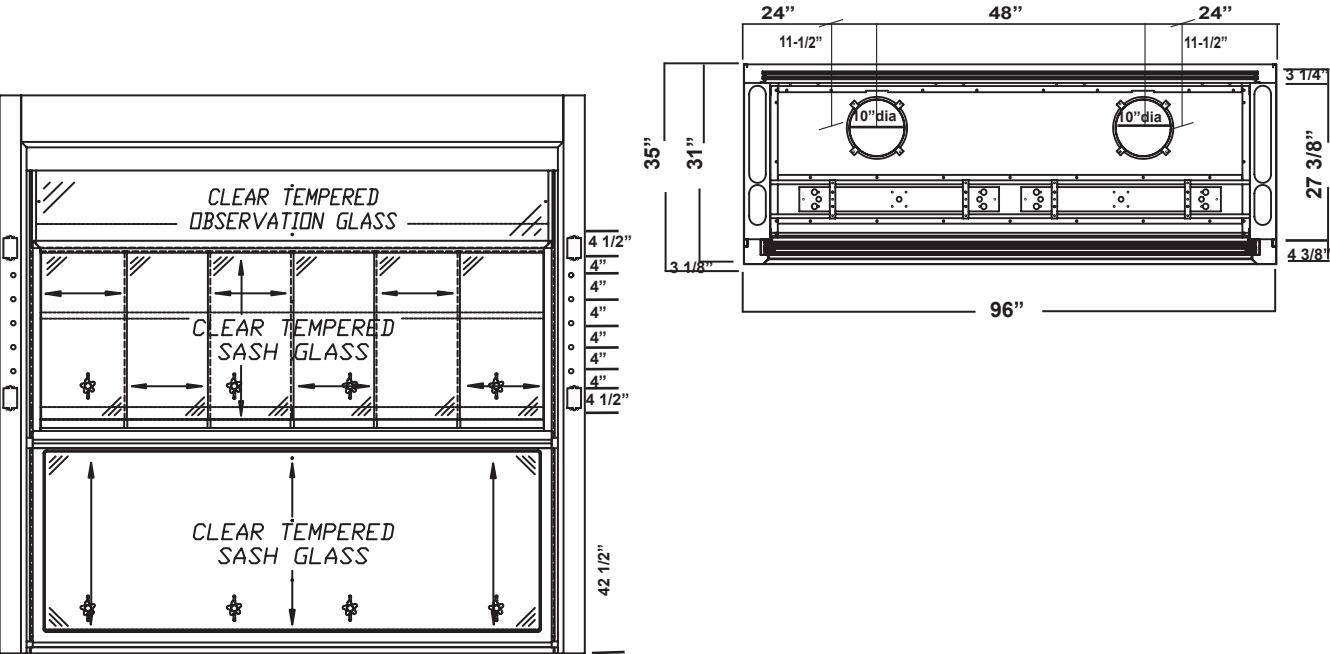

F-201 ISOLATOR GEN-5 Walk-In Hood – Product Dimensions

F-201 ISOLATOR GEN-5 WALK-IN FUME HOOD - PRODUCT DIMENSIONS

F-201-G5 - WALK-IN FUME HOOD SIDE VIEWS, OPEN & CLOSED

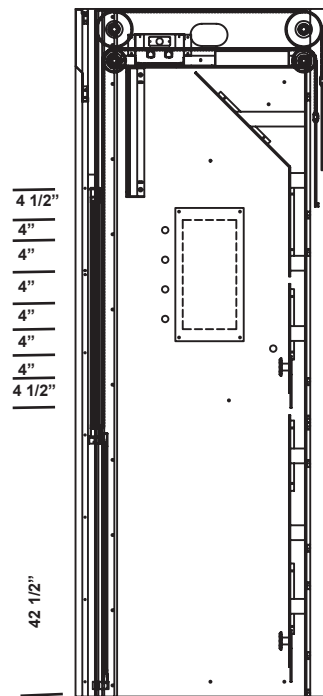
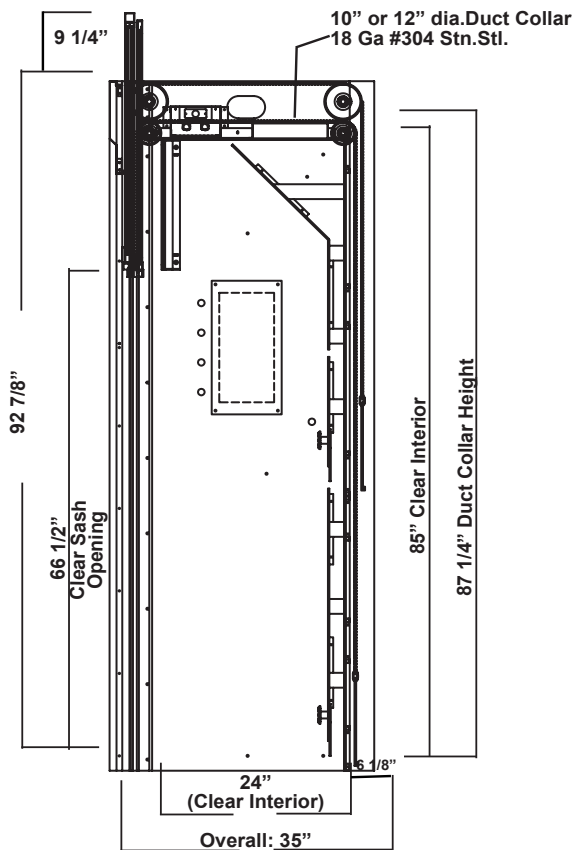

INTENTIONALLY BLANK



F-203 ISOLATOR GEN-5 Walk-In Hood – Framed Vertical Sash

This ISOLATOR GENERATOR-5 bypass walk-in fume hood with the framed vertical sash mirrors the bench style unit in design and function. The top view pass is clear tempered glass. These units are normally used with tall setups where maximum clarity of vision is a priority. When floor mounted, the walk-in's top fascia aligns with a standard bench hood thus providing a clean look to any design utilizing both types of hood. The ISOLATOR GEN-5 design and construction enhances its value by providing:

- Unparalleled user safety
- Full hood access for easy set ups
- Years of maintenance free service
- Unmatched ease of use
- Unique design qualities for unlimited customization possibilities
- Field conversion between Constant Air Volume (CAV) and Variable Air Volume (VAV)
- Hoods available in “Knock Down” (KD) mode for transport and assembly in restricted areas

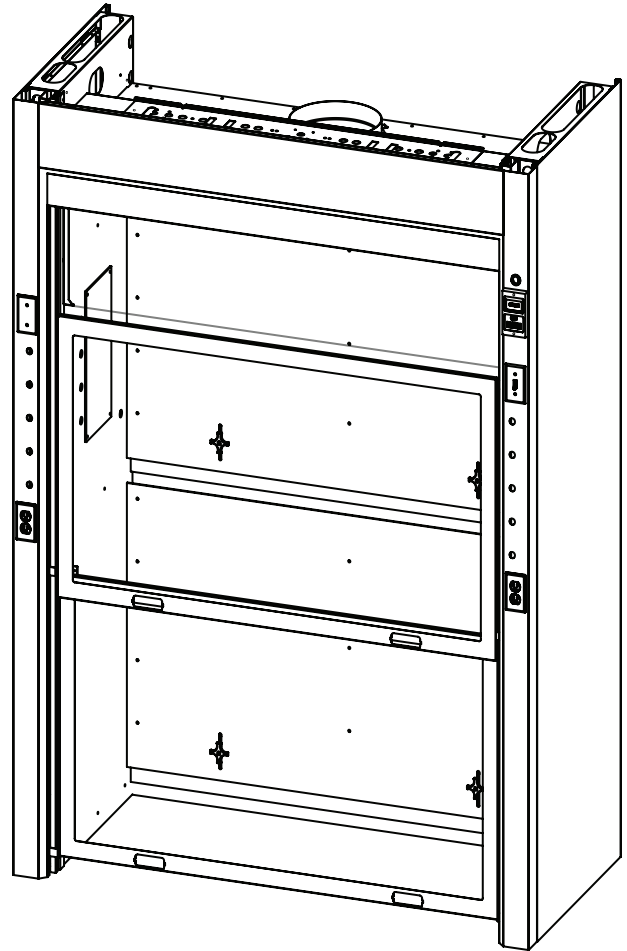
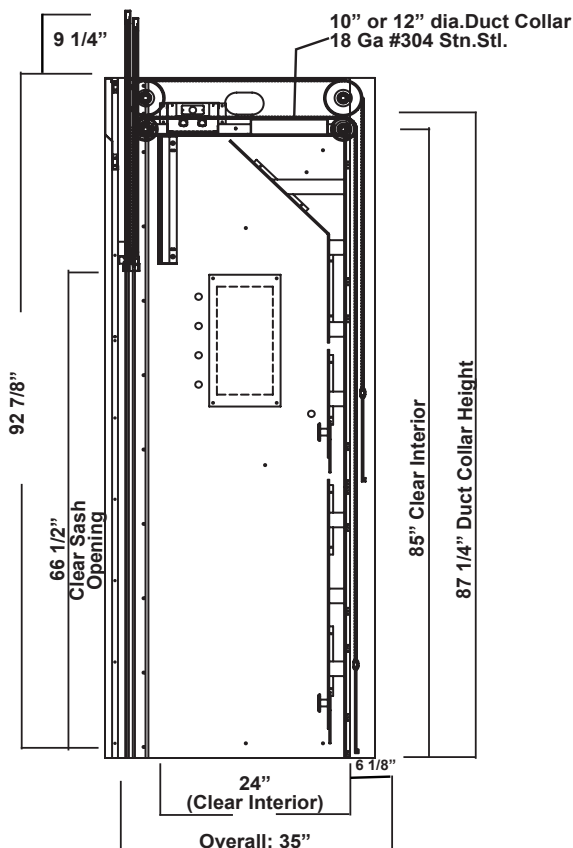

F-203 ISOLATOR GEN-5 WALK-IN FUME HOOD - PRODUCT FEATURES

F-203 ISOLATOR GEN-5 Walk-In Hood Features

- Unsurpassed containment (designed and tested to exceed ASHRAE 110-1995)
- Hood is UL1805/CUL certified listed
- Unique chain driven sash mechanism that comes with a lifetime warranty
- Galvanized steel pan superstructure
- 17.25"H. clear observation glass panel, bypass system
- Non-metallic Interior
- Vertical sashes provide the greatest hood interior access
- Full view framed sash with 66-1/2" upper and lower sash openings
- Quality engineering ensures years of reliable service



F-203 ISOLATOR GEN-5 Walk-In Hood – Ordering Information

F-203 GEN-5 Walk-In Hood Air Flow Data

Catalog Number	Duct Diameter	31 1/2" Vertical Open Upper Sash @ 100 FPM	18" Vertical Open Upper Sash @ 100 FPM
F-203-48G5	1 : 10"	857 CFM @ .38" SP	501 CFM @ .13" SP
F-203-60G5	1 : 12"	1127 CFM @ .46" SP	660 CFM @ .16" SP
F-203-72G5	1 : 12"	1398 CFM @ .71" SP	818 CFM @ .25" SP
F-203-96G5	2 : 10"	1939 CFM @ .49" SP	1135 CFM @ .17" SP

F-203 GEN-5 Walk-In Hood Product Numbers

F-203-48G5	Walk-In 48"	Framed (2)	24" Deep, Clear Interior
F-203-48G5D30	Walk-In 48"	Framed (2)	30" Deep, Clear Interior
F-203-60G5	Walk-In 60"	Framed (2)	24" Deep, Clear Interior
F-203-60G5D30	Walk-In 60"	Framed (2)	30" Deep, Clear Interior
F-203-72G5	Walk-In 72"	Framed (2)	24" Deep, Clear Interior
F-203-72G5D30	Walk-In 72"	Framed (2)	30" Deep, Clear Interior
F-203-96G5	Walk-In 96"	Framed (2)	24" Deep, Clear Interior
F-203-96G5D30	Walk-In 96"	Framed (2)	30" Deep, Clear Interior

F-203 GEN-5 Walk-In Hood Liner Options

White Polyglass is standard. Please see the Hood Liners section for available options.

F-203 GEN-5 Walk-In Hood Electrical Options

Fascia is pre-punched with two electrical cutouts (four cutouts total). Please see the Electrical Fixtures section for available options.

F-203 GEN-5 Walk-In Hood Plumbing Fixtures

Fascia is pre-punched with five 3/4" dia. holes to accept rod driven remote fixtures (ten holes total). Please see the Plumbing Fixtures section for available options.

F-203 GEN-5 Walk-In Hood Fume Hood Accessories

Please see the Fume Hood Accessories section for available options.

E-203 ISOLATOR GEN-5 WALK-IN FUME HOOD - PRODUCT DIMENSIONS

(Total: 4 electrical cutouts; 10, pre-punched holes, per hood) 10 hole plugs provided.

24" or 30" Clear Interior Depth - Specify by

Unit # Selection.

85" Clear Interior Height. Height from bottom of hood to top of duct collar is 87-1/4".

The diagram illustrates a three-pane window unit. The top pane is labeled "CLEAR TEMPERED OBSERVATION GLASS" and has a height of 4 1/2". The middle pane is labeled "CLEAR TEMPERED SASH GLASS" and has a height of 4 3/4". The bottom pane is also labeled "CLEAR TEMPERED SASH GLASS" and has a height of 4 1/2". The total height of the unit is 13 3/4". The diagram shows the internal structure, including the sash and frame, and indicates the placement of hardware like handles and locks. Arrows indicate the opening and closing direction of the sashes.

4 1/2"
4 3/4"
4 1/2"
13 3/4"

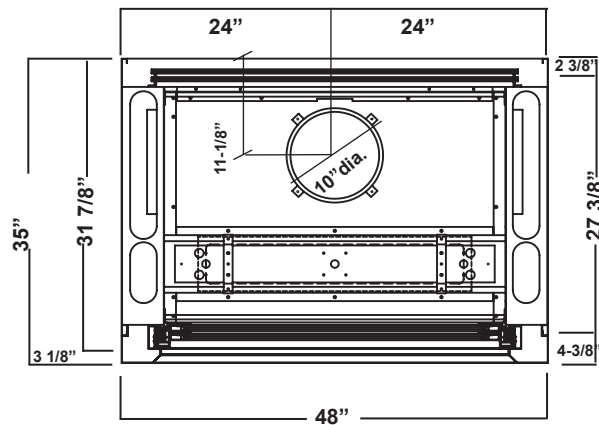

Technical drawing of the 60 inch x 31 inch rectangular table. The drawing shows the table from a top-down perspective, highlighting its rectangular shape and rounded corners. Key dimensions and features are labeled:

- Overall Dimensions:** 60" wide by 31 7/8" deep.
- Leg Height:** 35" (indicated on the left side).
- Tabletop Thickness:** 3 1/8" (indicated on the left side).
- Tabletop Material:** 30" wide by 30" deep (indicated at the top).
- Tabletop Material:** 11-1/8" (indicated on the left side).
- Tabletop Material:** 12" dia. (indicated on the right side).
- Tabletop Material:** 27 3/8" (indicated on the right side).
- Tabletop Material:** 4 3/8" (indicated on the right side).

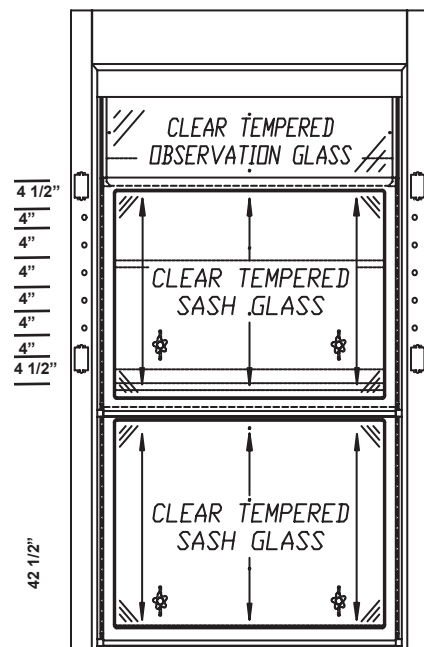

F-203 ISOLATOR GEN-5 Walk-In Hood – Product Dimensions

Each 5" wide fascia pre-punched with two electrical cutouts and five, 3/4" diameter holes for rod driven remote fixtures.
 (Total: 4 electrical cutouts; 10, pre-punched holes, per hood) 10 hole plugs provided.
 Outside, Overall Height: 92-7/8"
 Outside, Overall Depth: 35"
 Equipped with 10" or 12" diameter, stainless steel duct collar.

24" or 30" Clear Interior Depth - Specify by Unit # Selection.
 85" Clear Interior Height. Height from bottom of hood to top of duct collar is 87-1/4".

F-203-72G5 - 72" WALK-IN FUME HOOD

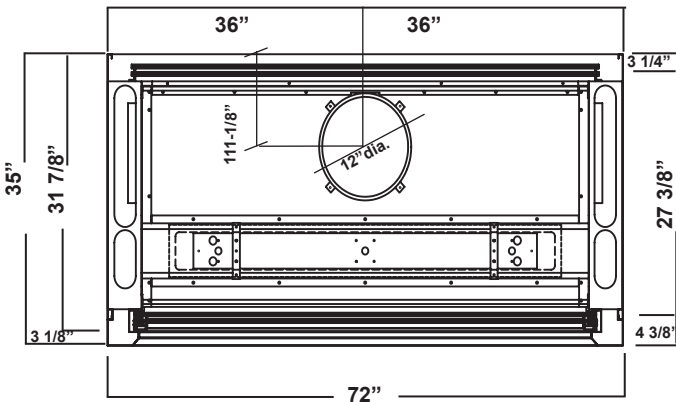
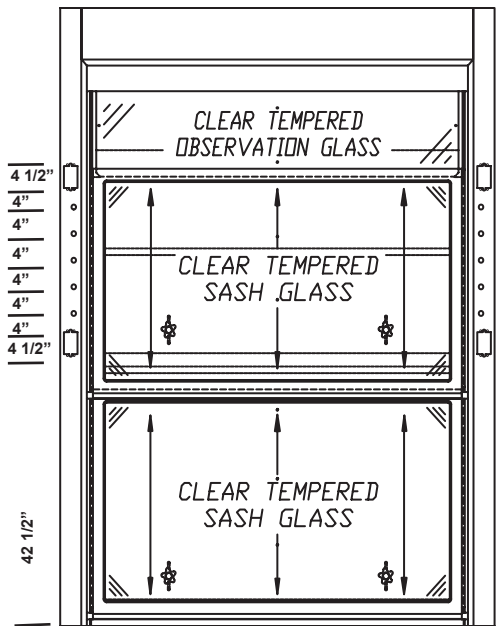

F-203-96G5 - 96" WALK-IN FUME HOOD

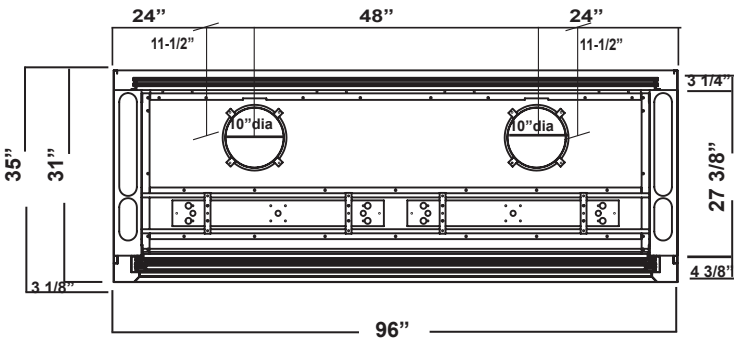
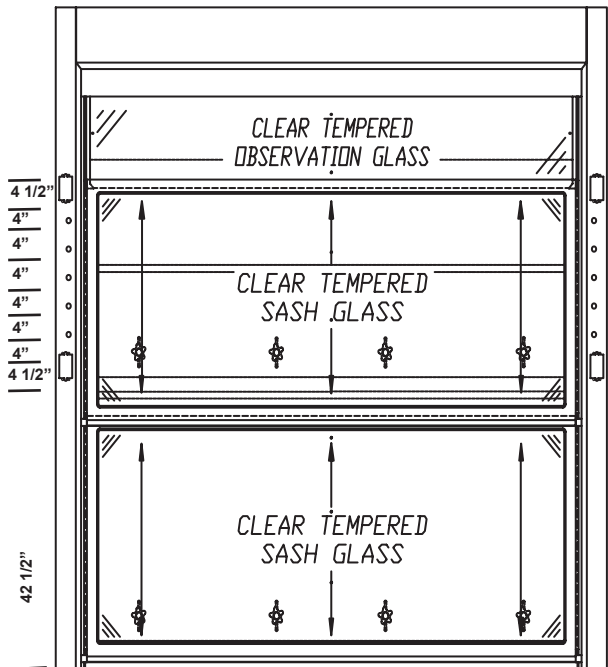

F-203 ISOLATOR GEN-5 Walk-In Hood – Product Dimensions

F-203 ISOLATOR GEN-5 WALK-IN FUME HOOD - PRODUCT DIMENSIONS

F-203-G5 - WALK-IN FUME HOOD SIDE VIEWS, OPEN & CLOSED

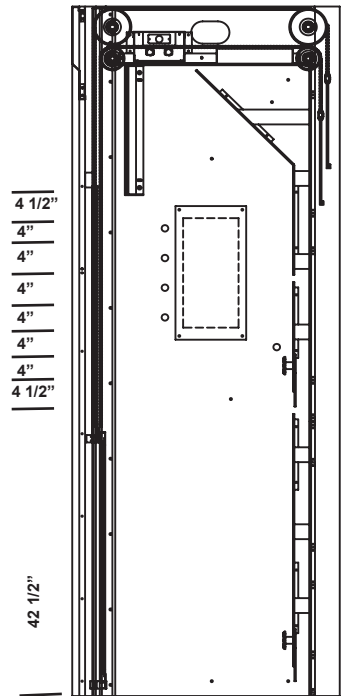
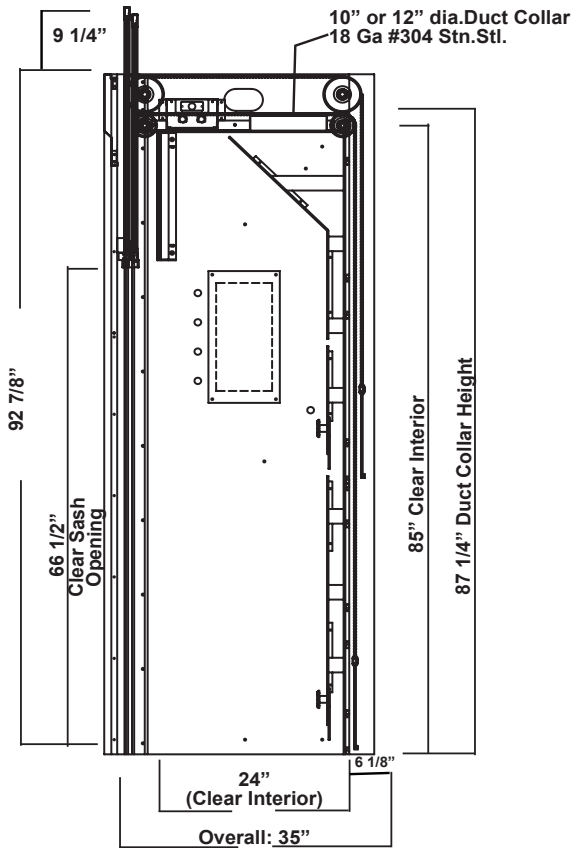

INTENTIONALLY BLANK



F-400 ISOLATOR GEN-5 Isotope Bench Hood – Frameless Vertical Sash

The ISOLATOR GENERATION-5 isotope fume hood with a frameless vertical sash, designed for use with radioisotope or biological work, features a type 304 or 316 stainless steel liner and baffles with coving on all containment chamber corners to facilitate cleaning. The integral work surface is reinforced to carry up to 200 lbs./sq. ft. of lead shielding or other overburden. The ISOLATOR GEN-5 design and construction enhances its value by providing:

- Unparalleled user safety
- Full hood access for easy set ups
- Years of maintenance free service
- Unmatched ease of use
- Unique design qualities for unlimited customization possibilities
- Field conversion between Constant Air Volume (CAV) and Variable Air Volume (VAV)

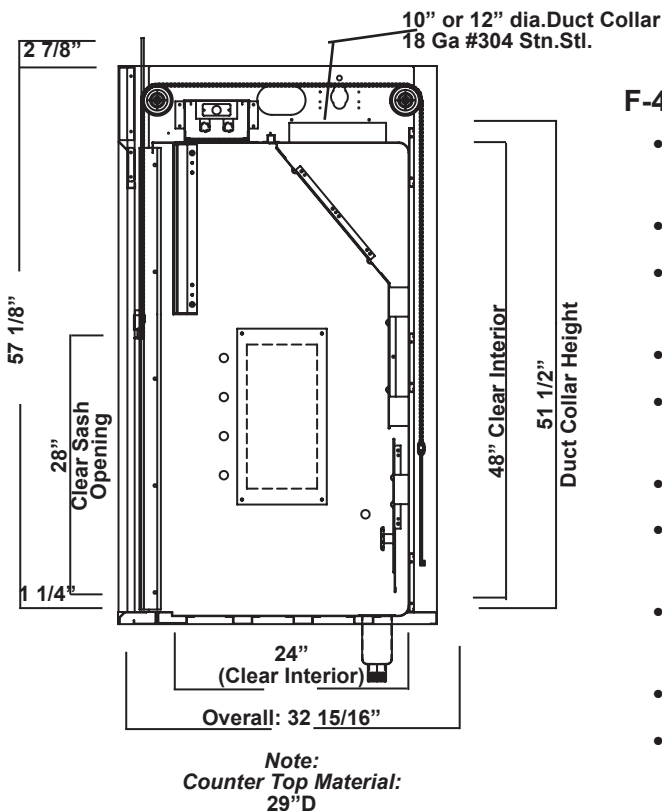
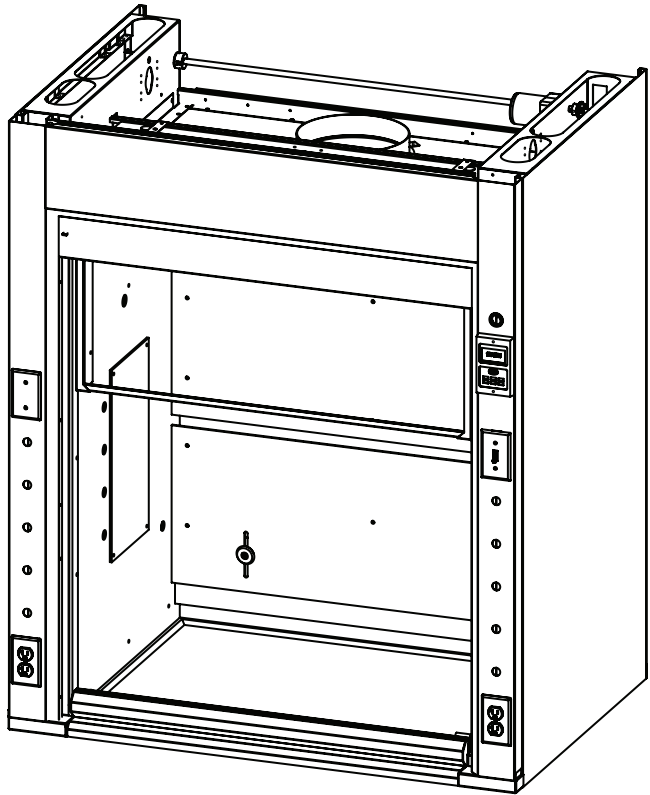

F-400 ISOLATOR GEN-5 Isotope Bench Hood Features

- Unsurpassed containment (designed and tested to exceed ASHRAE 110-1995)
- Hood is UL1805/CUL certified listed
- Unique chain driven sash mechanism that comes with a lifetime warranty
- Galvanized steel pan superstructure
- 16.25"H. clear observation glass panel, bypass system
- Stainless steel containment trough
- Integral type stainless steel work top; optional cup sink must be specified
- Vertical sashes provide the greatest hood interior access
- Full view frameless sash with 28" opening
- Quality engineering ensures years of reliable service
- The sash handle and the flush sill are 304 stainless steel

F-400 ISOLATOR GEN-5 Isotope Bench Hood – Ordering Information

F-400 ISOLATOR GEN-5 Isotope Bench Hood Air Flow Data

Catalog Number	Duct Diameter	28" Open @ 100 FPM	18" Open @ 100 FPM
F-400-36G5	1 : 10"	505 CFM @ .15" SP	325 CFM @ .06" SP
F-400-48G5	1 : 10"	739 CFM @ .32" SP	475 CFM @ .13" SP
F-400-60G5	1 : 12"	972 CFM @ .27" SP	625 CFM @ .11" SP
F-400-72G5	1 : 12"	1205 CFM @ .41" SP	775 CFM @ .17" SP
F-400-96G5	2 : 10"	1672 CFM @ .41" SP	1075 CFM @ .17" SP

F-400 ISOLATOR GEN-5 Isotope Bench Hood Product Numbers

F-400-36G5	Isotope 36"	Frameless Sash	(304 Coved)
F-400-48G5	Isotope 48"	Frameless Sash	(304 Coved)
F-400-60G5	Isotope 60"	Frameless Sash	(304 Coved)
F-400-72G5	Isotope 72"	Frameless Sash	(304 Coved)
F-400-96G5	Isotope 96"	Frameless Sash	(304 Coved)

F-400 GEN-5 Isotope Bench Hood Liner Options

Type 304 stainless steel liner and integral workshop is standard. Please see the Hood Liners section for available options.

F-400 GEN-5 Isotope Bench Hood Electrical Options

Fascia is pre-punched with two electrical cutouts (four cutouts total). Please see the Electrical Fixtures section for available options.

F-400 GEN-5 Isotope Bench Hood Plumbing Fixtures

Fascia is pre-punched with five 3/4" dia. holes to accept rod driven remote fixtures (ten holes total). Please see the Plumbing Fixtures section for available options.

F-400 GEN-5 Isotope Bench Hood Fume Hood Accessories

Please see the Fume Hood Accessories section for available options.

F-400 ISOLATOR GEN-5 Isotope Bench Hood – Product Dimensions

Each 5" wide fascia pre-punched with two electrical cutouts and five, 3/4" diameter holes for rod driven remote fixtures.
(Total: 4 electrical cutouts; 10, pre-punched holes, per hood) 10 hole plugs provided.

Counter Top Depth: 29" D. The 6" x 3" cup sinks shown are optional.

Outside, Overall Height: 57-1/8"

Outside, Overall Depth: 32-15/16"

Equipped with 10" or 12" diameter, stainless steel duct collar.

24" Clear Interior Depth

48" Clear Interior Height. Height from bottom of hood to top of duct collar is 51-1/2".

F-400-36G5 - 36" Isotope BENCH FUME HOOD

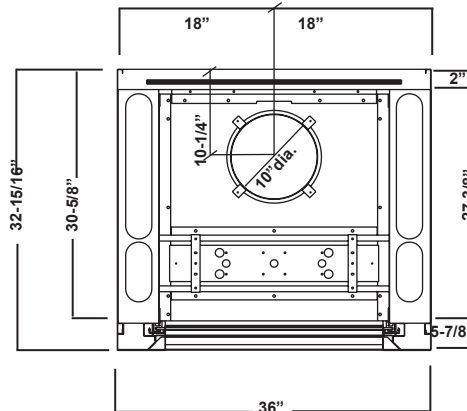
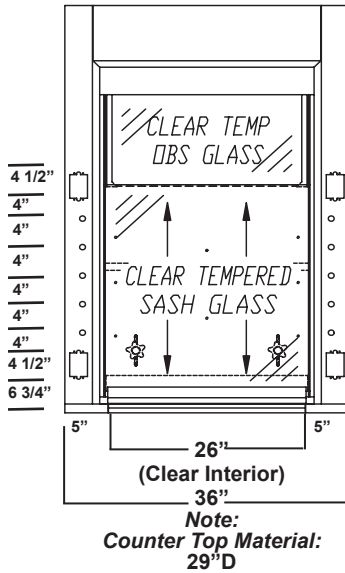

F-400-48G5 - 48" Isotope BENCH FUME HOOD

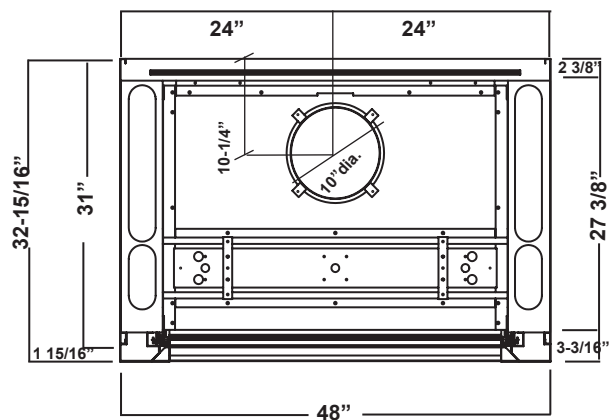
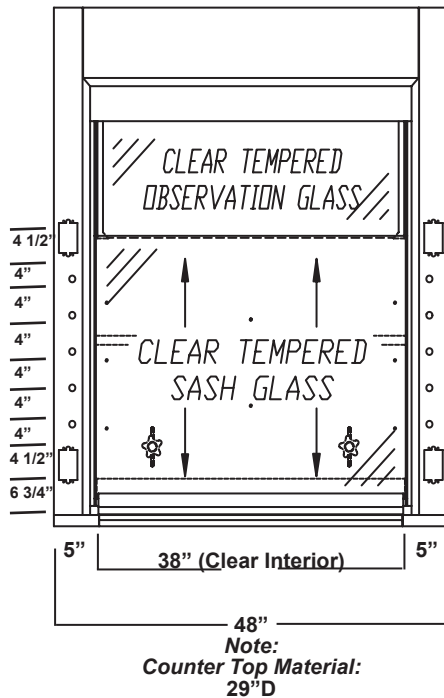

F-400 ISOLATOR GEN-5 Isotope Bench Hood – Product Dimensions

Each 5" wide fascia pre-punched with two electrical cutouts and five, 3/4" diameter holes for rod driven remote fixtures.
 (Total: 4 electrical cutouts; 10, pre-punched holes, per hood) 10 hole plugs provided.
 Counter Top Depth: 29" D. The 6" x 3" cup sinks shown are optional.
 Outside, Overall Height: 57-1/8"
 Outside, Overall Depth: 32-15/16"
 Equipped with 10" or 12" diameter, stainless steel duct collar.
 24" Clear Interior Depth
 48" Clear Interior Height. Height from bottom of hood to top of duct collar is 51-1/2".

F-400-60G5 - 60" Isotope BENCH FUME HOOD

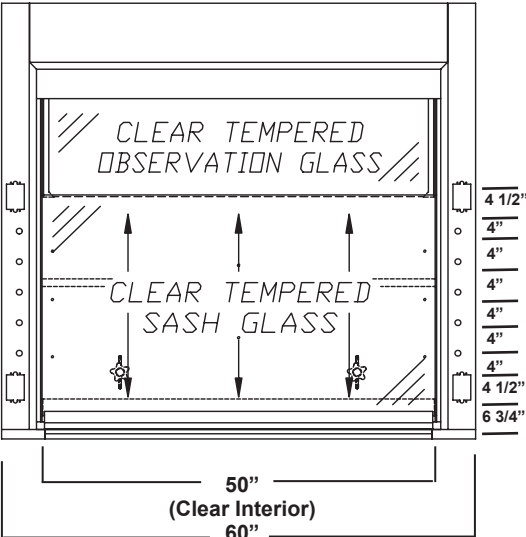
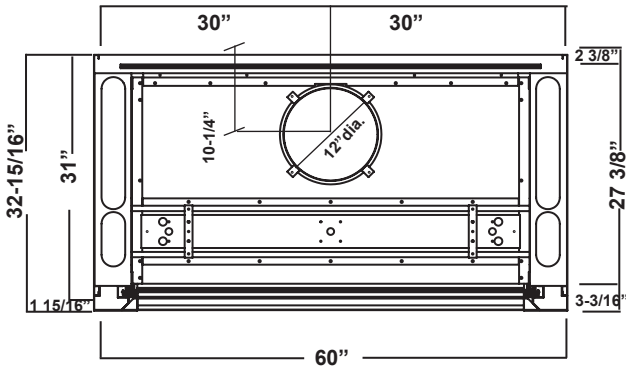

Note:
 Counter Top Material:
 29"D

F-400-72G5 - 72" Isotope BENCH FUME HOOD

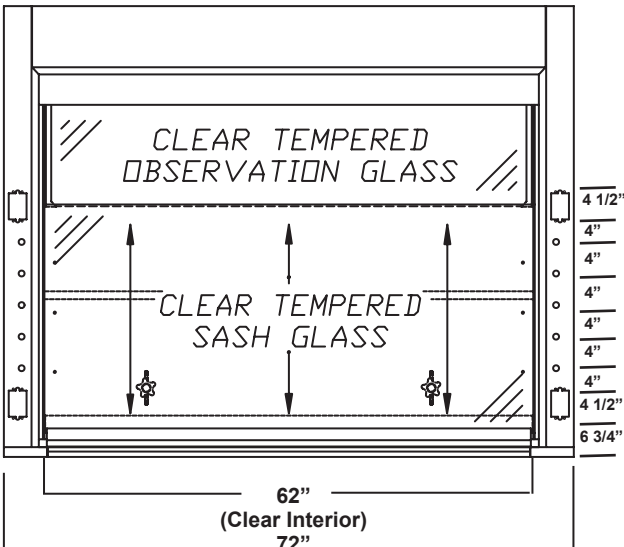
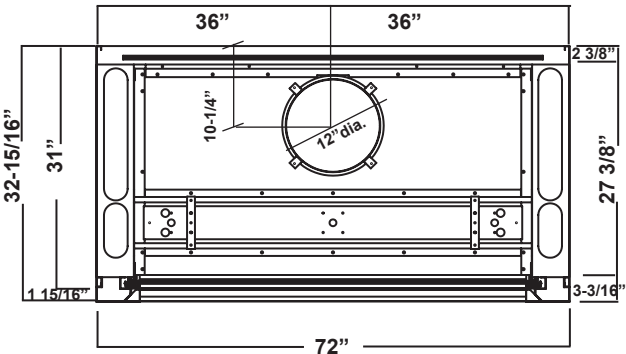

Note:
 Counter Top Material:
 29"D

F-400 ISOLATOR GEN-5 Isotope Bench Hood – Product Dimensions

Each 5" wide fascia pre-punched with two electrical cutouts and five, 3/4" diameter holes for rod driven remote fixtures.
(Total: 4 electrical cutouts; 10, pre-punched holes, per hood) 10 hole plugs provided.

Counter Top Depth: 29" D. The 6" x 3" cup sinks shown are optional.

Outside, Overall Height: 57-1/8"

24" Clear Interior Depth

Outside, Overall Depth: 32-15/16"

Equipped with 10" or 12" diameter, stainless steel duct collar.

48" Clear Interior Height. Height from bottom of hood to top of duct collar is 51-1/2".

F-400-96G5 - 96" Isotope BENCH FUME HOOD

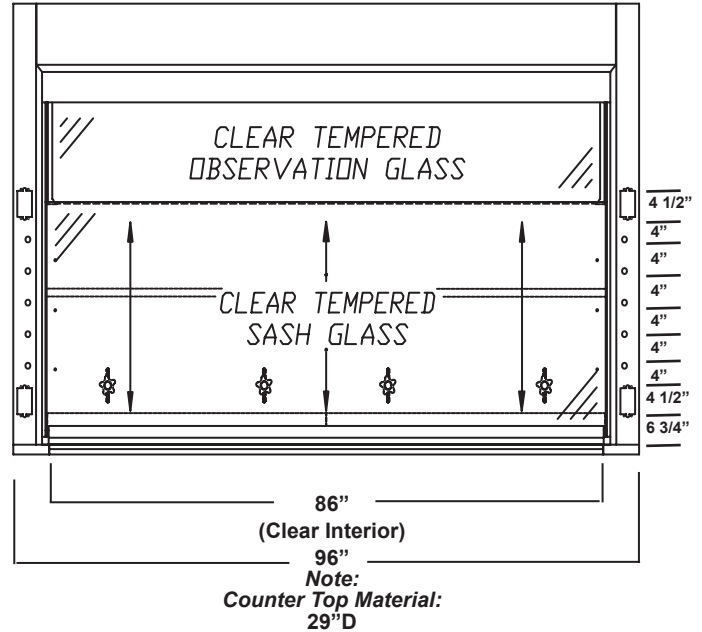
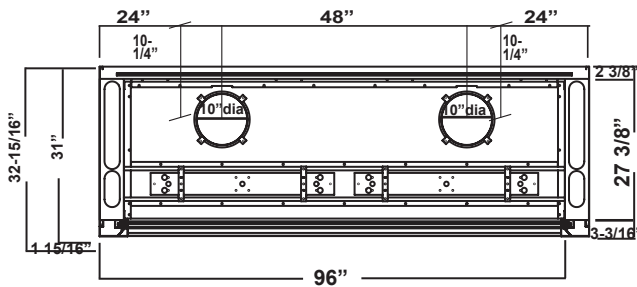

F-400-G5 - Isotope BENCH FUME HOOD SIDE VIEWS, OPEN & CLOSED

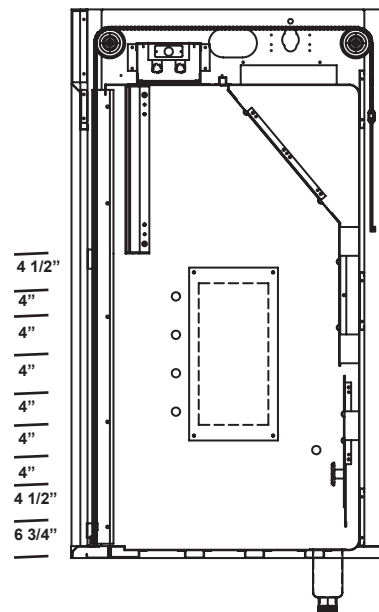
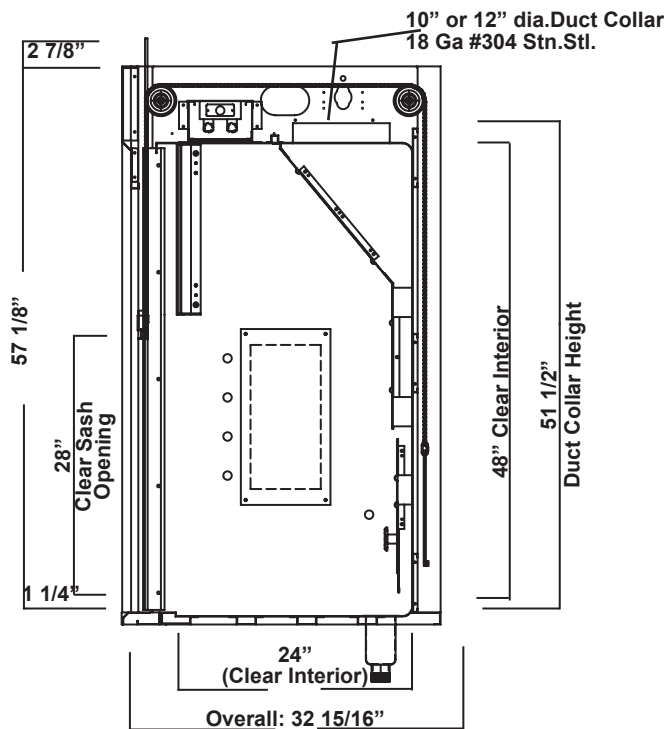

Note:
Counter Top Material:
29"D

INTENTIONALLY BLANK



F-401 ISOLATOR GEN-5 Isotope Bench Hood – Combination Sash

The ISOLATOR GENERATION-5 isotope fume hood with a combination sash, a combination sash, designed for use with radioisotope or biological work, features a type 304 or 316 stainless steel liner and baffles with coving on all containment chamber corners to facilitate cleaning. The integral work surface is reinforced to carry up to 200 lbs./sq. ft. of lead shielding or other overburden. The ISOLATOR GEN-5 design and construction enhances its value by providing:

- Unparalleled user safety
- Years of maintenance free service
- Unmatched ease of use
- Unique design qualities for unlimited customization possibilities
- Field conversion between Constant Air Volume (CAV) and Variable Air Volume (VAV)

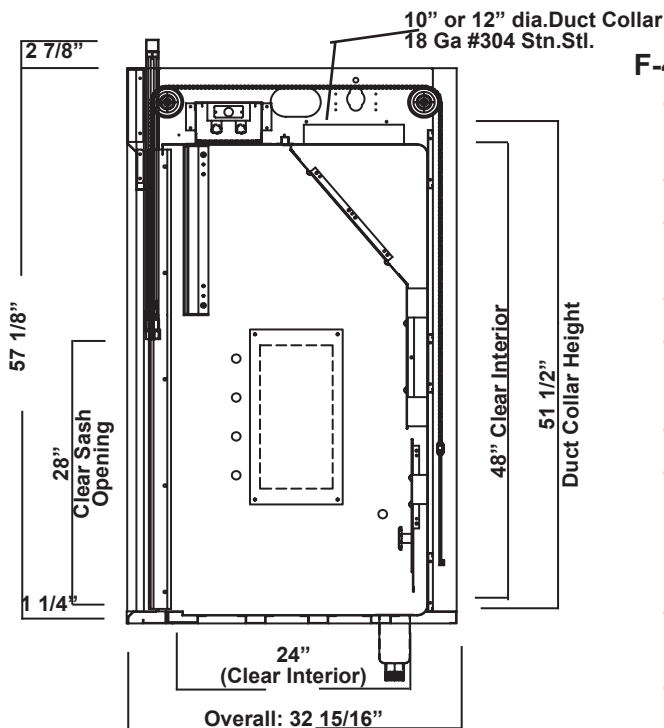
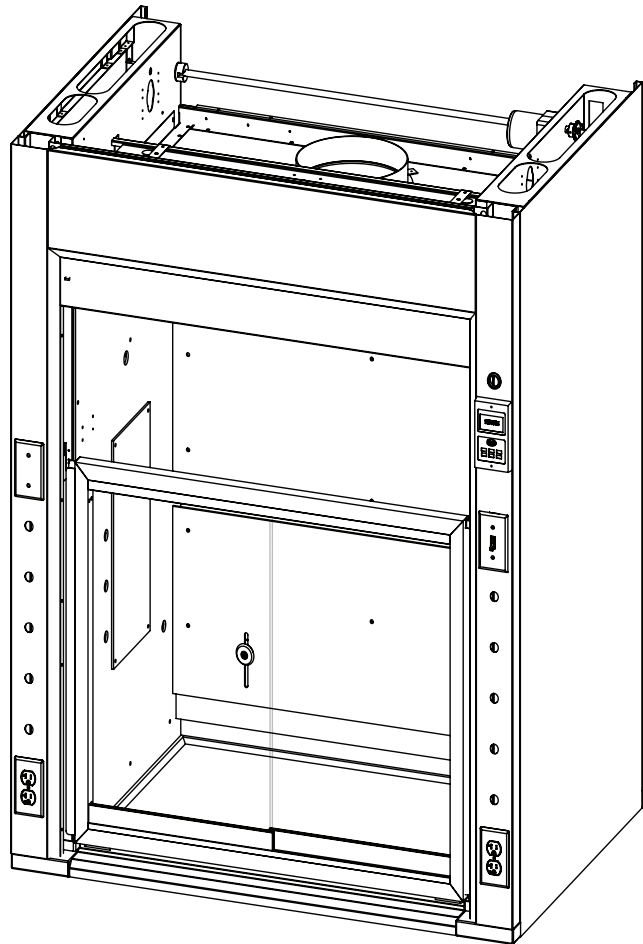

Note:
Counter Top Material:
29"D

F-401 ISOLATOR GEN-5 Isotope Bench Hood Features

- Unsurpassed containment (designed and tested to exceed ASHRAE 110-1995)
- The hood is UL1805/CUL certified listed
- Unique chain driven sash mechanism that comes with a lifetime warranty
- Galvanized steel pan superstructure
- 16.25"H. clear observation glass panel, bypass system
- Stainless steel containment trough
- Offers the best features of both the vertical and horizontal sashes thus allowing flexible interior access while minimizing the sash opening for energy savings
- Integral type stainless steel work top; optional cup sink must be specified
- Vertical sashes provide the greatest hood interior access
- Full view stainless steel combination sash with 28" opening
- Quality engineering ensures years of reliable service



F-401 ISOLATOR GEN-5 Isotope Bench Hood – Ordering Information

F-401 GEN-5 Isotope Bench Hood Air Flow Data

Catalog Number	Duct Diameter	28" Open @ 100 FPM	*14" Open @ 100 FPM
F-401-48G5	1 : 10"	739 CFM @ .32" SP	410 CFM @ .10" SP
F-401-60G5	1 : 12"	972 CFM @ .27" SP	559 CFM @ .09" SP
F-401-72G5	1 : 12"	1205 CFM @ .41" SP	704 CFM @ .14" SP
F-401-96G5	2 : 10"	1672 CFM @ .41" SP	986 CFM @ .14" SP

*50% Open may be achieved two ways:

1. Vertical sash open 14"; horizontal panels closed.
2. Vertical sash closed; horizontal panels full open.

F-401 GEN-5 Isotope Bench Hood Product Numbers

F-401-48G5	Isotope 48"	Combination	(304 Coved)
F-401-60G5	Isotope 60"	Combination	(304 Coved)
F-401-72G5	Isotope 72"	Combination	(304 Coved)
F-401-96G5	Isotope 96"	Combination	(304 Coved)

F-401 GEN-5 Isotope Bench Hood Liner Options

Type 304 stainless steel liner and integral workshop is standard. Please see the Hood Liners section for available options.

F-401 GEN-5 Isotope Bench Hood Electrical Options

Fascia is pre-punched with two electrical cutouts (four cutouts total). Please see the Electrical Fixtures section for available options.

F-401 GEN-5 Isotope Bench Hood Plumbing Fixtures

Fascia is pre-punched with five 3/4" dia. holes to accept rod driven remote fixtures (ten holes total). Please see the Plumbing Fixtures section for available options.

F-401 GEN-5 Isotope Bench Hood Fume Hood Accessories

Please see the Fume Hood Accessories section for available options.

F-401 ISOLATOR GEN-5 Isotope Bench Hood – Product Dimensions

Each 5" wide fascia pre-punched with two electrical cutouts and five, 3/4" diameter holes for rod driven remote fixtures.
(Total: 4 electrical cutouts; 10, pre-punched holes, per hood) 10 hole plugs provided.

Counter Top Depth: 29" D. The 6" x 3" cup sinks shown are optional.

Outside, Overall Height: 57-1/8"

Outside, Overall Depth: 32-15/16"

Equipped with 10" or 12" diameter, stainless steel duct collar.

48" Clear Interior Height. Height from bottom of hood to top of duct collar is 51-1/2".

F-401-48G5 - 48" Isotope BENCH FUME HOOD

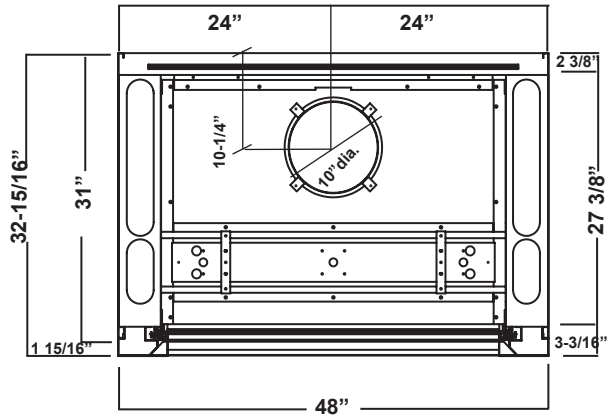
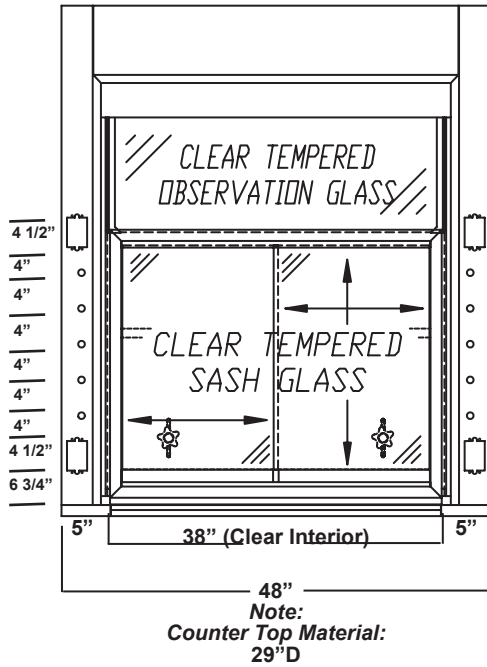

F-401-60G5 - 60" Isotope BENCH FUME HOOD

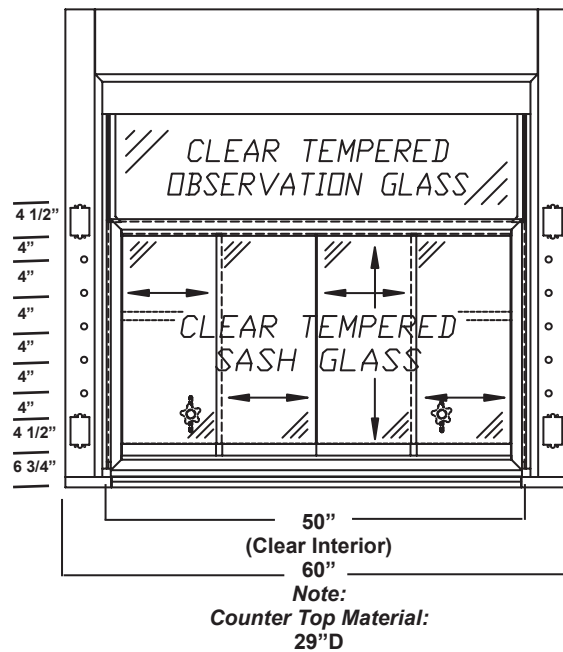
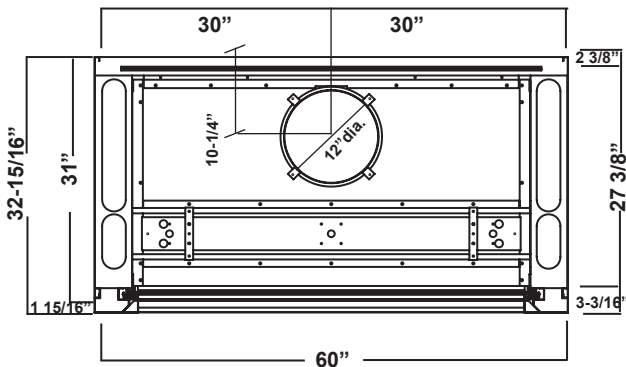

F-401 ISOLATOR GEN-5 Isotope Bench Hood – Product Dimensions

Each 5" wide fascia pre-punched with two electrical cutouts and five, 3/4" diameter holes for rod driven remote fixtures.
 (Total: 4 electrical cutouts; 10, pre-punched holes, per hood) 10 hole plugs provided.
 Counter Top Depth: 29" D. The 6" x 3" cup sinks shown are optional.
 Outside, Overall Height: 57-1/8"
 Outside, Overall Depth: 32-15/16"
 Equipped with 10" or 12" diameter, stainless steel duct collar.
 24" Clear Interior Depth
 48" Clear Interior Height. Height from bottom of hood to top of duct collar is 51-1/2".

F-401-72G5 - 72" Isotope BENCH FUME HOOD

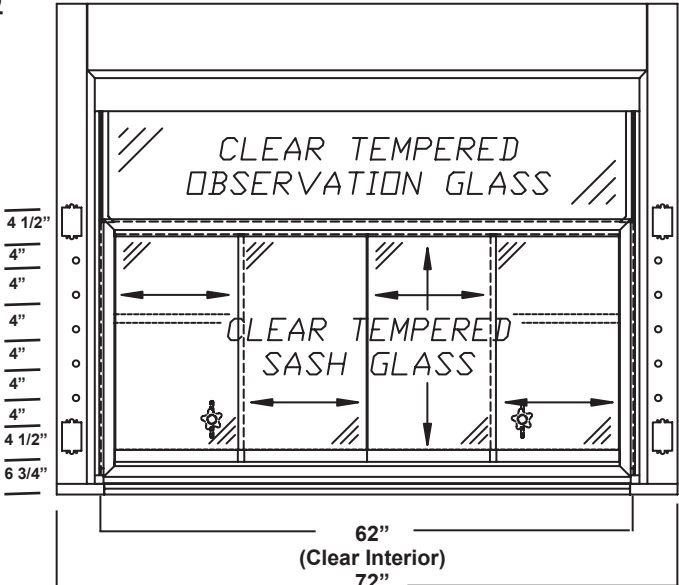
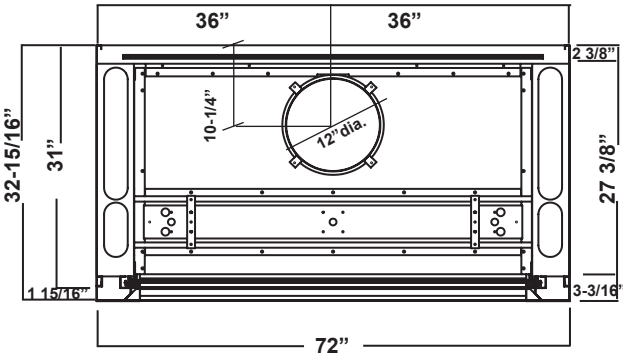

Note:
Counter Top Material:
29"D

F-401-96G5 - 96" Isotope BENCH FUME HOOD

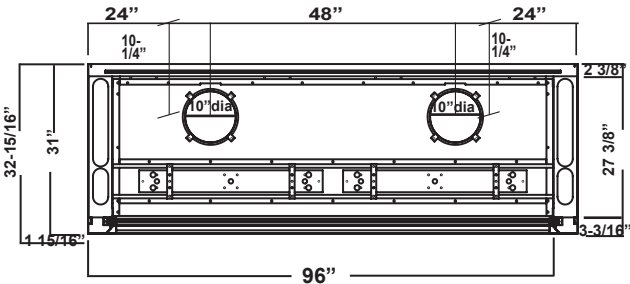
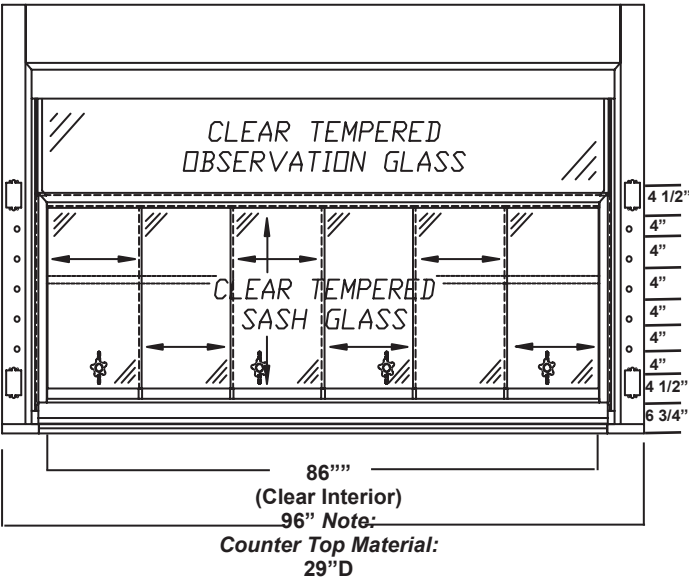

Note:
Counter Top Material:
29"D

F-401 ISOLATOR GEN-5 Bench Fume Hood – Product Dimensions

F-401-G5 - Isotope BENCH FUME HOOD SIDE VIEWS, OPEN & CLOSED

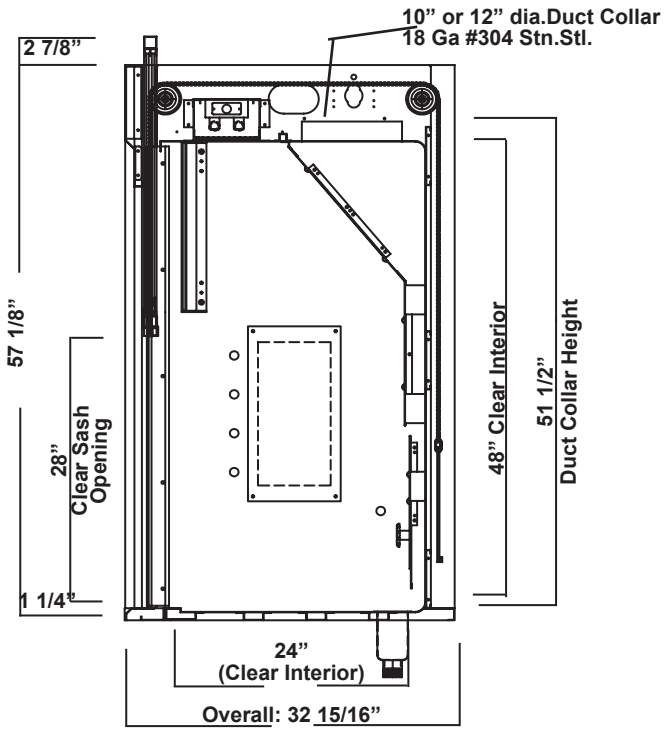

Note:
Counter Top Material:
29"D

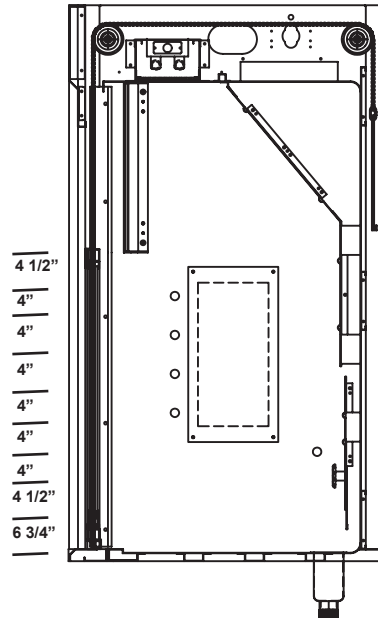

INTENTIONALLY BLANK



F-403 ISOLATOR GEN-5 Isotope Bench Hood – Framed Vertical Sash

The ISOLATOR GENERATION-5 Isotope fume hood with a framed vertical sash, designed for use with radioisotope or biological work, features a type 304 or 316 stainless steel liner and baffles with coving on all containment chamber corners to facilitate cleaning. The integral work surface is reinforced to carry up to 200 lbs./sq. ft. of lead shielding or other overburden. The ISOLATOR GEN-5 design and construction enhances its value by providing:

- Unparalleled user safety
- Full hood access for easy set ups
- Years of maintenance free service
- Unmatched ease of use
- Unique design qualities for unlimited customization possibilities
- Field conversion between Constant Air Volume (CAV) and Variable Air Volume (VAV)

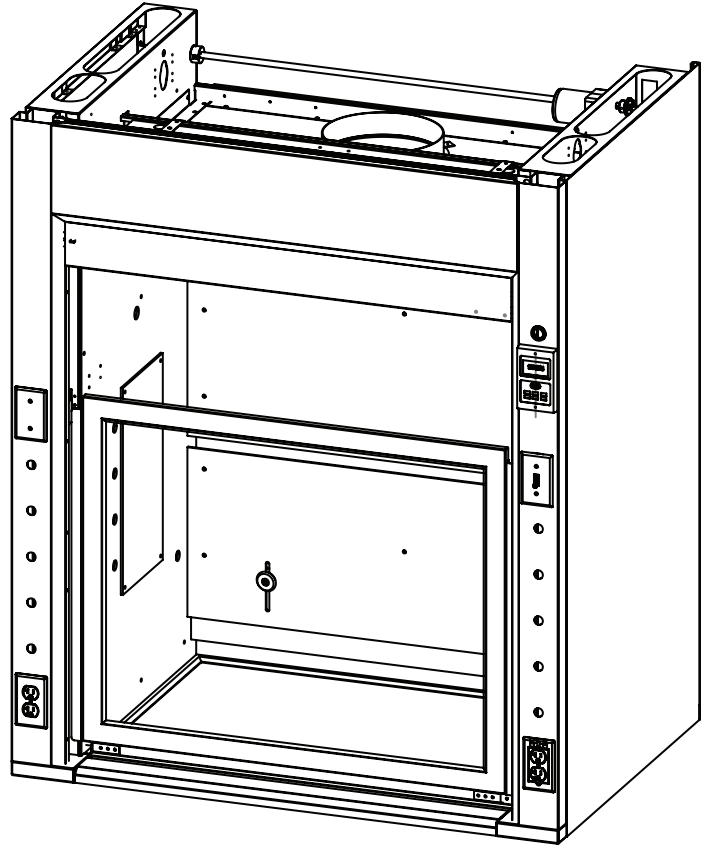

F-403 ISOLATOR GEN-5 ISOTOPE BENCH FUME HOOD - PRODUCT FEATURES

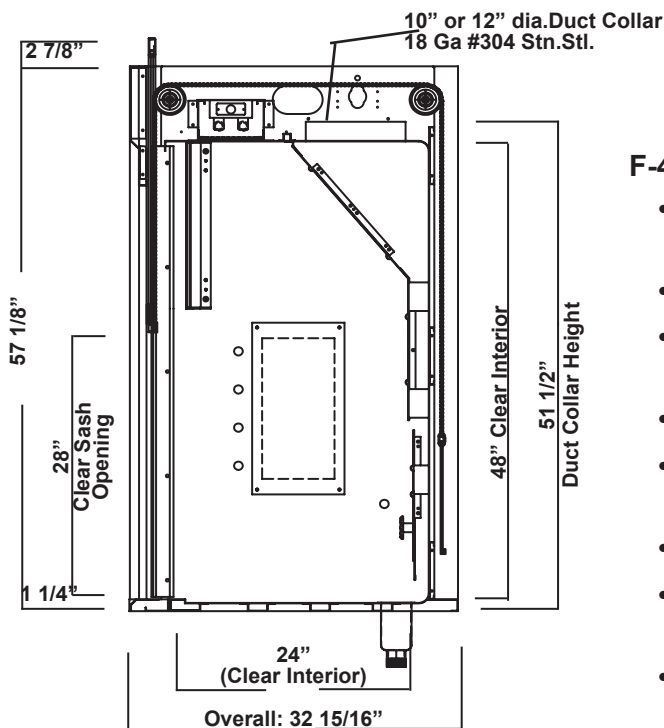

F-403 ISOLATOR GEN-5 Isotope Bench Hood Features

- Unsurpassed containment (designed and tested to exceed ASHRAE 110-1995)
- The hood is UL1805/CUL certified listed
- Unique chain driven sash mechanism that comes with a lifetime warranty
- Galvanized steel pan superstructure
- 16.25"H. clear observation glass panel, bypass system
- Stainless steel flush sill containment trough
- Integral type 304 stainless steel work top; optional cup sink must be specified.
- Vertical sashes provide the greatest hood interior access
- Full view framed sash with 28" opening
- Quality engineering ensures years of reliable service



F-403 ISOLATOR GEN-5 Isotope Bench Hood - Ordering Information

F-403 GEN-5 Isotope Bench Hood Air Flow Data

Catalog Number	Duct Diameter	28" Open @ 100 FPM	18" Open @ 100 FPM
F-403-36G5	1 : 10"	505 CFM @ .15" SP	325 CFM @ .06" SP
F-403-48G5	1 : 10"	739 CFM @ .32" SP	475 CFM @ .13" SP
F-403-60G5	1 : 12"	972 CFM @ .27" SP	625 CFM @ .11" SP
F-403-72G5	1 : 12"	1205 CFM @ .41" SP	775 CFM @ .17" SP
F-403-96G5	2 : 10"	1672 CFM @ .41" SP	1075 CFM @ .17" SP

F-403 GEN-5 Isotope Bench Hood Product Numbers

F-403-36G5	Isotope 36"	Framed Sash	(304 Coved)
F-403-48G5	Isotope 48"	Framed Sash	(304 Coved)
F-403-60G5	Isotope 60"	Framed Sash	(304 Coved)
F-403-72G5	Isotope 72"	Framed Sash	(304 Coved)
F-403-96G5	Isotope 96"	Framed Sash	(304 Coved)

F-403 GEN-5 Isotope Bench Hood Liner Options

Type 304 stainless steel liner and integral workshop is standard. Please see the Hood Liners section for available options.

F-403 GEN-5 Isotope Bench Hood Electrical Options

Fascia is pre-punched with two electrical cutouts (four cutouts total). Please see the Electrical Fixtures section for available options.

F-403 GEN-5 Isotope Bench Hood Plumbing Fixtures

Fascia is pre-punched with five 3/4" dia. holes to accept rod driven remote fixtures (ten holes total). Please see the Plumbing Fixtures section for available options.

F-403 GEN-5 Isotope Bench Hood Fume Hood Accessories

Please see the Fume Hood Accessories section for available options.

F-403 ISOLATOR GEN-5 Isotope Bench Hood – Product Dimensions

Each 5" wide fascia pre-punched with two electrical cutouts and five, 3/4" diameter holes for rod driven remote fixtures.
(Total: 4 electrical cutouts; 10, pre-punched holes, per hood) 10 hole plugs provided.

Counter Top Depth: 29" D. The 6" x 3" cup sinks shown are optional.

Outside, Overall Height: 57-1/8"

Outside, Overall Depth: 32-15/16"

Equipped with 10" or 12" diameter, stainless steel duct collar.

24" Clear Interior Depth

48" Clear Interior Height. Height from bottom of hood to top of duct collar is 51-1/2".

F-403-36G5 - 36" Isotope BENCH FUME HOOD

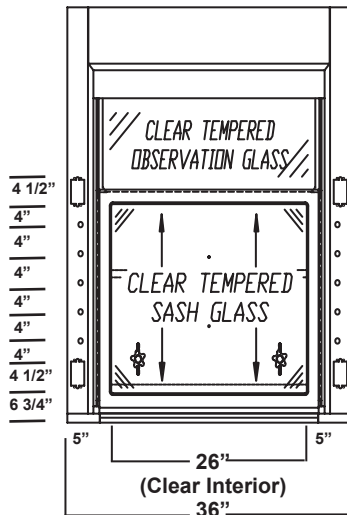

Note:
Counter Top Material:
29"D

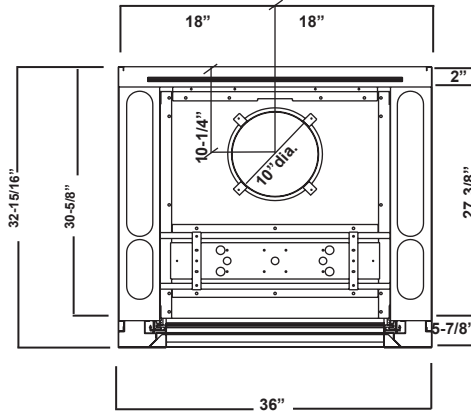

F-403-48G5 - 48" Isotope BENCH FUME HOOD

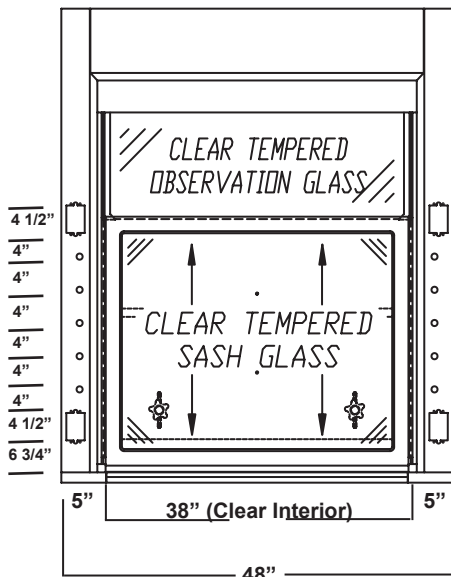

Note:
Counter Top Material:
29"D

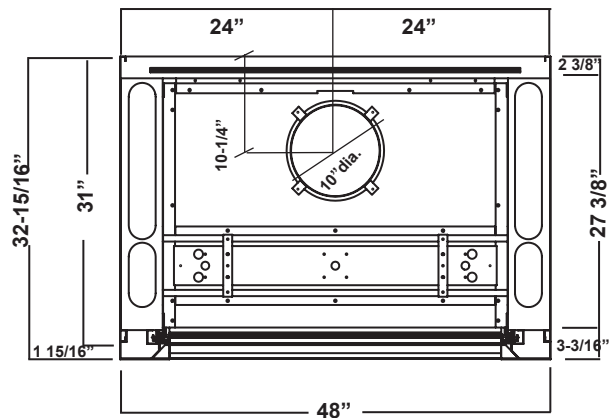

F-403 ISOLATOR GEN-5 Isotope Bench Hood – Product Dimensions

Each 5" wide fascia pre-punched with two electrical cutouts and five, 3/4" diameter holes for rod driven remote fixtures.
(Total: 4 electrical cutouts; 10, pre-punched holes, per hood) 10 hole plugs provided.

(Total: 4 electrical cutouts; 10, pre-punched holes, per hood) 10 hole plugs provided.

Counter Top Depth: 29"D. The 6" x 3" cup sinks shown are optional.

Outside, Overall Height: 57-1/8"

24" Clear Interior Depth

Outside, Overall Depth: 32-15/16"

Equipped with 10" or 12" diameter, stainless steel duct collar.

48" Clear Interior Height. Height from bottom of hood to top of duct collar is 51-1/2".

F-403-60G5 - 60"Isotope BENCH FUME HOOD

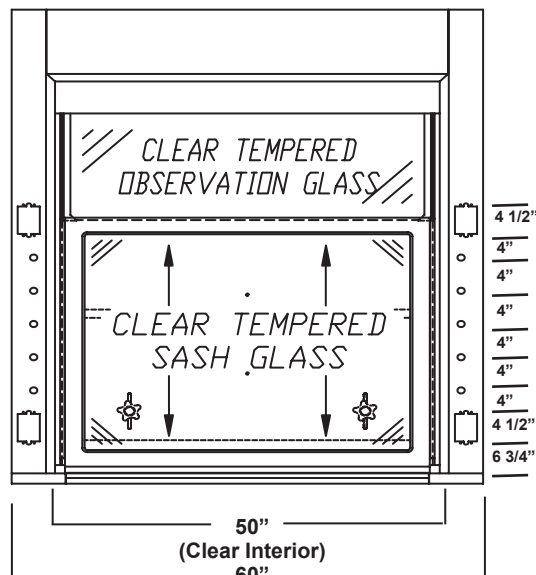
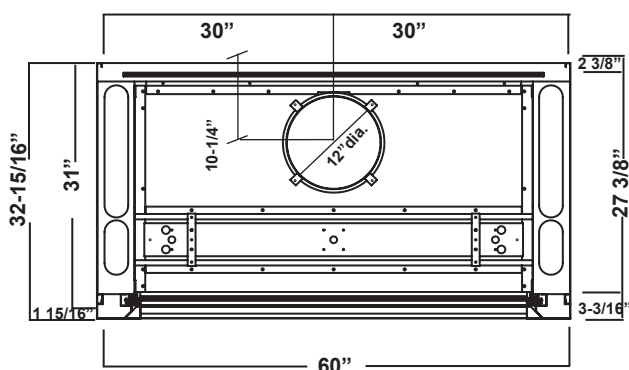

Note:
Counter Top Material:
29"D

F-403-72G5 - 72" Isotope BENCH FUME HOOD

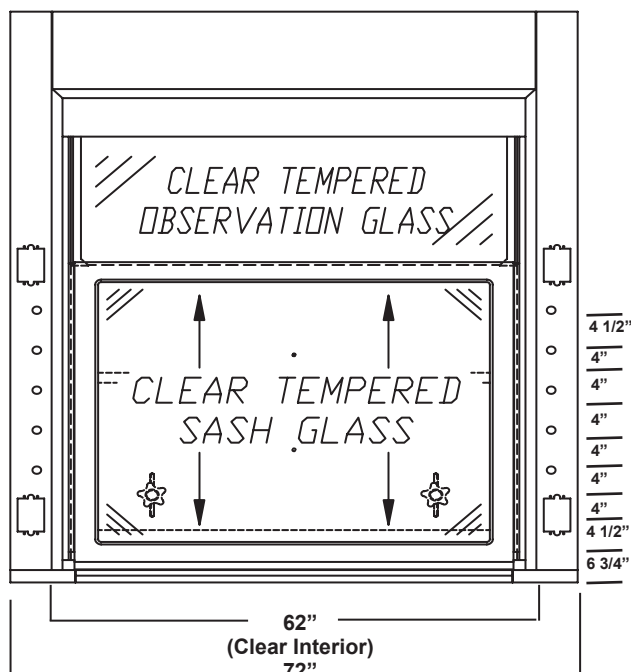
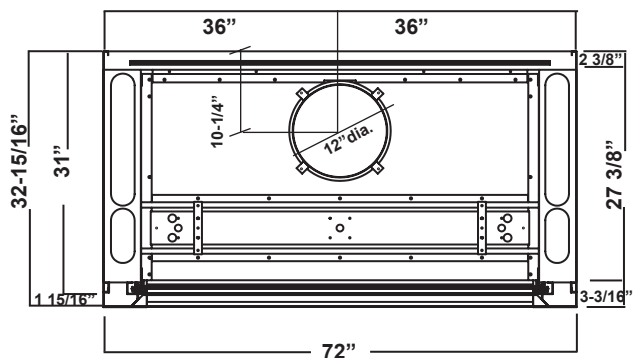

Note:
Counter Top Material:
29"D

F-403 ISOLATOR GEN-5 BENCH FUME HOOD - PRODUCT DIMENSIONS

48" Clear Interior Height. Height from bottom of hood to top of duct collar is 51-1/2".

Technical drawing of the 600 Series 24 inch wide table. The top view shows a rectangular table with a width of 24 inches and a length of 48 inches. The distance between the centers of the two circular cutouts is 24 inches. The cutouts have a diameter of 10 inches. The distance from the left edge to the center of the first cutout is 10-1/4 inches, and the distance from the right edge to the center of the second cutout is 10-1/4 inches. The side view shows a table with a height of 32-15/16 inches. The distance from the bottom edge to the top edge of the cutouts is 31 inches. The distance from the bottom edge to the bottom edge of the cutouts is 4-15/16 inches. The distance from the bottom edge to the top edge of the table is 27 3/8 inches. The distance from the bottom edge to the top edge of the table is 3-3/16 inches. The bottom view shows a rectangular table with a width of 24 inches and a length of 48 inches. The distance between the centers of the two circular cutouts is 24 inches. The cutouts have a diameter of 10 inches. The distance from the left edge to the center of the first cutout is 10-1/4 inches, and the distance from the right edge to the center of the second cutout is 10-1/4 inches. The bottom view shows a rectangular table with a width of 24 inches and a length of 48 inches. The distance between the centers of the two circular cutouts is 24 inches. The cutouts have a diameter of 10 inches. The distance from the left edge to the center of the first cutout is 10-1/4 inches, and the distance from the right edge to the center of the second cutout is 10-1/4 inches.

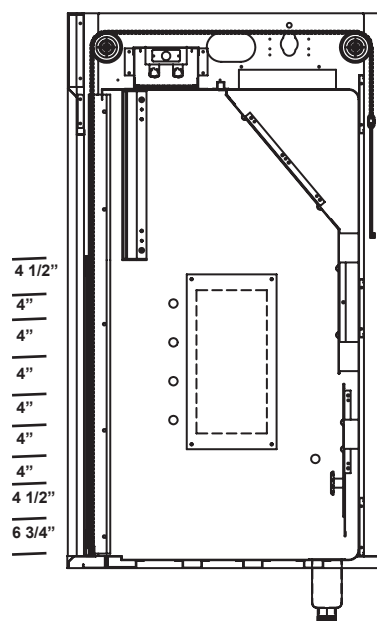
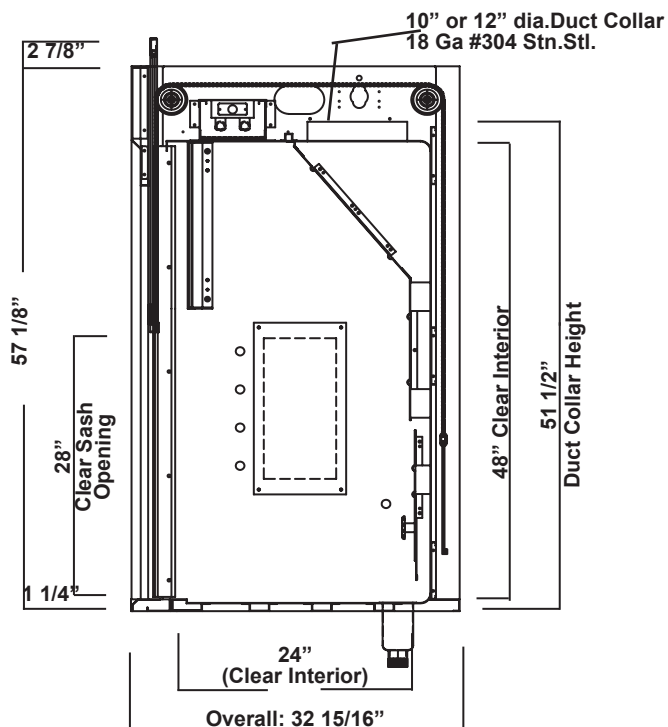

Note:
Counter Top Material:
29"D

INTENTIONALLY BLANK



F-500 ISOLATOR GEN-5 Perchloric Acid Bench – Frameless Vertical Sash

The ISOLATOR GENERATION-5 perchloric acid fume hood with a frameless vertical sash features a type 316 stainless steel liner and baffles with coving on all containment chamber corners. Also included is a wash down system designed to carry away potentially explosive perchloric acid salts through a 4" to 5 3/4" sloped trench with a single drain. The ISOLATOR GEN-5 design and construction enhances its value by providing:

- Unparalleled user safety
- Full hood access for easy set ups
- Years of maintenance free service
- Unmatched ease of use
- Unique design qualities for unlimited customization possibilities
- Field conversion between Constant Air Volume (CAV) and Variable Air Volume (VAV)

***SPECIAL NOTES:** Perchloric hoods attached to long runs of duct work require solenoid activated, electronically sequenced spray head activation to assure the flow rate into the fume hood wash down trench never exceeds the 45 GPM overflow rate. Any blower purchased to exhaust this hood should have internal wash down capability and be lubricated with fluorocarbon grease and oil.

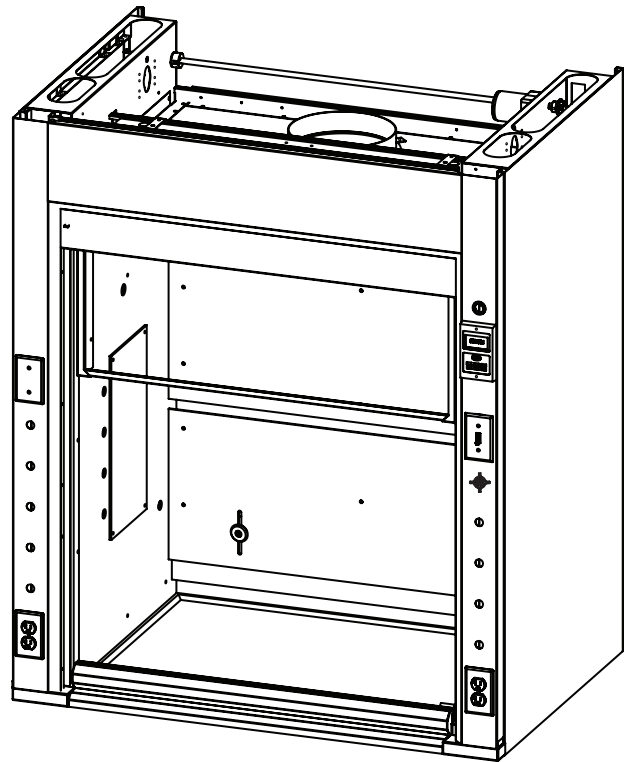

F-500 ISOLATOR GEN-5 PERCHLORIC ACID BENCH FUME HOOD - PRODUCT FEATURES

F-500 ISOLATOR GEN-5 Perchloric Acid Bench Features

- Unsurpassed containment (designed and tested to exceed ASHRAE 110-1995)
- The hood is UL1805/CUL certified listed
- Unique chain driven sash mechanism that comes with a lifetime warranty
- Galvanized steel pan superstructure
- 16.25"H. clear observation glass panel, bypass system
- 316 Stainless steel flush sill containment trough
- Integral type 316 stainless steel work top with trench drain and wash down setup
- A perforated PVC wash down bar, water valve and remote knob assembly
- Vertical sashes provide the greatest hood interior access
- Full view frameless sash with 28" opening
- Quality engineering ensures years of reliable service

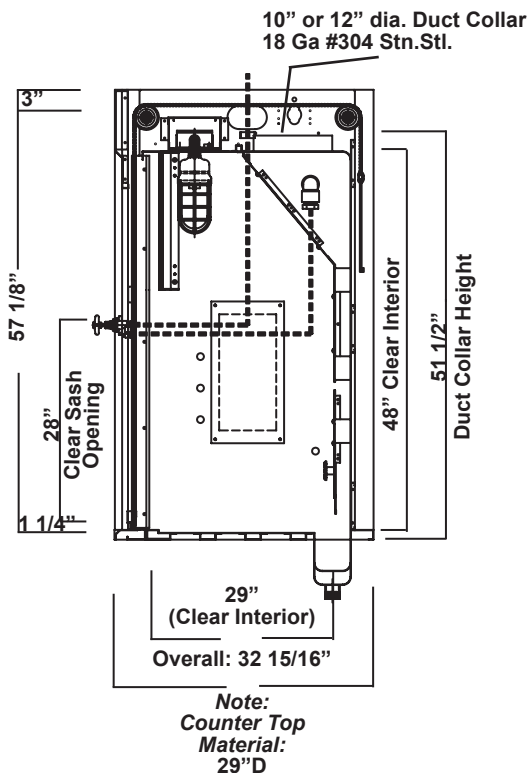

F-500 ISOLATOR GEN-5 Perchloric Acid Bench – Ordering Information

F-500 ISOLATOR GEN-5 Perchloric Acid Bench Air Flow Data

Catalog Number	Duct Diameter	28" Open @ 100 FPM	18" Open @ 100 FPM
F-500-36G5	1 : 10"	505 CFM @ .15" SP	325 CFM @ .06" SP
F-500-48G5	1 : 10"	739 CFM @ .32" SP	475 CFM @ .13" SP
F-500-60G5	1 : 12"	972 CFM @ .27" SP	625 CFM @ .11" SP
F-500-72G5	1 : 12"	1205 CFM @ .41" SP	775 CFM @ .17" SP
F-500-96G5	2 : 10"	1672 CFM @ .41" SP	1075 CFM @ .17" SP

F-500 GEN-5 Perchloric Acid Bench Product Numbers

F-500-36G5	Perchloric 36"	Frameless with washdown
F-500-48G5	Perchloric 48"	Frameless with washdown
F-500-60G5	Perchloric 60"	Frameless with washdown
F-500-72G5	Perchloric 72"	Frameless with washdown
F-500-96G5	Perchloric 96"	Frameless with washdown

F-500 GEN-5 Perchloric Acid Bench Liner Options

The liner material is 16 gauge type 316 stainless steel liner with coved corners.

F-500 GEN-5 Perchloric Acid Bench Electrical Options

Fascia is pre-punched with two electrical cutouts (four cutouts total). Please see the Electrical Fixtures section for available options.

F-500 GEN-5 Perchloric Acid Bench Plumbing Fixtures

Fascia is pre-punched with five 3/4" dia. holes to accept rod driven remote fixtures (ten holes total). Please see the Plumbing Fixtures section for available options.

Note: Valves are pre-piped to the top of the fume hood.

F-500 GEN-5 Perchloric Acid Bench Fume Hood Accessories

Please see the Fume Hood Accessories section for available options.

F-500 ISOLATOR GEN-5 Perchloric Acid Bench – Product Dimensions

Each 5" wide fascia pre-punched with two electrical cutouts and five, 3/4" diameter holes for rod driven remote fixtures.

(Total: 4 electrical cutouts; 10, pre-punched holes, per hood)

Top right hole is plumbed with wash down control handle; 9 hole plugs provided.

Counter Top Depth: 29" D.

Outside, Overall Height: 57-1/8"

24" Clear Interior Depth

Outside, Overall Depth: 32-15/16"

Equipped with 10" or 12" diameter, stainless steel duct collar.

48" Clear Interior Height. Height from bottom of hood to top of duct collar is 51-1/2".

F-500-36G5 - 36" Perchloric Acid BENCH FUME HOOD

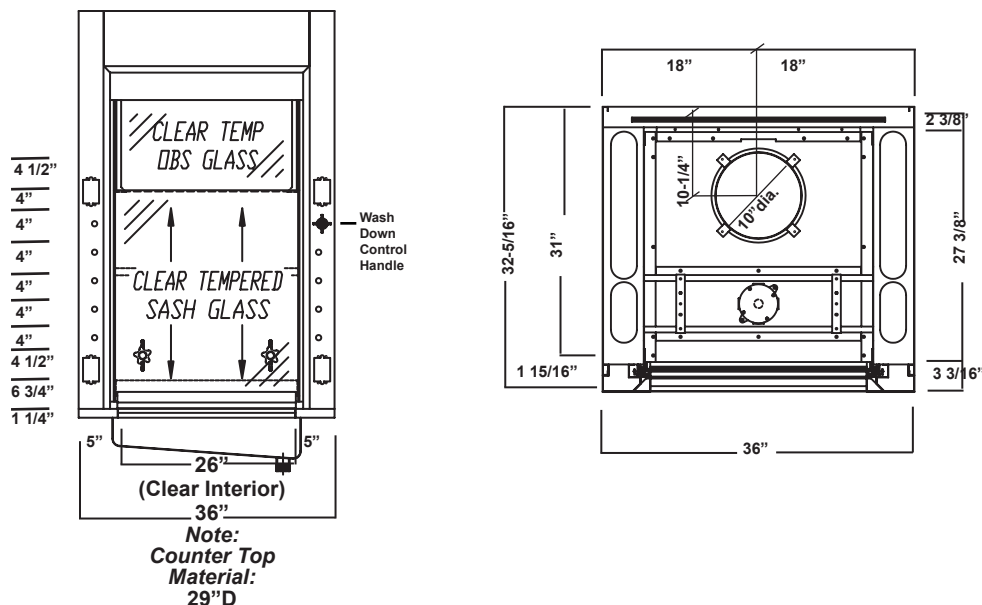

F-500-48G5 - 48" Perchloric Acid BENCH FUME HOOD

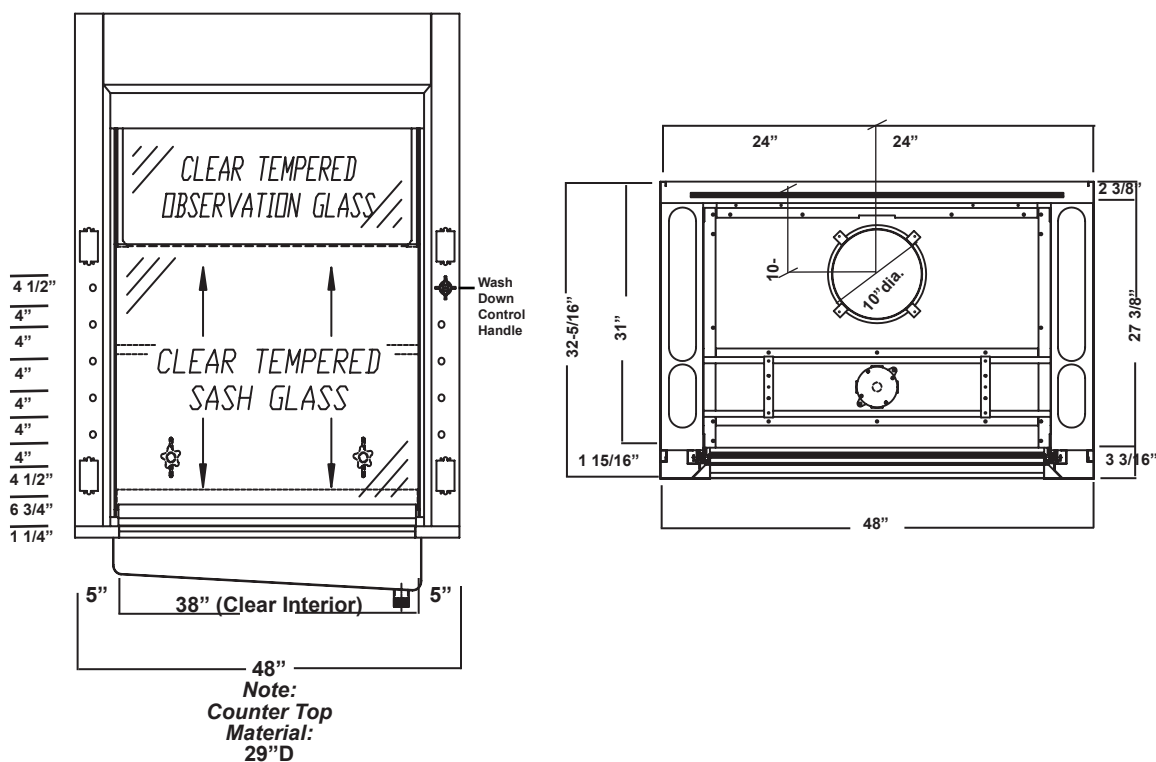

F-500 ISOLATOR GEN-5 Perchloric Acid Bench – Product Dimensions

Each 5" wide fascia pre-punched with two electrical cutouts and five, 3/4" diameter holes for rod driven remote fixtures.
 (Total: 4 electrical cutouts; 10, pre-punched holes, per hood)
 Top right hole is plumbed with wash down control handle; 9 hole plugs provided.
 Counter Top Depth: 29"
 Outside, Overall Height: 57-1/8"
 Outside, Overall Depth: 32-15/16"
 Equipped with 10" or 12" diameter, stainless steel duct collar.
 24" Clear Interior Depth.
 48" Clear Interior Height. Height from bottom of hood to top of duct collar is 51-1/2".

F-500-60G5 - 60" Perchloric Acid BENCH FUME HOOD

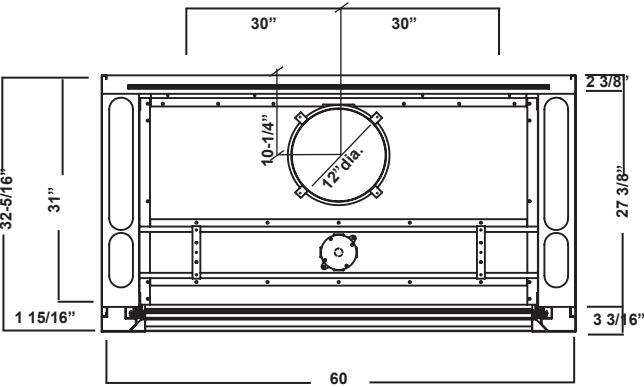
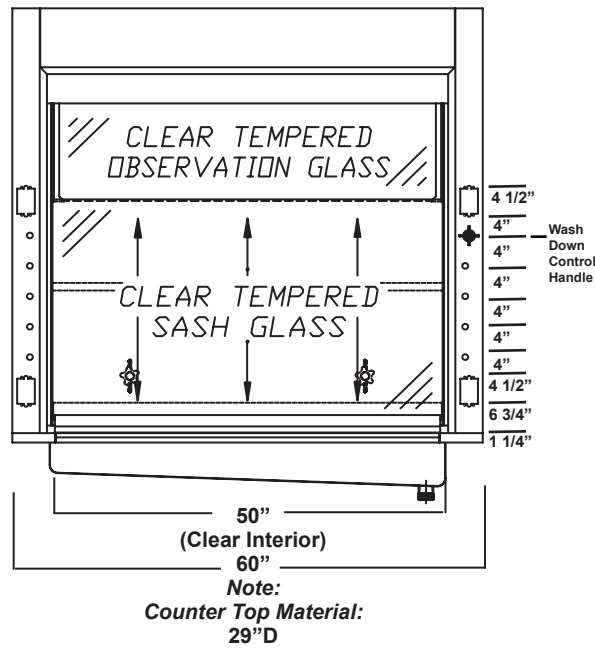

F-500-72G5 - 72" Perchloric Acid BENCH FUME HOOD

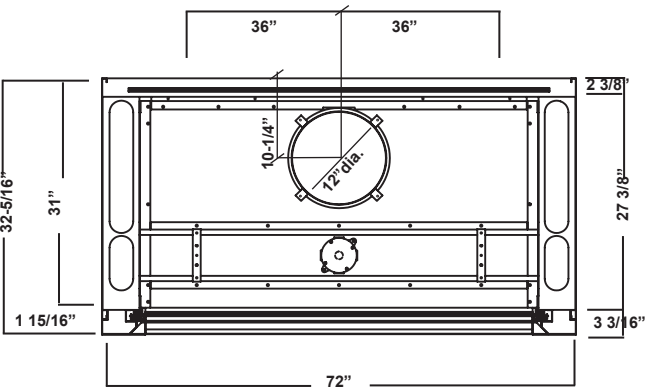
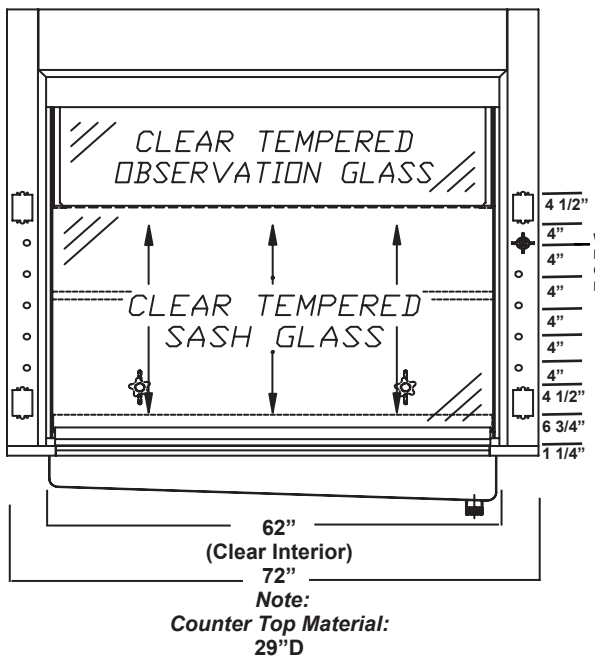

F-500 ISOLATOR GEN-5 Perchloric Acid Bench – Product Dimensions

Each 5" wide fascia pre-punched with two electrical cutouts and five, 3/4" diameter holes for rod driven remote fixtures.

(Total: 4 electrical cutouts; 10, pre-punched holes, per hood)

Top right hole is plumbed with wash down control handle; 9 hole plugs provided.

Counter Top Depth: 29" D.

Outside, Overall Height: 57-1/8"

Outside, Overall Depth: 32-15/16"

Equipped with 10" or 12" diameter, stainless steel duct collar.

24" Clear Interior Depth

48" Clear Interior Height. Height from bottom of hood to top of duct collar is 51-1/2".

F-500-96G5 - 96" Perchloric Acid BENCH FUME HOOD

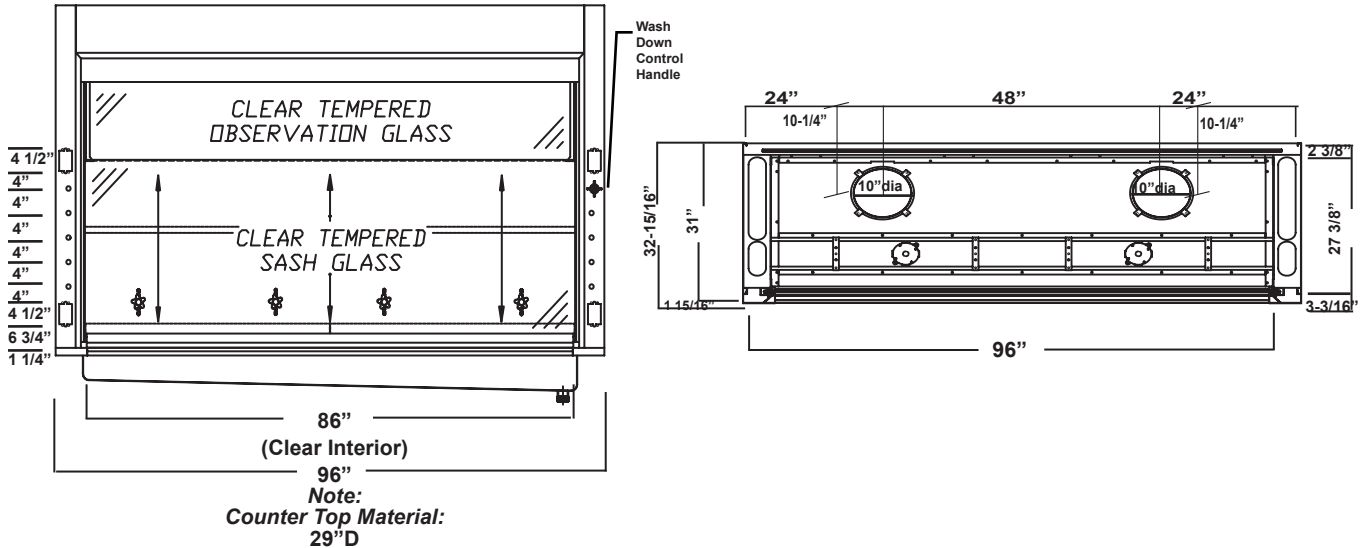

F-500-G5 - BENCH FUME HOOD SIDE VIEWS, OPEN & CLOSED

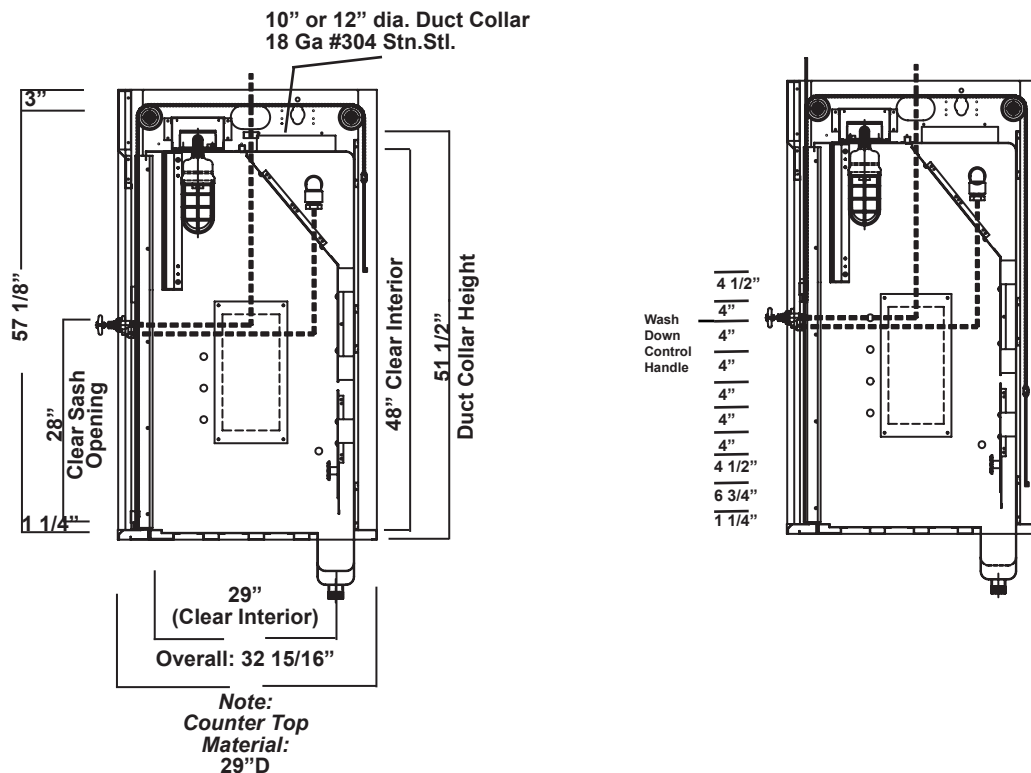

INTENTIONALLY BLANK

F-503 ISOLATOR GEN-5 Perchloric Acid Bench – Framed Vertical Sash

The ISOLATOR GENERATION-5 perchloric acid fume hood with a framed vertical sash features a type 316 stainless steel liner and baffles with coving on all containment chamber corners. Also included is a wash down system designed to carry away potentially explosive perchloric acid salts through a 4" to 5 3/4" sloped trench with a single drain. The ISOLATOR's design and construction enhances its value by providing:

- Unparalleled user safety
- Full hood access for easy set ups
- Years of maintenance free service
- Unmatched ease of use
- Unique design qualities for unlimited customization possibilities
- Field conversion between Constant Air Volume (CAV) and Variable Air Volume (VAV)

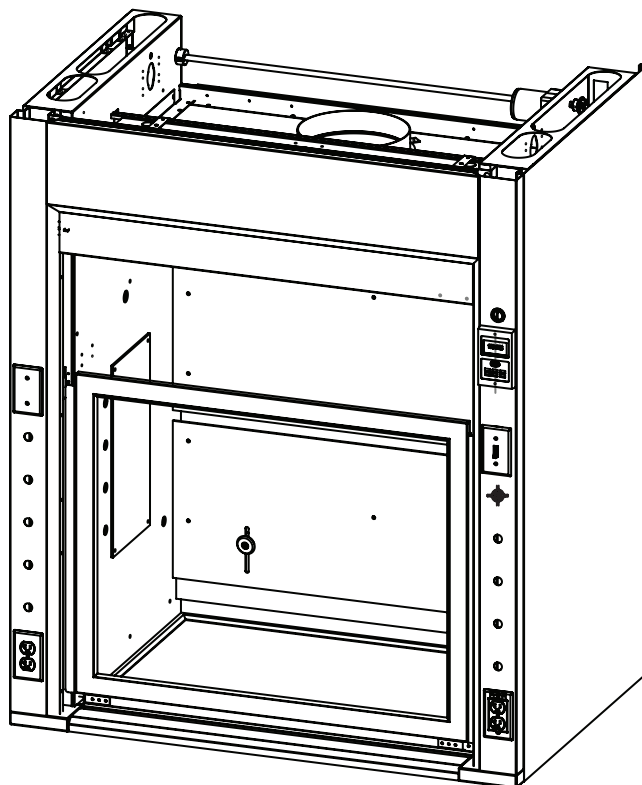

***SPECIAL NOTES:** Perchloric hoods attached to long runs of duct work require solenoid activated, electronically sequenced spray head activation to assure the flow rate into the fume hood wash down trench never exceeds the 45 GPM overflow rate. Any blower purchased to exhaust this hood should have internal wash down capability and be lubricated with fluorocarbon grease and oil.

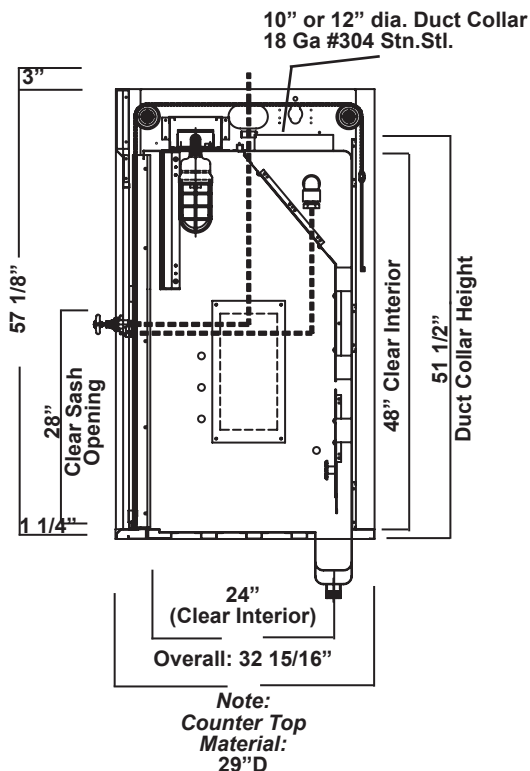

F-503 ISOLATOR GEN-5 Perchloric Acid Bench Features

- Unsurpassed containment (designed and tested to exceed ASHRAE 110-1995)
- The hood is UL1805/CUL certified listed
- Unique chain driven sash mechanism that comes with a lifetime warranty
- Galvanized steel pan superstructure
- 16.25"H. clear observation glass panel, bypass system
- 316 Stainless steel flush sill containment trough
- Integral type 316 stainless steel work top with trench drain and wash down setup
- A perforated PVC wash down bar, water valve and remote knob assembly
- Vertical sashes provide the greatest hood interior access
- Full view framed sash with 28" opening
- Quality engineering ensures years of reliable service



F-503 ISOLATOR GEN-5 Perchloric Acid Bench – Ordering Information

F-503 ISOLATOR GEN-5 Perchloric Acid Bench Air Flow Data

Catalog Number	Duct Diameter	28" Open @ 100 FPM	18" Open @ 100 FPM
F-503-36G5	1 : 10"	505 CFM @ .15" SP	325 CFM @ .06" SP
F-503-48G5	1 : 10"	739 CFM @ .32" SP	475 CFM @ .13" SP
F-503-60G5	1 : 12"	972 CFM @ .27" SP	625 CFM @ .11" SP
F-503-72G5	1 : 12"	1205 CFM @ .41" SP	775 CFM @ .17" SP
F-503-96G5	2 : 10"	1672 CFM @ .41" SP	1075 CFM @ .17" SP

F-503 GEN-5 Perchloric Acid Bench Product Numbers

F-503-36G5	Perchloric 36"	Framed with wash down
F-503-48G5	Perchloric 48"	Framed with wash down
F-503-60G5	Perchloric 60"	Framed with wash down
F-503-72G5	Perchloric 72"	Framed with wash down
F-503-96G5	Perchloric 96"	Framed with wash down

F-503 GEN-5 Perchloric Acid Bench Liner Options

The liner material is 16 gauge type 316 stainless steel liner with coved corners.

F-503 GEN-5 Perchloric Acid Bench Electrical Options

Fascia is pre-punched with two electrical cutouts (four cutouts total). Please see the Electrical Fixtures section for available options.

F-503 GEN-5 Perchloric Acid Bench Plumbing Fixtures

Fascia is pre-punched with five 3/4" dia. holes to accept rod driven remote fixtures (ten holes total). Please see the Plumbing Fixtures section for available options.

Note: Valves are pre-piped to the top of the fume hood.

F-503 GEN-5 Perchloric Acid Bench Fume Hood Accessories

Please see the Fume Hood Accessories section for available options.

F-503 ISOLATOR GEN-5 Perchloric Acid Bench – Product Dimensions

Each 5" wide fascia pre-punched with two electrical cutouts and five, 3/4" diameter holes for rod driven remote fixtures.

(Total: 4 electrical cutouts; 10, pre-punched holes, per hood)

Top right hole is plumbed with wash down control handle; 9 hole plugs provided.

Counter Top Depth: 29" D.

Outside, Overall Height: 57-1/8"

24" Clear Interior Depth

Outside, Overall Depth: 32-15/16"

Equipped with 10" or 12" diameter, stainless steel duct collar.

48" Clear Interior Height. Height from bottom of hood to top of duct collar is 51-1/2".

F-503-36G5 - 36" Perchloric Acid BENCH FUME HOOD

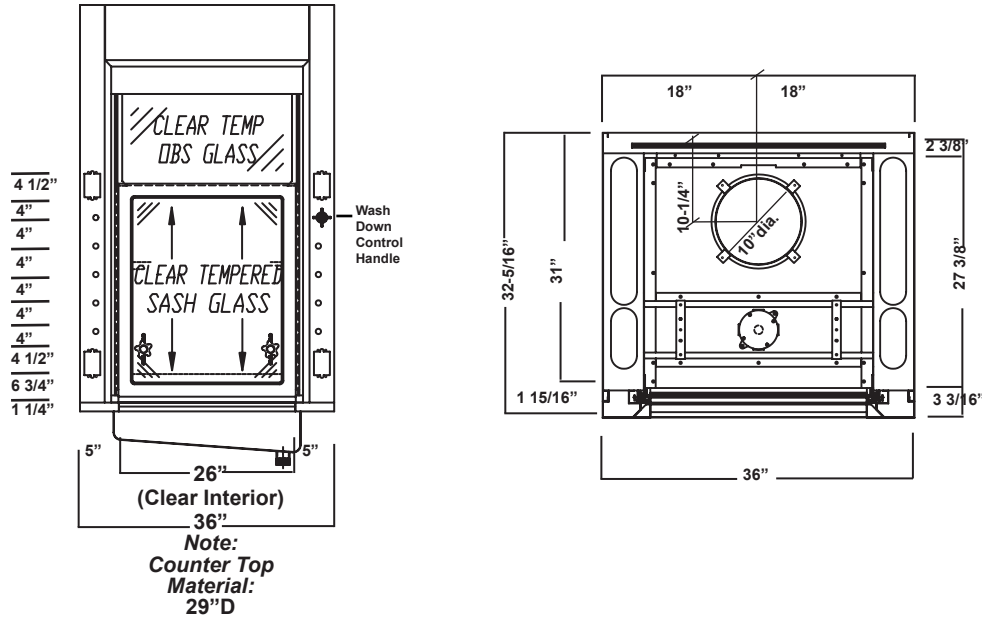

F-503-48G5 - 48" Perchloric Acid BENCH FUME HOOD

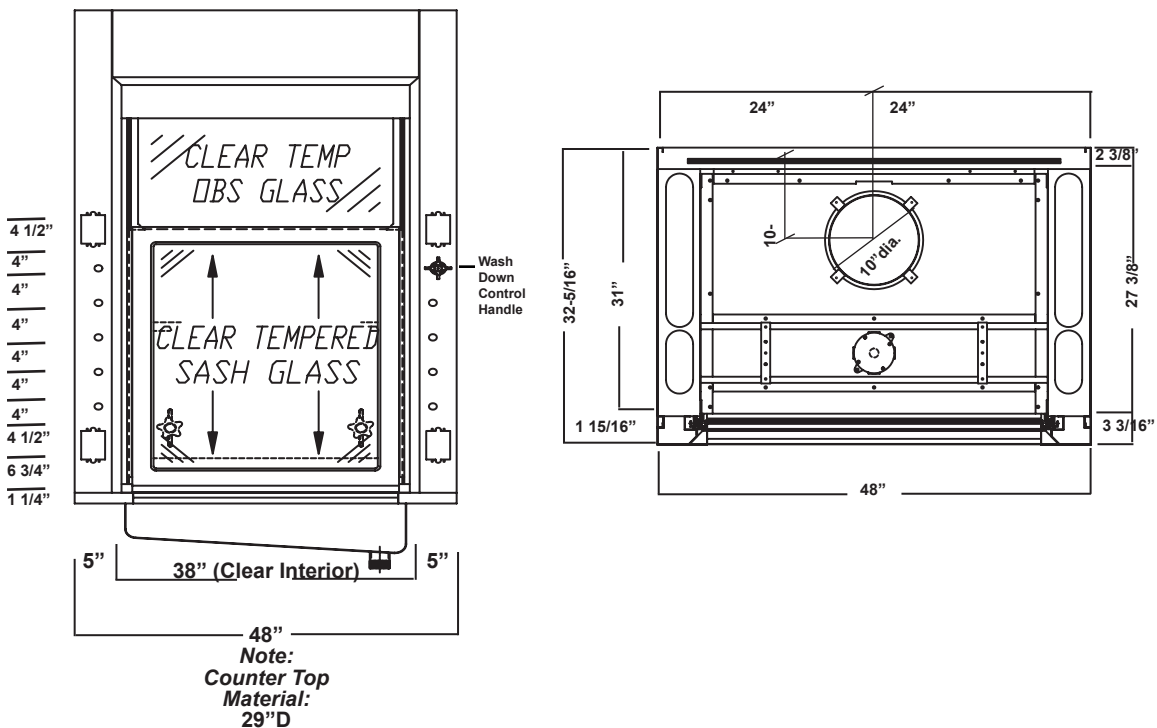

F-503 ISOLATOR GEN-5 Perchloric Acid Bench – Product Dimensions

Each 5" wide fascia pre-punched with two electrical cutouts and five, 3/4" diameter holes for rod driven remote fixtures.

(Total: 4 electrical cutouts; 10, pre-punched holes, per hood)

Top right hole is plumbed with wash down control handle; 9 hole plugs provided.

Counter Top Depth: 29" D.

Outside, Overall Height: 57-1/8"

24" Clear Interior Depth

Outside, Overall Depth: 32-15/16"

Equipped with 10" or 12" diameter, stainless steel duct collar.

48" Clear Interior Height. Height from bottom of hood to top of duct collar is 51-1/2".

F-503-60G5 - 60" Perchloric Acid BENCH FUME HOOD

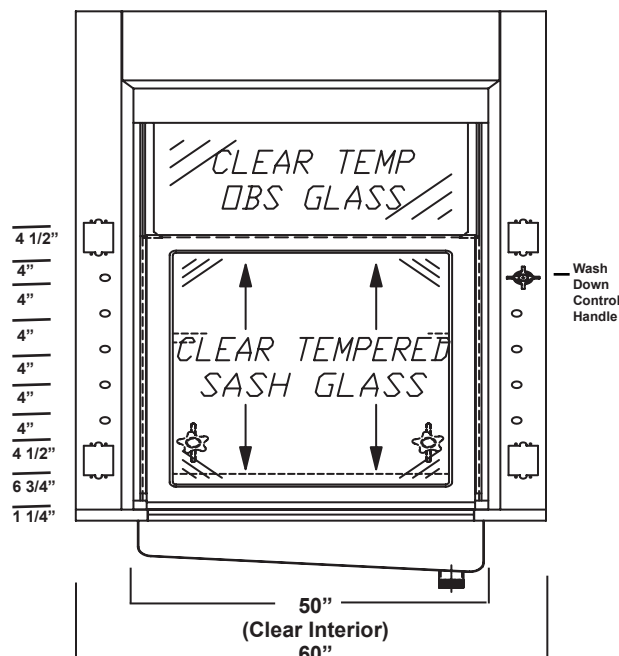

Note:
Counter Top Material:
29"D

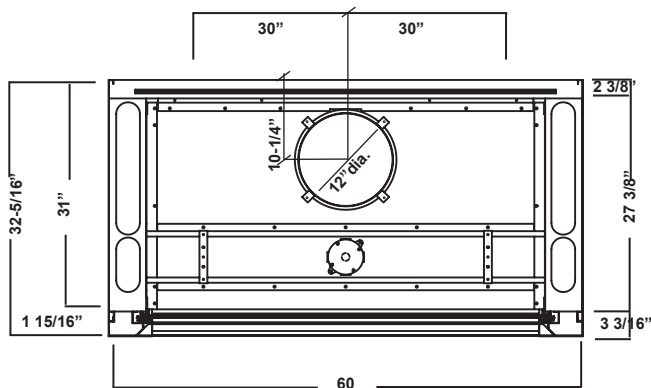

F-503-72G5 - 72" Perchloric Acid BENCH FUME HOOD

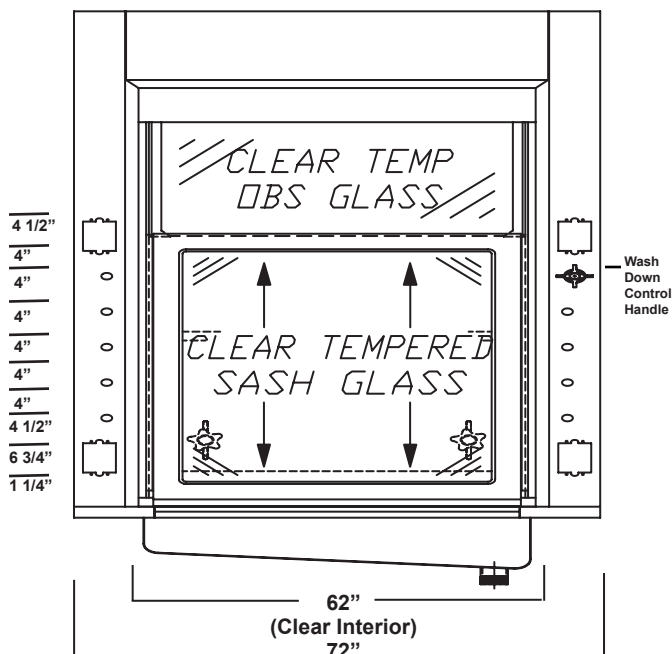

Note:
Counter Top Material:
29"D

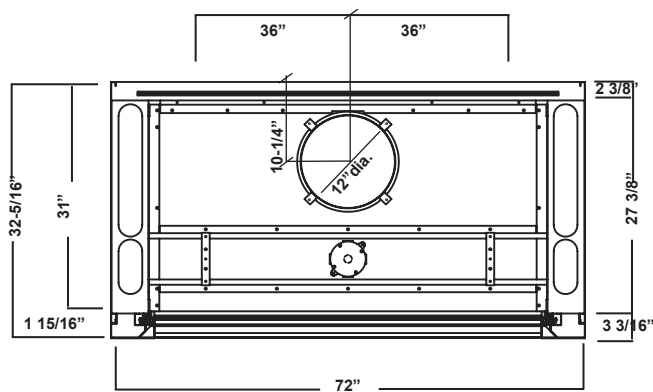

F-503 ISOLATOR GEN-5 Perchloric Acid Bench – Product Dimensions

Each 5" wide fascia pre-punched with two electrical cutouts and five, 3/4" diameter holes for rod driven remote fixtures.
 (Total: 4 electrical cutouts; 10, pre-punched holes, per hood)
 Top right hole is plumbed with wash down control handle; 9 hole plugs provided.
 Counter Top Depth: 29" D.

Outside, Overall Height: 57-1/8"
 Outside, Overall Depth: 32-15/16"

Equipped with 10" or 12" diameter, stainless steel duct collar.

24" Clear Interior Depth

48" Clear Interior Height. Height from bottom of hood to top of duct collar is 51-1/2".

F-503-96G5 - 96" Perchloric Acid BENCH FUME HOOD

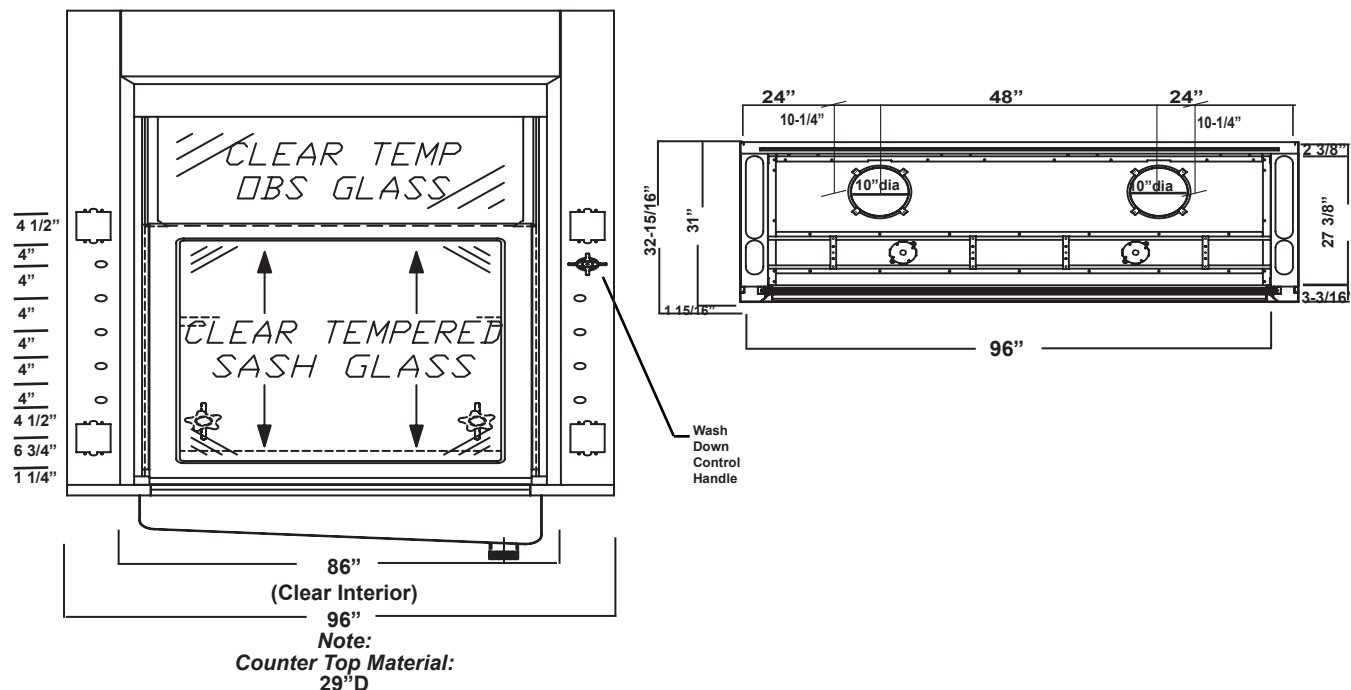

F-503-G5 - BENCH FUME HOOD SIDE VIEWS, OPEN & CLOSED Perchloric Acid

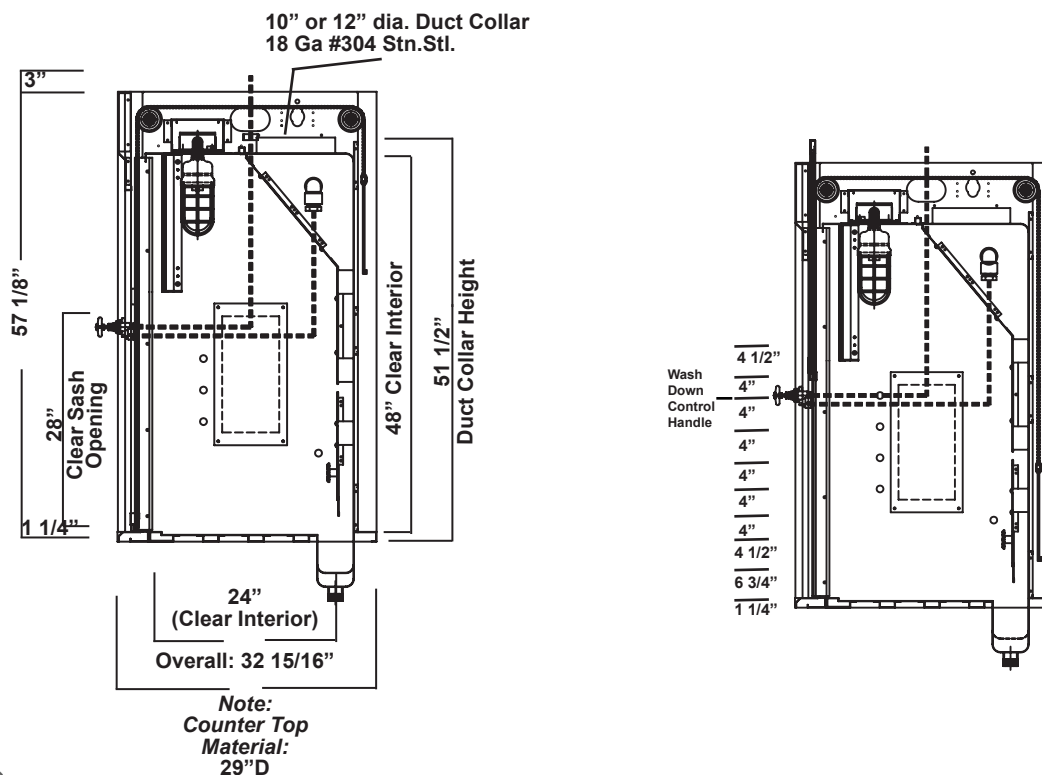

INTENTIONALLY BLANK

