

DIMENSIONS SHOWN ARE FOR EXAMPLE ONLY, SHOWING 3X STACK W/ STAGGERED FIXTURE LOCATIONS.

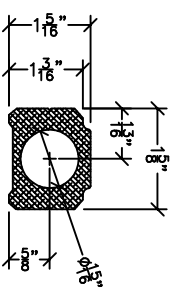
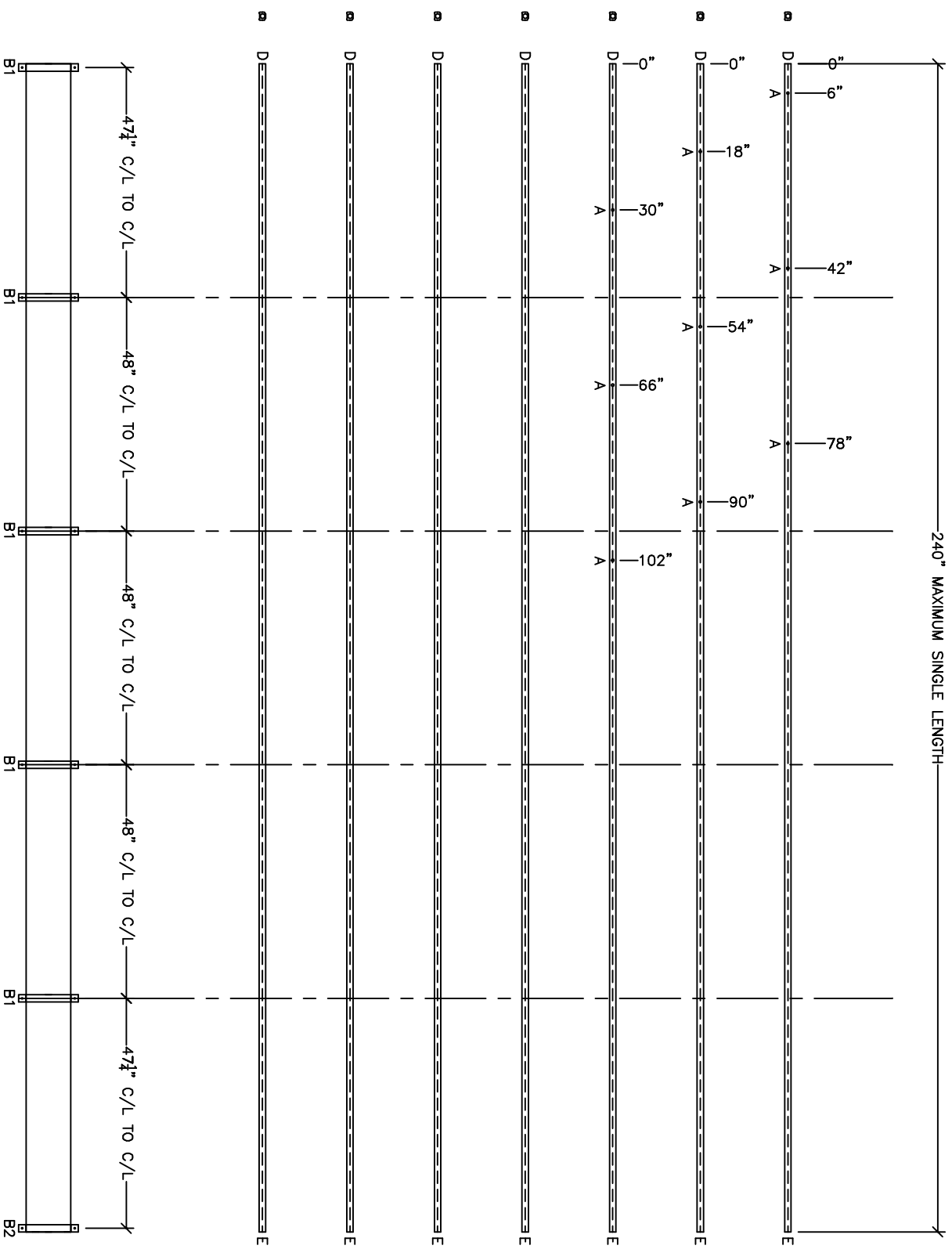

STANDARD FLEX-A-SCOPE MANIFOLD SECTION  
6063-T5 ALUMINUM

HOLE TAPPING SCHEDULE:

- "A" = 1/4" IPS TAPPED HOLE
- "B" = 3/8" IPS TAPPED HOLE
- "C" = 1/2" IPS TAPPED HOLE
- "D" = 3/4" NPT TAPPED END (INLET)
- "E" = 3/4" NPT PLUGGED END
- "F" = 1/2" NPT MALE SPLICE

BRACKET SCHEDULE:

- "B1" = OPEN SUPPORT BRACKET
- "B2" = CLOSED SUPPORT BRACKET
- "B3" = OPEN COMBO FOR ISODUCT
- "B4" = INSIDE CORNER BRACKET
- "B5" = OUTSIDE CORNER BRACKET
- "B6" = FLANGED "U" BRACKET

SUPPORT BRACKET TYPES AND LOCATIONS

SHEET NO.	JOB NO.	CHK'D BY:	DRAWN BY:	DATE	SCALE
		BUS			NONE

**LFS** systems Corp  
 249 OLD CHURCHMAN'S ROAD  
 NEW CASTLE, DE 19720  
 PHONE: 302-322-0460  
 FAX: 302-322-2849

FLEX-A-SCOPE MANIFOLD DRAWING

PROJECT